

NOTES:

- 1) THIS DRAWING IDENTIFIES THE MAJOR COMPONENTS FOR THE MODEL 7000A GYRO.
- 2) GYRO IS SHIPPED WITH ITEM 23, LIFTING EYES (2), INSTALLED IN ENCLOSURE. ITEMS 24 & 25 SHIP LOOSE AND WILL BE INSTALLED IN GYRO AFTER INSTALLATION IN VESSEL IS COMPLETE.

REVISIONS					
REV.	ECN NO.	ZONE	DESCRIPTION	DATE	APPROVED
2			1. DELETED P/N'S 60100, 60101, 60093 & 50058. 2. CHANGED QTY FROM 1 TO 2 FOR P/N'S 60060 & 40068. 3. CHANGED ATTACHMENT POINT ON ENCLOSURE FOR ITEM 34.	14SEPT09	BRD
3	ECN0002	PARTS LIST	1. CORRECTED ERRORS IN PARTS LIST. 2. ADDED BRAKE BUSHING DETAILS VIEW ON SHEET 3.	10FEB2010	WED
4	ECN0021	PARTS LIST	1. CHANGED HEAT EXCHANGER PART NO. FROM 10423 TO 10553. 2. CORRECTED LIFTING POINT HARDWARE VIEW - SHEET 3.	8/27/2010	BHS BRD

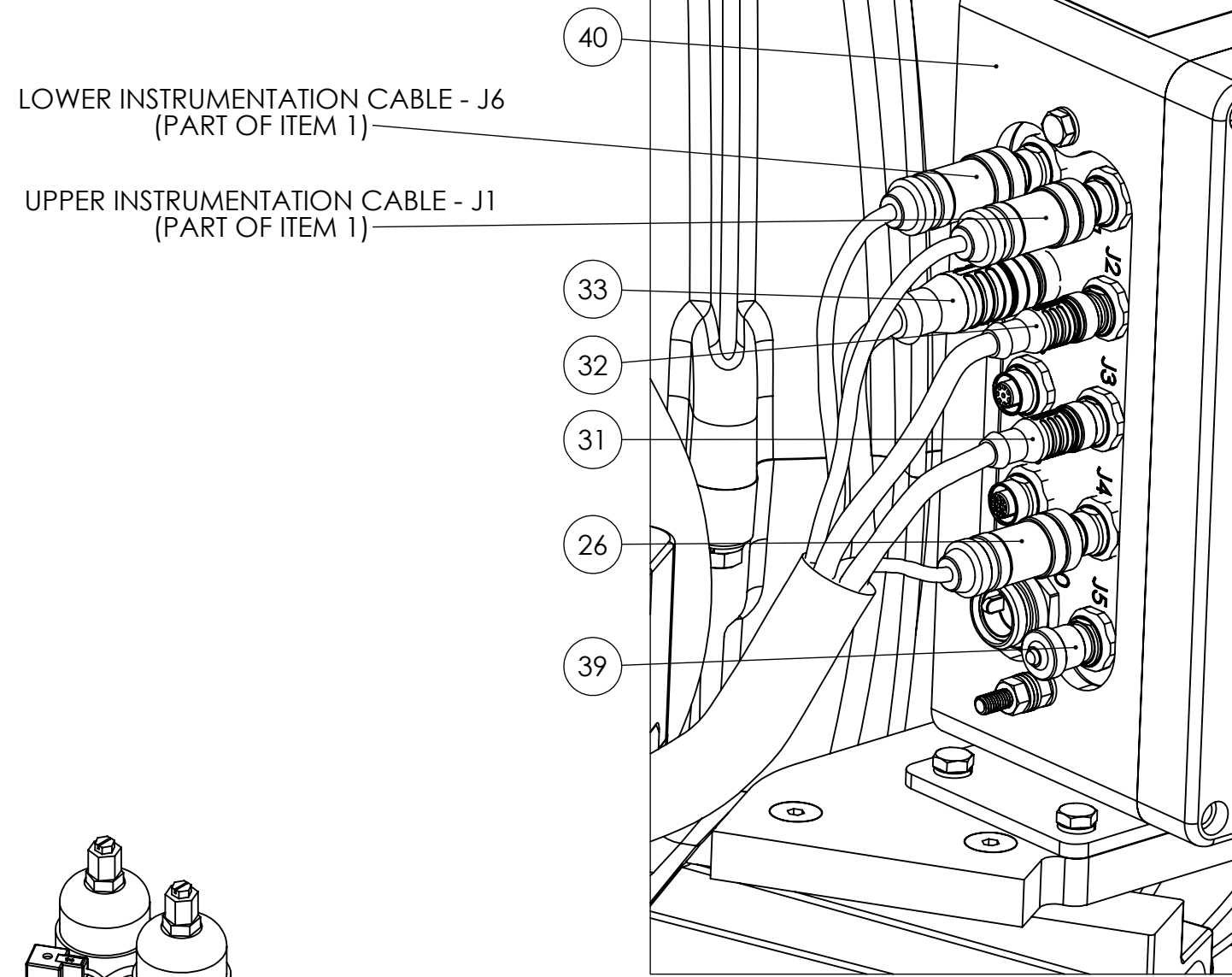

**CABLE CONNECTIONS TO CONTROL BOX**

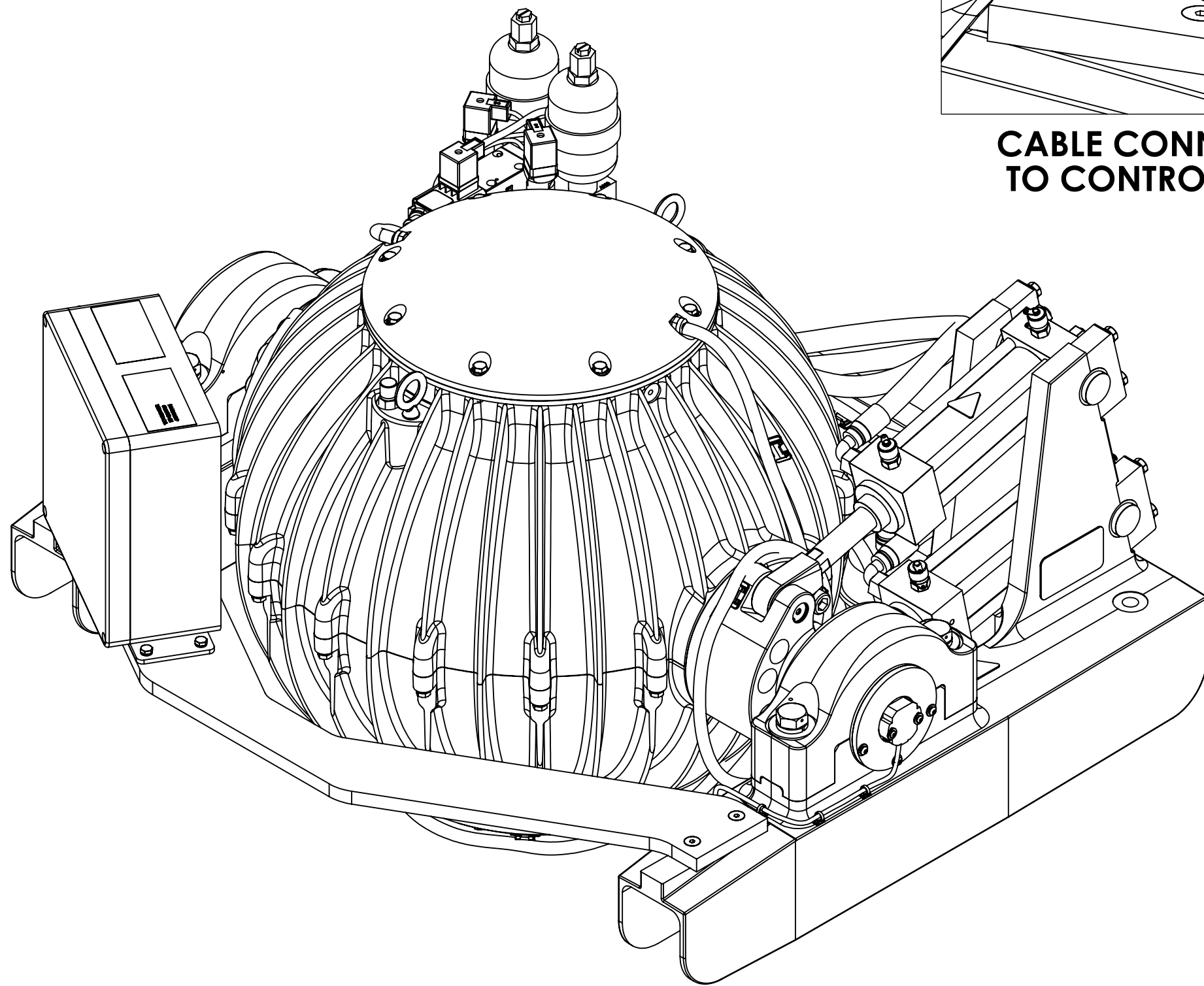

46	10447	BRAKE BUSHING REPLACEMENT KIT		CONTAINS ITEMS 12,13,14,15,17,18
45	60099	FLAT SOCKET HEAD CAP SCREW	4	
44	60098	HEX NUT	4	
43	60097	INTERNAL TOOTH LOCK WASHER	8	
42	60096	SPRING LOCK WASHER	4	
41	60119	HEX HEAD CAP SCREW 1/4"-20 x 5/8" LNG	4	
40	20133	GYRO CONTROL BOX, M7000A / M21000 COMPATIBLE	1	
39	30143	CLOSURE CAP	1	CONNECTS TO J5
38	30104	CONNECTOR, 3-CONTACT FEMALE	1	CONNECTS TO J10
37	30078	CONNECTOR, 4-CONTACT MALE	1	CONNECTS TO J9
36	30076	CONNECTOR, 8-CONTACT MALE	1	CONNECTS TO J8
35	20094	MOTOR DRIVE J-BOX GROUND CABLE ASSY	1	
34	20108	GYRO ENCLOSURE 4 AWG GROUND CABLE ASSY	1	
33	30105	MOTOR DRIVE CONTROL CABLE	1	CONNECTS TO J7
32	30100	1-2 SPLITTER CABLE ASSY	1	CONNECTS TO J2
31	30101	1 TO 4 SPLITTER CABLE ASSY	1	CONNECTS TO J3
30	40004	VACUUM VALVE	1	
29	60008	FLAT WASHER	4	
28	60007	SPRING LOCK WASHER	4	
27	10319	HEX HEAD CAP SCREW	4	
26	20101	GIMBAL ANGLE SENSOR & CABLE ASSY	1	CONNECTS TO J4
25	60060	PAN HEAD MACHINE SCREW	2	SEE NOTE 2
24	40068	SEALING WASHER	2	SEE NOTE 2
23	60013	EYEBOLT	2	
22	50023	HYDRAULIC HOSE ASSEMBLY, PORT #4 TO UPPER CYL. CAP	1	
21	50022	HYDRAULIC HOSE ASSEMBLY, PORT #1 TO LOWER CYL. CAP	1	
20	50021	HYDRAULIC HOSE ASSEMBLY, PORT #2 TO LOWER CYL. HEAD	1	
19	50020	HYDRAULIC HOSE ASSEMBLY, PORT #3 TO UPPER CYL. HEAD	1	
18	40101	RETAINING RING	2	PART OF ITEM 46
17	60121	PIN RETAINING WASHER	2	PART OF ITEM 46
16	10306	BRAKE CRANK PIN	2	
15	10304	BRAKE CRANK BUSHING	4	PART OF ITEM 46
14	10307	ROD-END FLANGED BUSHING	4	PART OF ITEM 46
13	10297	BRAKE CYLINDER ROD-END	2	PART OF ITEM 46
12	10308	FLANGED TRUNNION BUSHING	4	PART OF ITEM 46
11	10473	BRAKE CYLINDER (UPPER)	1	
10	10472	BRAKE CYLINDER (LOWER)	1	
9	10422	PRECESSION BRAKE MANIFOLD ASSEMBLY	1	
8	20102	FRESH WATER CIRCULATION PUMP / CABLE ASSEMBLY	1	
7	10419	FRESH WATER COOLING CIRCUIT SERVICE PORT SUB-ASSEMBLY	1	
6	10553	M7000, M7000A HEAT EXCHANGER SUB-ASSEMBLY	1	
5	10334	FOUNDATION FORWARD BRACE	1	
4	10343	FOUNDATION AFT BRACE	1	
3	10268	FOUNDATION SADDLE ASSEMBLY	1	
2	10266	BRAKE FOUNDATION SADDLE ASSEMBLY		
1	10451	ENCLOSURE - GIMBAL SHAFT SUB-ASSEMBLY	1	
ITEM NO.	PART NUMBER	DESCRIPTION	QTY	NOTE

UNLESS OTHERWISE SPECIFIED:

DIMENSIONS ARE IN INCHES  
TOLERANCES:  
FRACTIONAL ±  
ANGULAR: MACH ± BEND ±  
TWO PLACE DECIMAL ±0.01  
THREE PLACE DECIMAL ±.005

THIRD ANGLE PROJECTION

PROPRIETARY AND CONFIDENTIAL  
THE INFORMATION CONTAINED IN THIS DRAWING IS THE SOLE PROPERTY OF SEAKEEPER, INC. ANY REPRODUCTION IN PART OR AS A WHOLE WITHOUT THE WRITTEN PERMISSION OF SEAKEEPER, INC. IS PROHIBITED.

INTERPRET GEOMETRIC TOLERANCING PER:  
MATERIAL -  
FINISH -  
DO NOT SCALE DRAWING

NAME	BRD	DATE	22MAY09
CHECKED	WED	DATE	18SEPT09
ENG APPR.	JDA	DATE	18SEPT09

COMMENTS:

**Seakeeper** P.O. BOX 999  
SOLOMONS, MARYLAND 20688, USA  
PHONE: (410) 326-1590 FAX: (410) 326-1199

TITLE: **MODEL 7000A GYRO ASSEMBLY & PARTS LIST**

SIZE **C** DWG. NO. **90032** REV **4**

SCALE: 1:10 WEIGHT: SHEET 1 OF 3

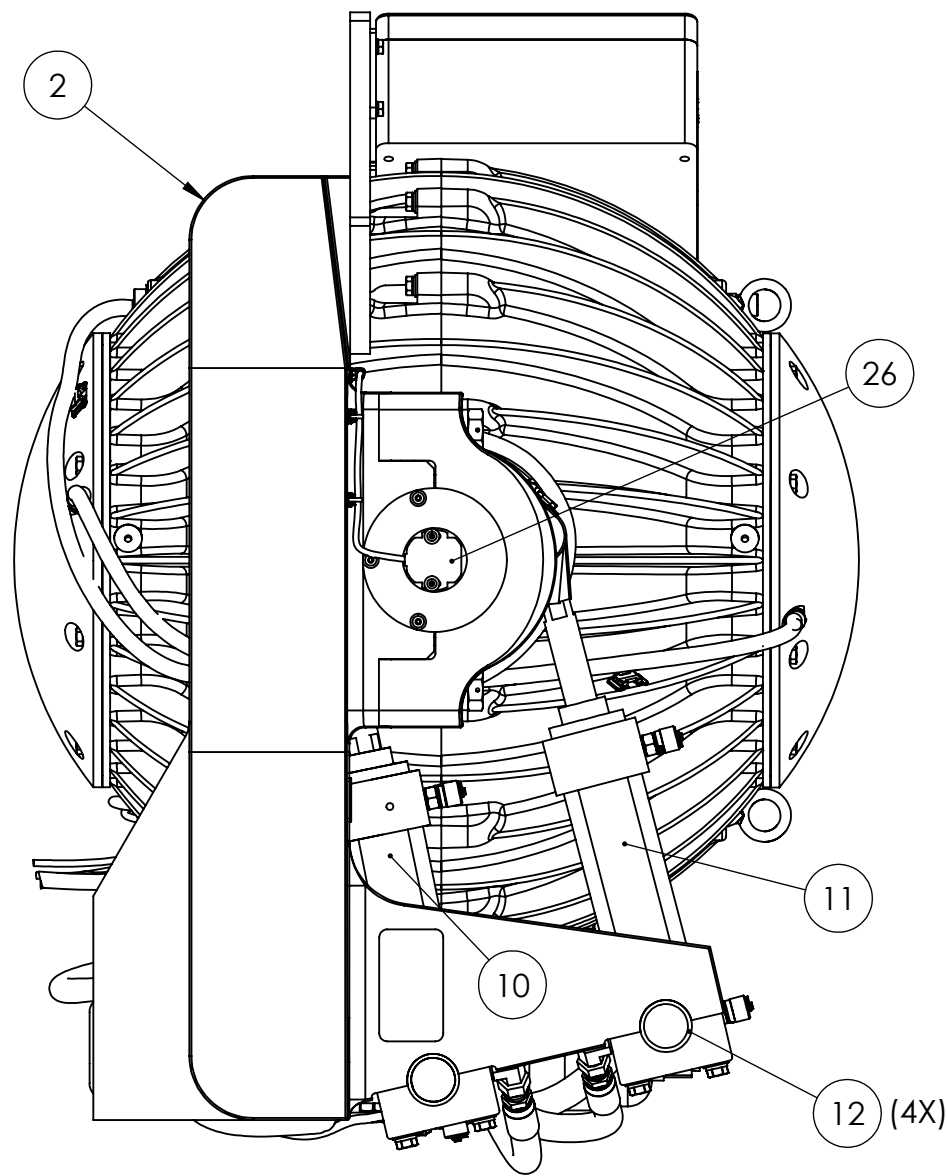

**PORT SIDE VIEW**

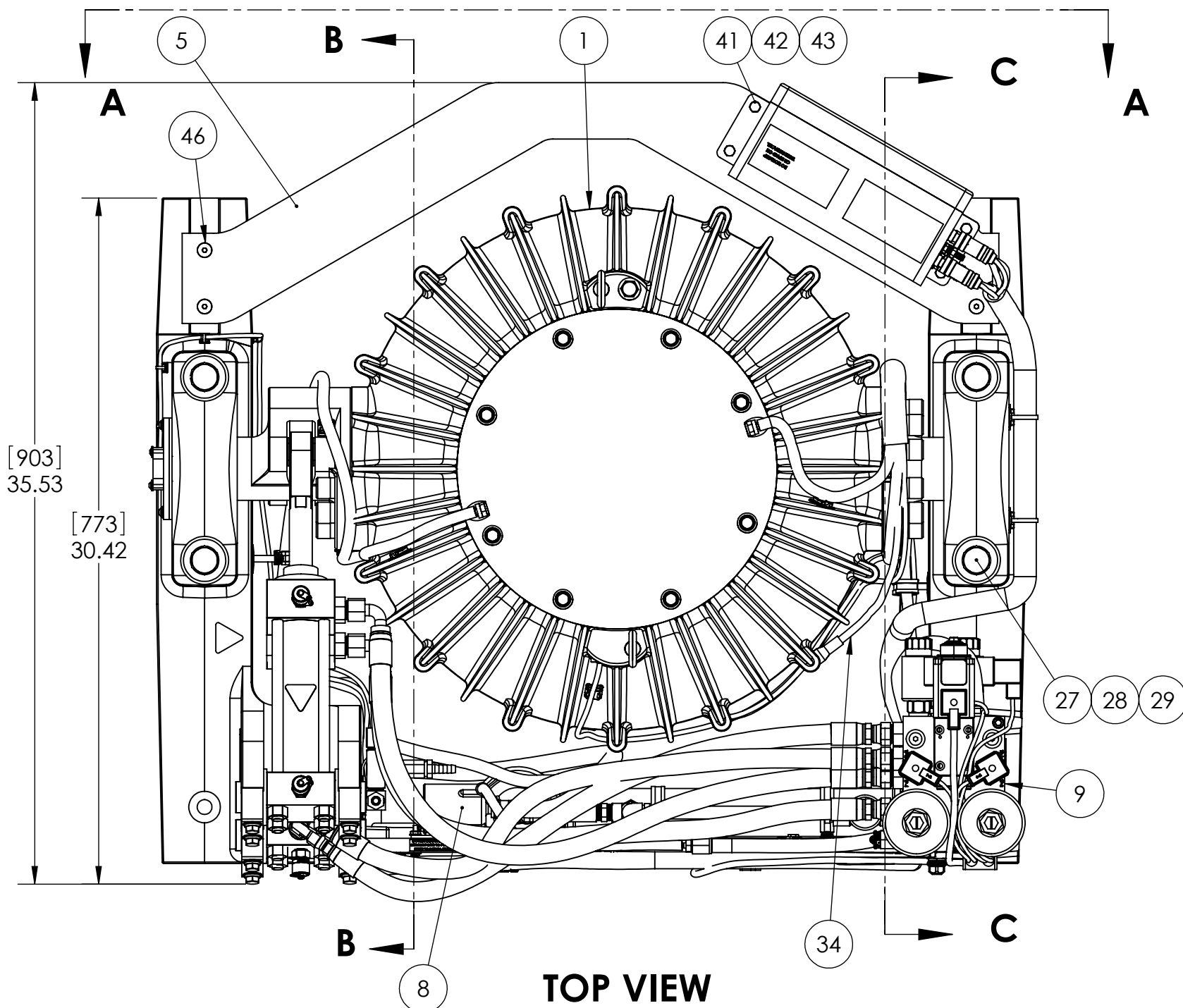

**TOP VIEW**

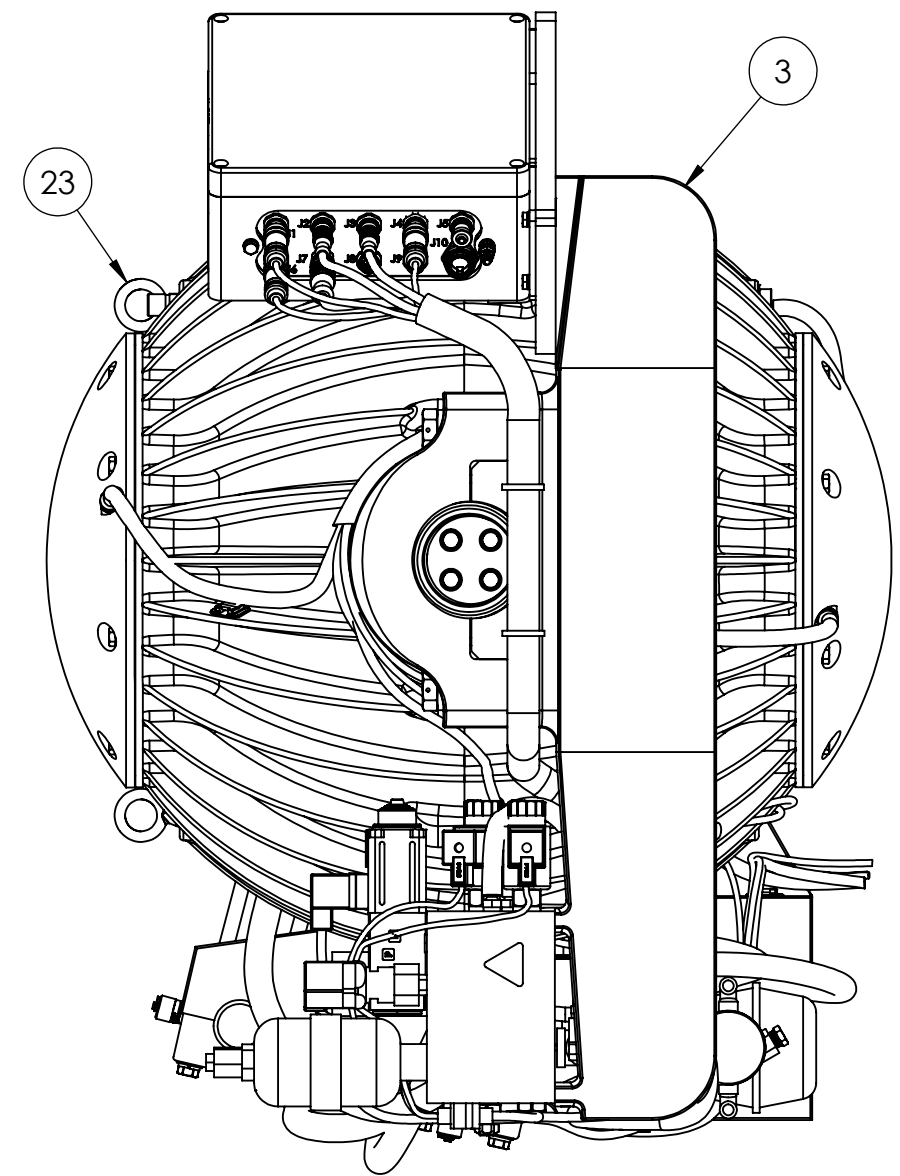

**STARBOARD SIDE VIEW**

13 14 15 16 17 18  
SEE SHEET 3 FOR DETAILS

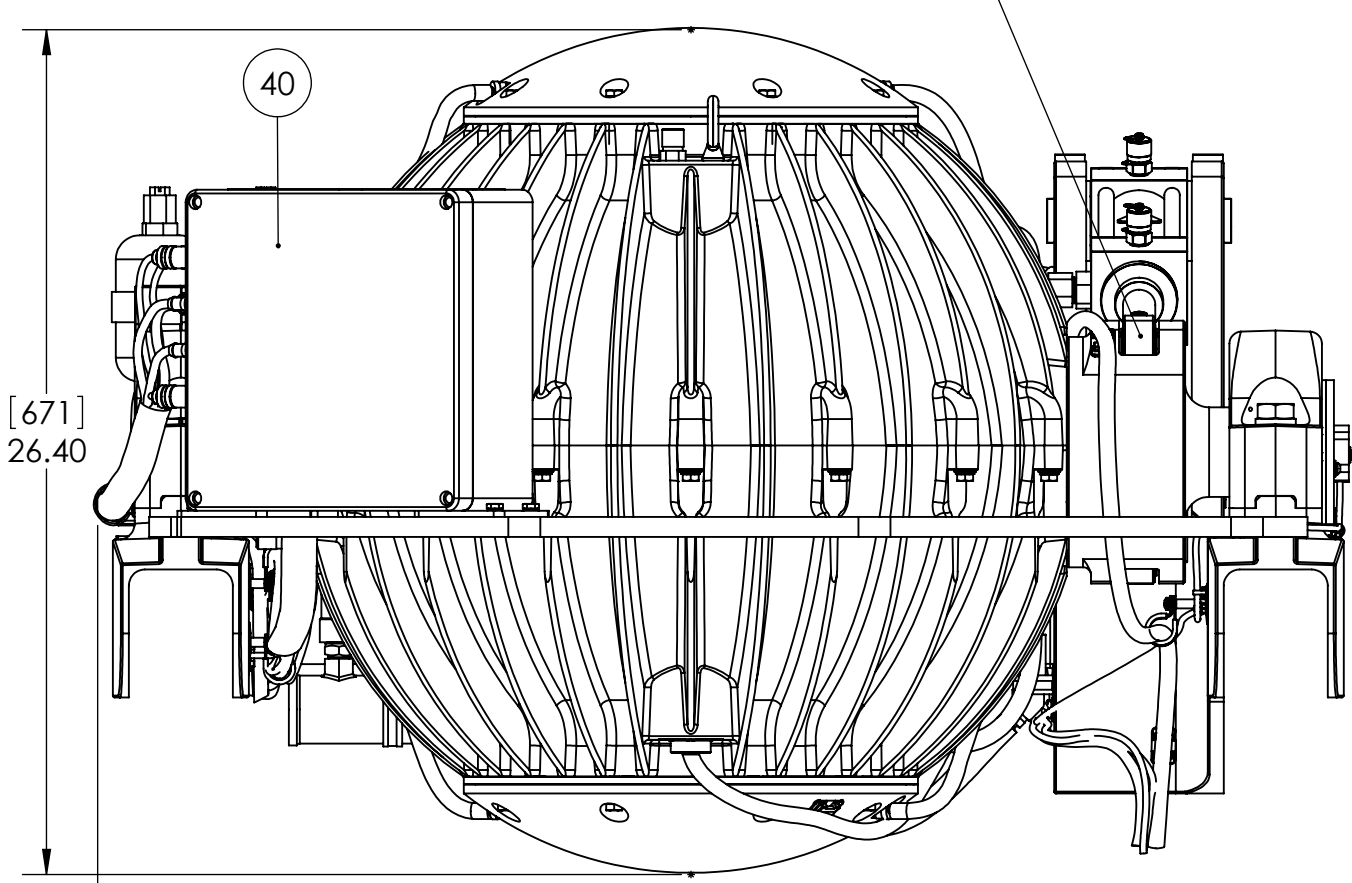

**FRONT VIEW**

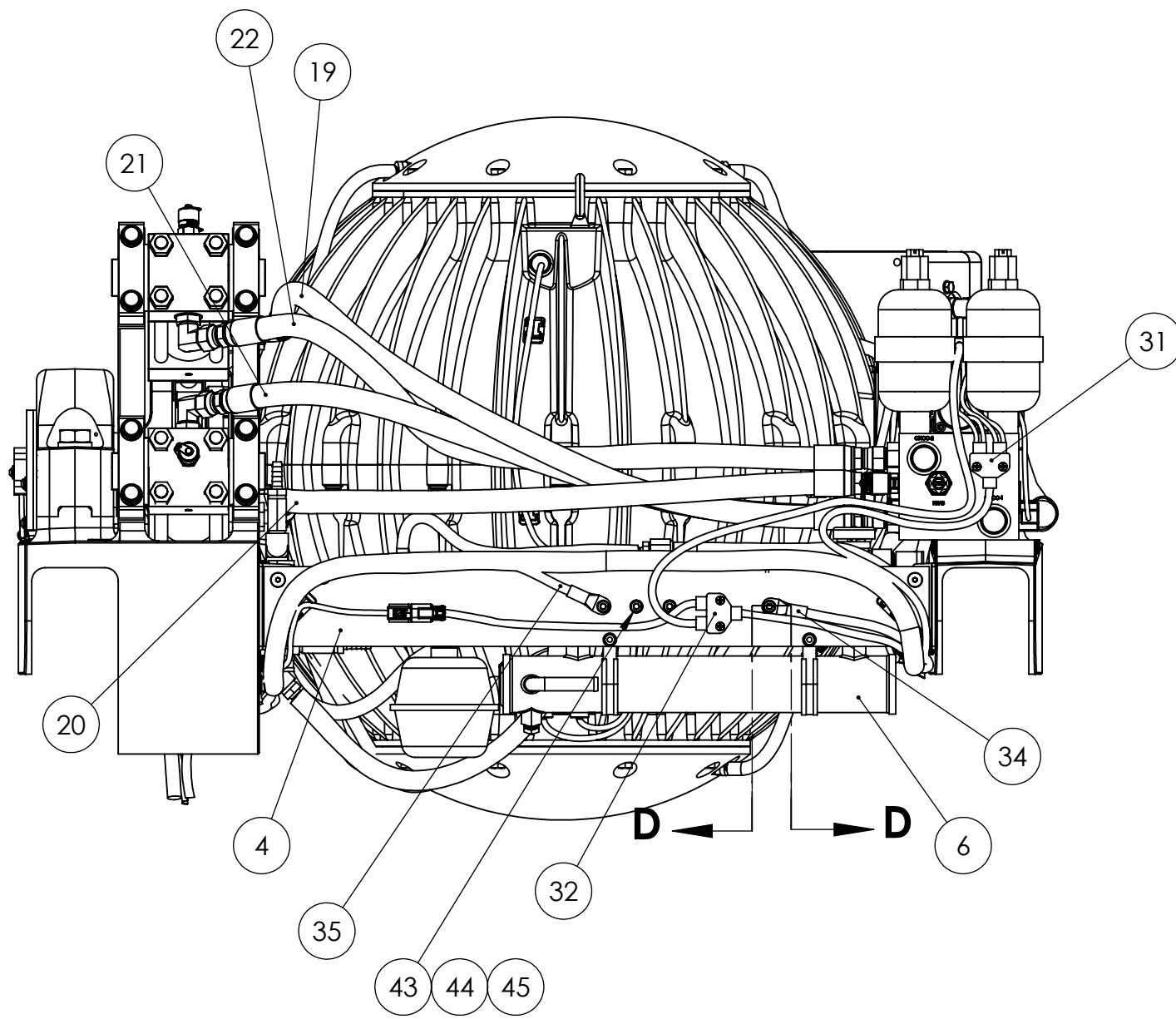

**AFT VIEW**

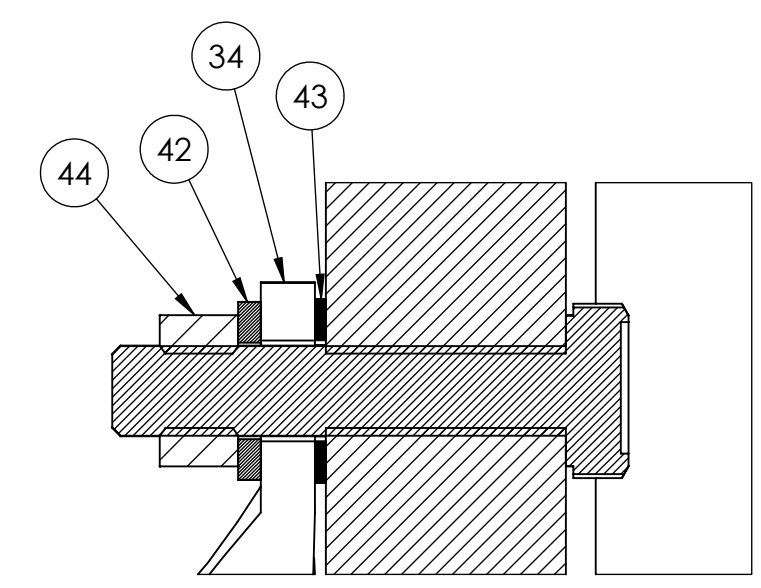

**SECTION D-D  
GROUND STUDS DETAIL**

SIZE <b>C</b>	DWG. NO. 90032	REV 4
SCALE: 1:10	WEIGHT:	SHEET 2

8

7

6

5

4

3

2

1

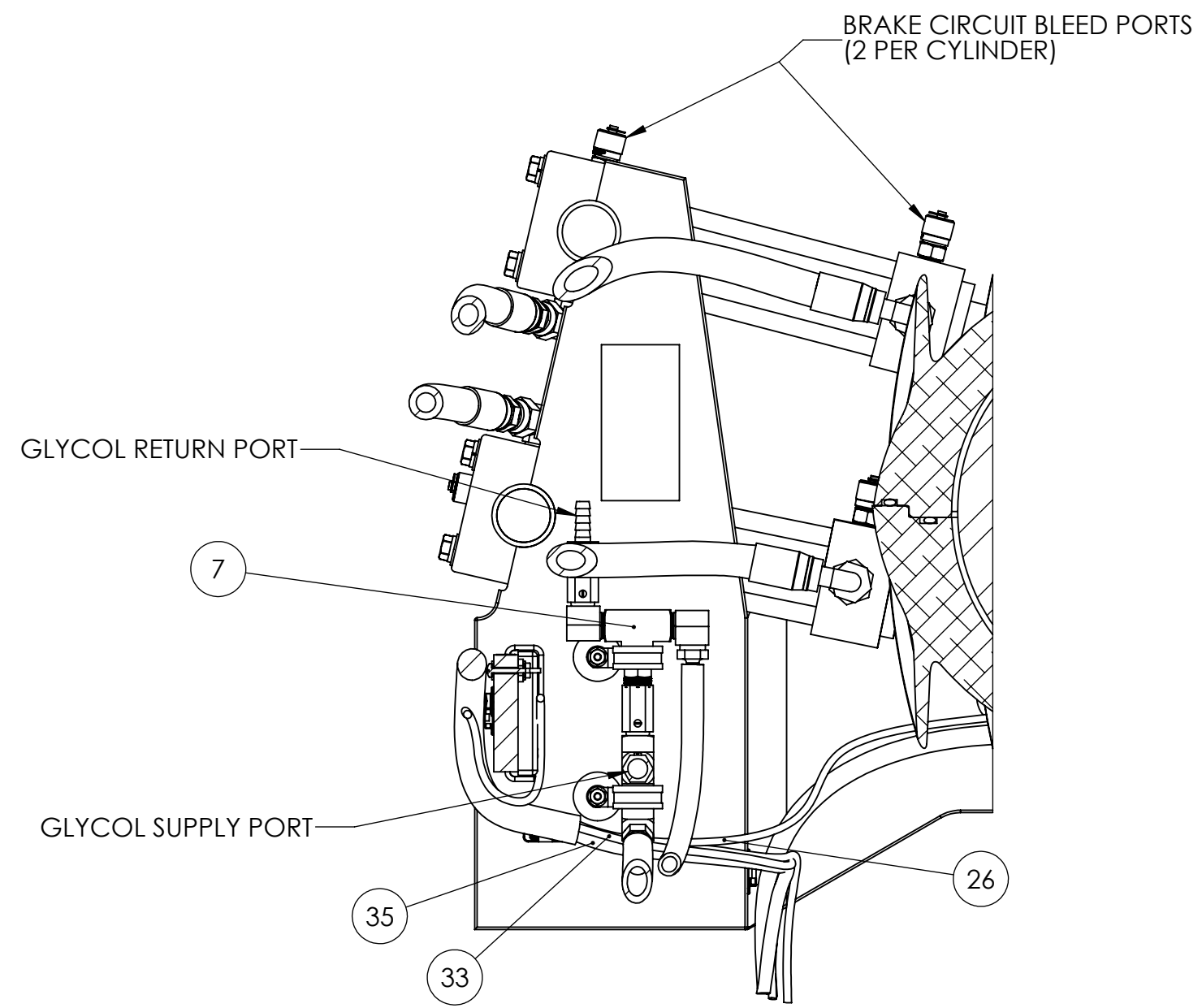

**SECTION B-B  
VIEW OF INBOARD FACE OF BRAKE SADDLE  
ENCLOSURE-GIMBAL SHAFT SUB-ASSEMBLY NOT SHOWN**

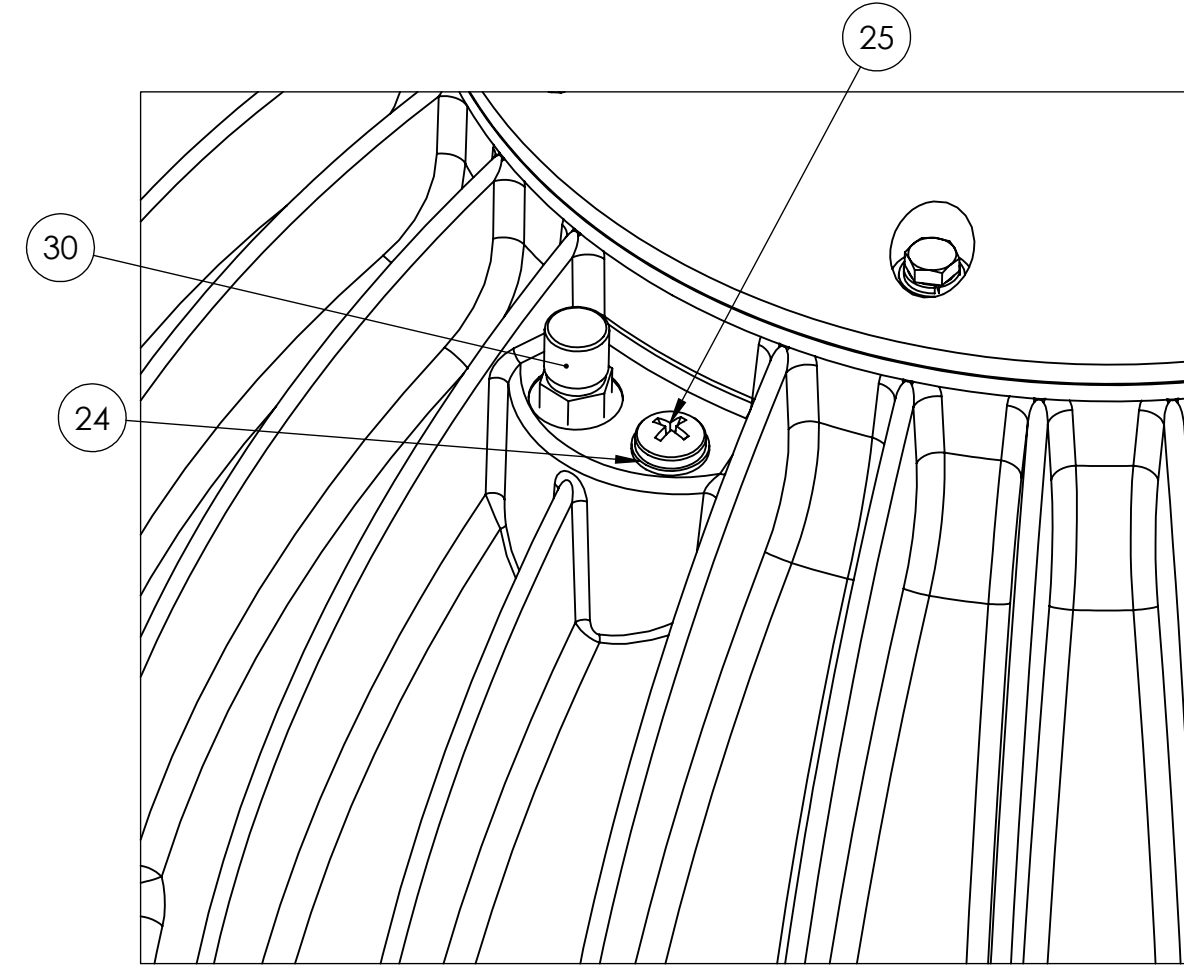

**LIFTING POINT HARDWARE (2 PLACES)  
(ITEMS 24 & 25 SHIP LOOSE WITH GYRO ASSEMBLY)**

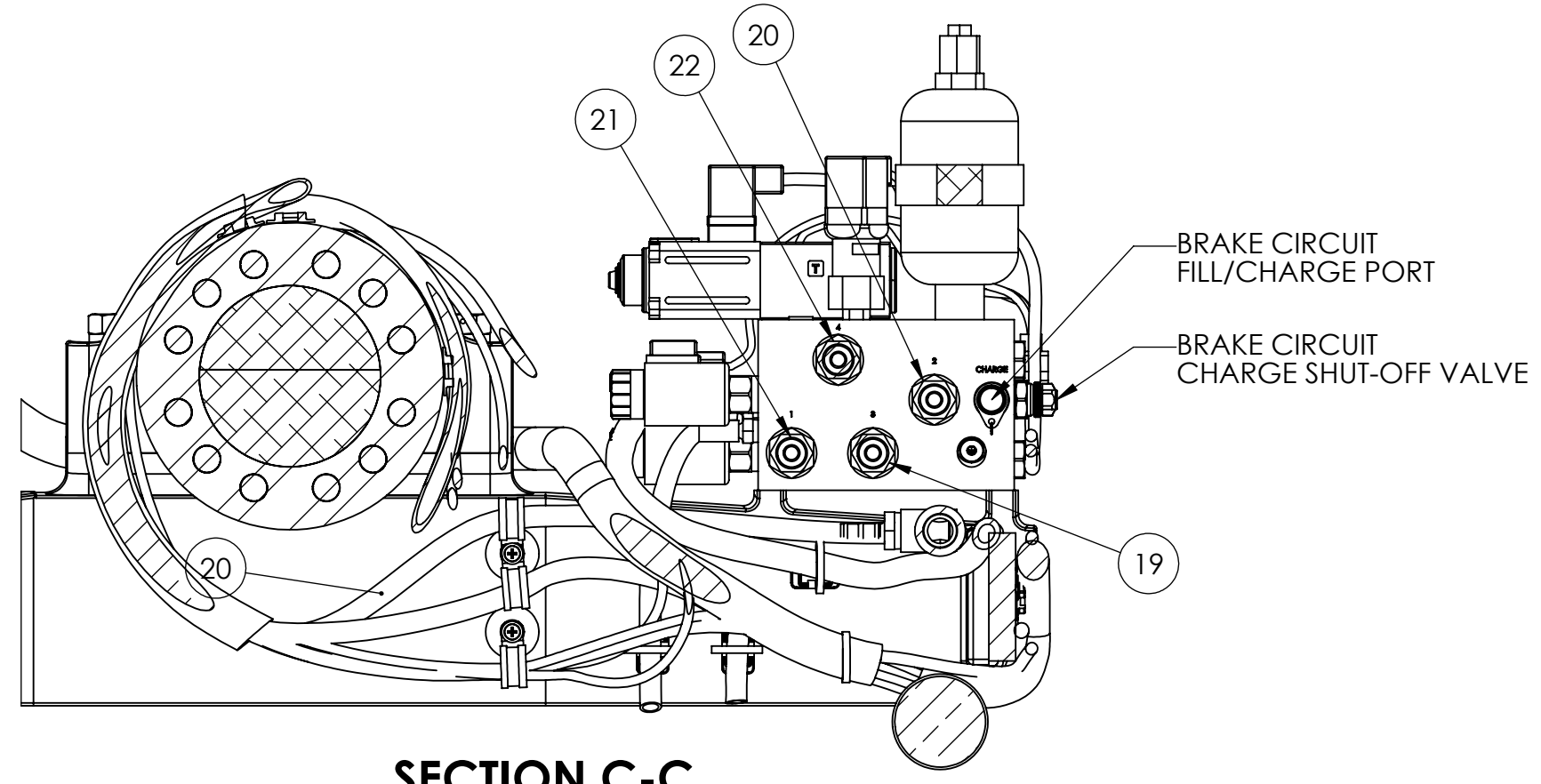

**SECTION C-C  
VIEW OF INBOARD FACE OF SADDLE**

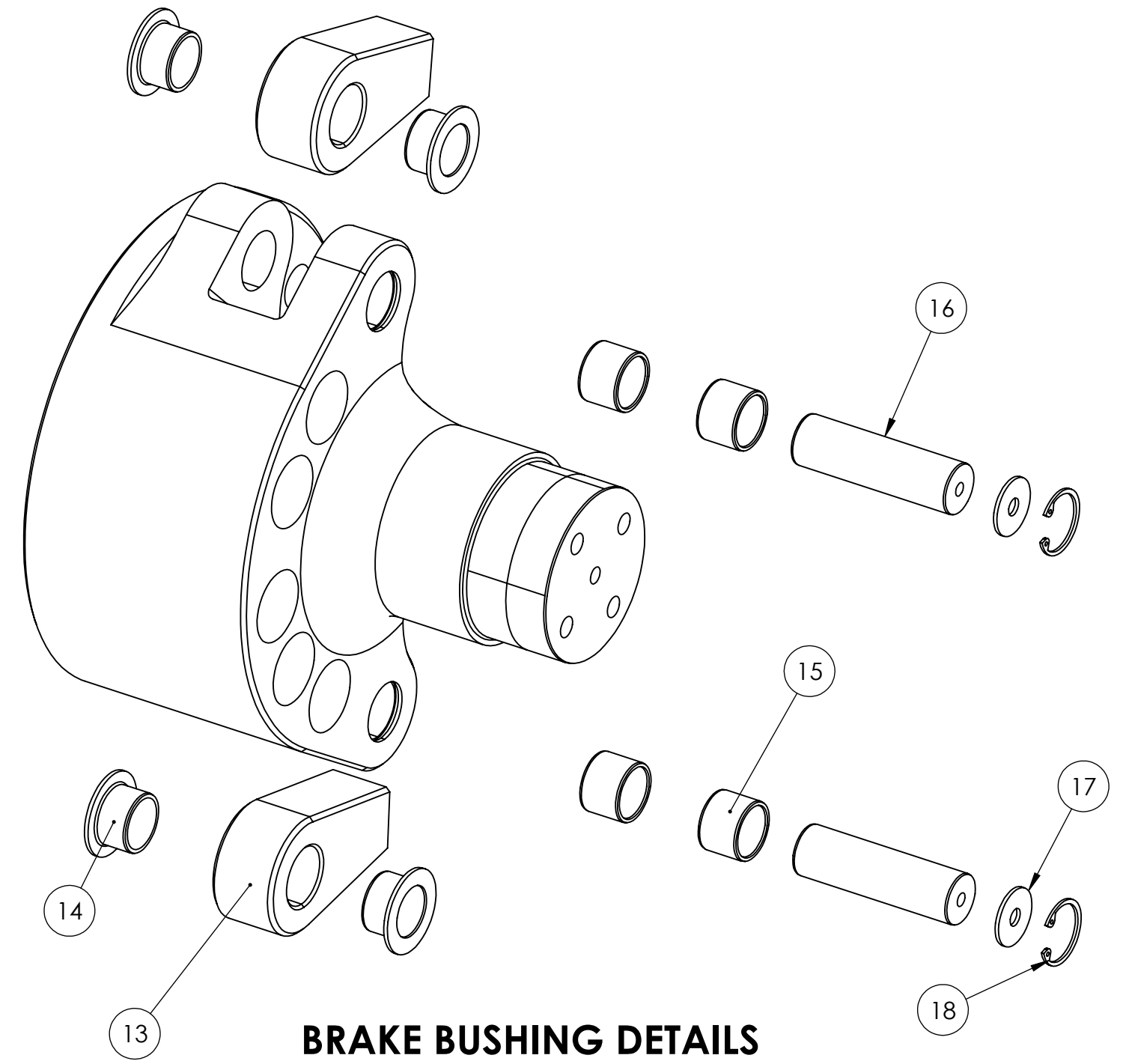

**BRAKE BUSHING DETAILS**

SIZE <b>C</b>	DWG. NO. 90032	REV 4
SCALE: 1:10	WEIGHT:	SHEET 3

8

7

6

5

4

3

2

1