

NOTES:

- 1) GYRO STABILIZER INSTALLER IS TO CAREFULLY REVIEW AND UNDERSTAND THE INSTALLATION MANUAL AND INSTALLATION DRAWING FOR THE GYRO MODEL BEING INSTALLED PRIOR TO SETTING TO WORK.
- 2) SADDLE INSTALLATION FIXTURE KIT, P/N 90088, IS REQUIRED FOR BONDING PROCESS TO ACHIEVE PROPER SADDLE ALIGNMENT AND SPACING.

REV NO.	ECN NO.	ZONE	DESCRIPTION	DATE	APPRVD.
8	298		INJECTION KIT ADDED	3/13 /2015	BRD

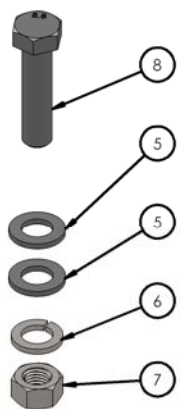
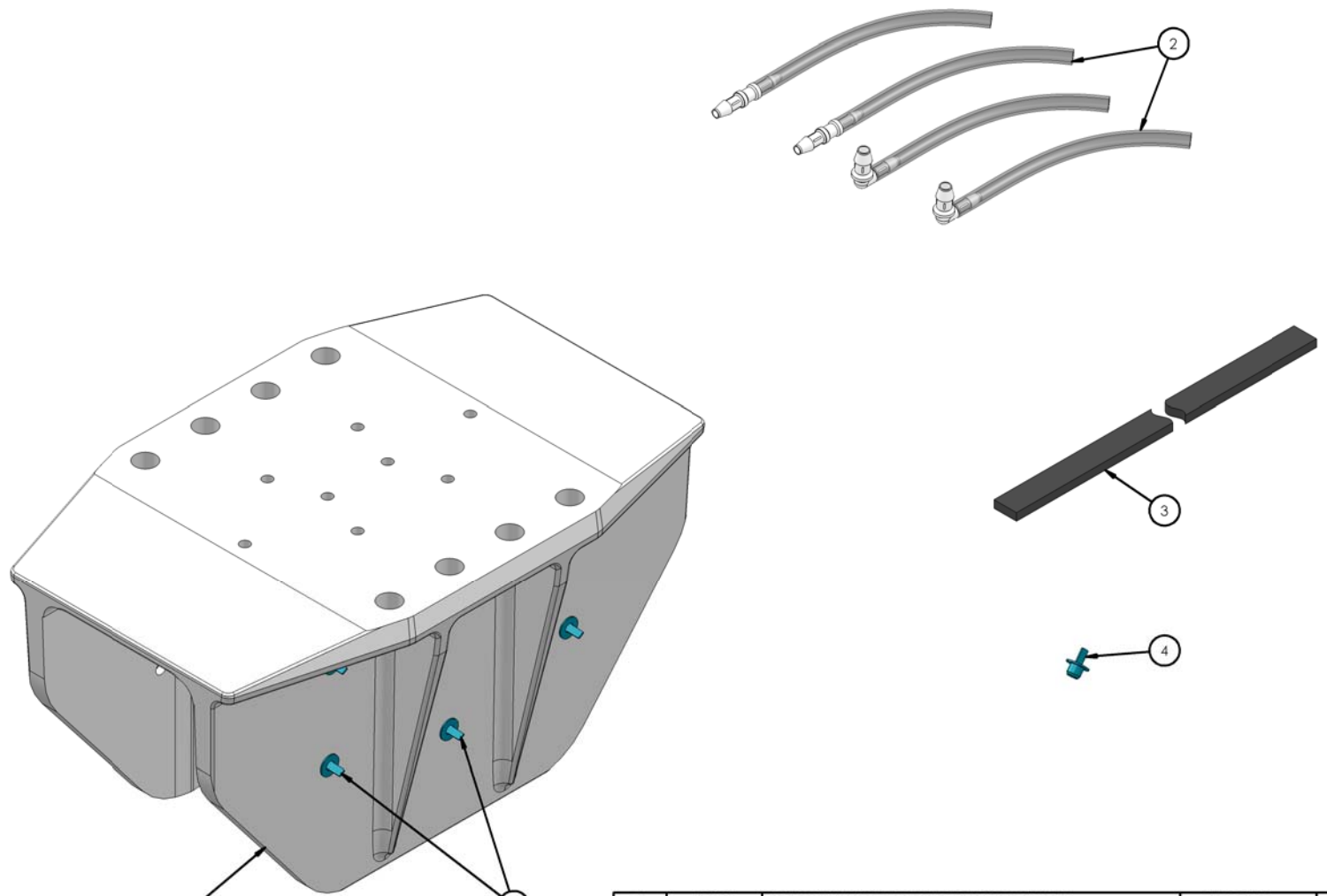

8X LOCATIONS PER SADDLE

ITEM NO.	PART NO.	DESCRIPTION	MATERIAL	QTY.
8	60181	SCREW, HEX HD CAP M16-2.0 X 65MM FULL TD	ZINC PLTD 8.8	33
7	60180	NUT, FULL HEX, M16-2.0	ZINC PLTD 8.8	33
6	60173	WASHER, SPLIT LOC, M16	ZINC PLTD	33
5	60170	WASHER, FLAT, M16 X 30MM-OD	ZINC PLTD	66
4	40264	PLUG, ADHESIVE INJECTION HOLE, BLUE	RUBBER	50
3	40234	FOAM, ADHESIVE BACKED, .25 THK X .75 WIDE, 17 FT LENGTH	POLYURETHANE	1
2	11281	ADHESIVE INJECTION NOZZLE FITTING AND TUBE KIT		2
1	10503	SEAKEEPER 26 FINISH MACHINED SADDLE	A356-T6 ALUM	4

<p><b>PROPRIETARY AND CONFIDENTIAL</b></p> <p>THE INFORMATION CONTAINED IN THIS DRAWING IS THE SOLE PROPERTY OF SEAKEEPER INCORPORATED. ANY REPRODUCTION IN PART OR AS A WHOLE WITHOUT THE WRITTEN PERMISSION OF SEAKEEPER IS PROHIBITED.</p>		<p><b>SEAKEEPER</b> Seakeeper Inc. 44425 Pecan Court, Suite 151 California, MD 20619</p>	
<p>WEIGHT - LBS: ---</p> <p>MATERIAL: ---</p>		<p>BOND-IN SADDLE KIT</p>	
<p>DRAWN: PRA DATE: 11 MAR 2015</p> <p>ENG APPR: BRD DATE: 11 MAR 2015</p> <p>PROJ APPR: DATE:</p>		<p>DWG NUMBER: <b>90085</b></p> <p>REV NO / SHEET NO: <b>8 / 1 OF 1</b></p>	