

NOTES:

- 1) ITEM 1, P/N 10534 IS COMPLETELY SYMMETRICAL AND CAN BE USED IN ANY OF THE FOUR LOCATIONS. THIS PART IS A HARD GASKET THAT IS TO BE INSTALLED BETWEEN THE GYROS' 4 FOUNDATION MOUNTS AND THE SHIP'S STRUCTURE TO MINIMIZE POTENTIAL CORROSION.
- 2) ITEM 5, P/N 60181, HEX HD CAP SCREW IS PROVIDED AT 65MM LENGTH, 38MM MINIMUM THREAD LENGTH. BUILDER / INSTALLER IS RESPONSIBLE FOR SUPPLYING ALTERNATE LENGTHS WITH EQUIVALENT OR SUPERIOR MATERIALS IF NEEDED FOR DESIGNED MOUNTING DETAILS OF THE GYRO'S FOUNDATION IN THE HULL STRUCTURE.

REVISIONS					
REV.	ECN NO.	ZONE	DESCRIPTION	DATE	APPROVED
1			INITIAL RELEASE	26APR10	
2		A-4	1. ADDED APPLICABILITY TABLE TO BOTTOM, CENTER OF DRAWING. 2. REMOVED WORDING "M21000" FROM DRAWING TITLE.	17MAY11	BHS BRD
3	ECN0096		1. UPDATED APPLICABILITY TABLE TO INCLUDE M26000.	05JUN12	BHS BRD
4			1. REMOVED APPLICABILITY TABLE. 2. CHANGED TITLE OF DRAWING.	01AUG14	BRD

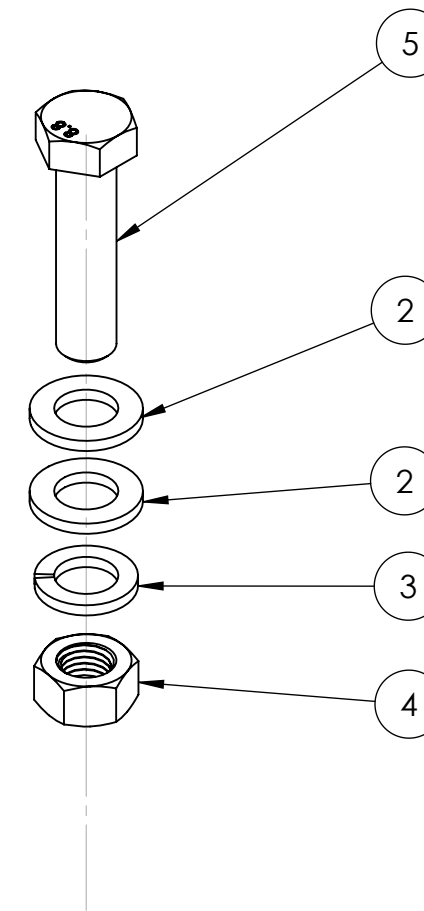
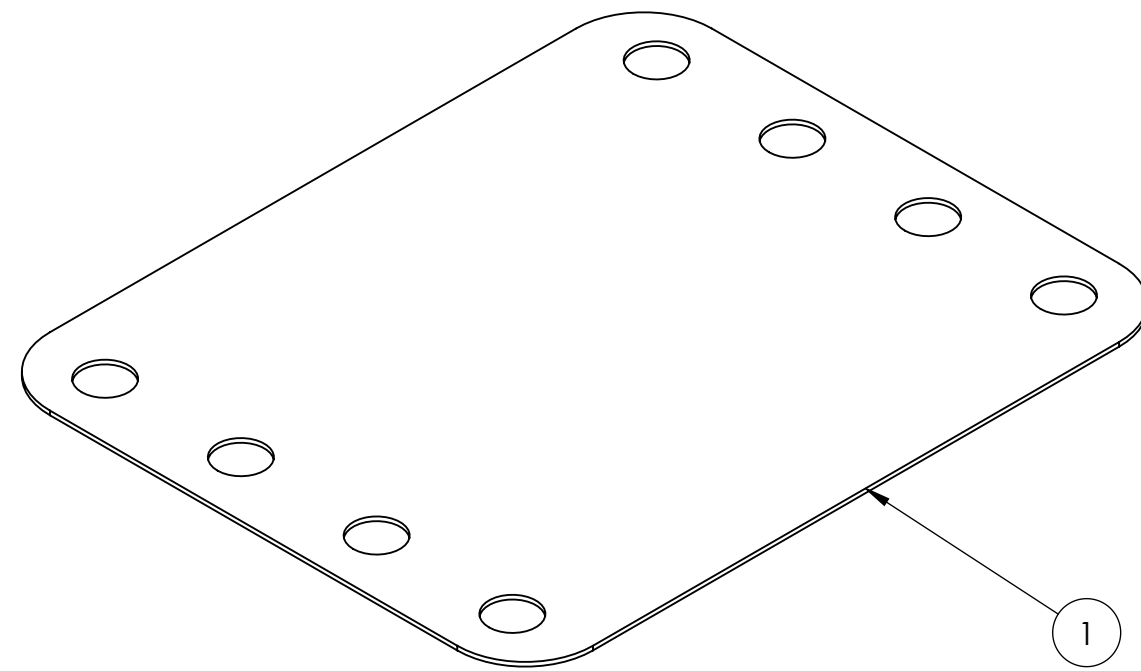

**SEE NOTE 2
IMPORTANT!**

5	60181	SCREW, HEX HD CAP M16-2.0 X 65MM FULL TD	33	ZINC PLTD 8.8	
4	60180	NUT, FULL HEX DIN 934 M16-2.0	33	ZINC PLTD 8.8	
3	60173	WASHER, SPLIT LOC DIN127B M16	33	ZINC PLTD 8.8	
2	60170	WASHER, FLAT DIN125 M16 X 30MM-OD	66	ZINC PLTD 8.8	
1	10534	SEAKEEPER 26-35, ISOLATION GASKET	4	-	
ITEM NO.	PART NO.	DESCRIPTION	QTY	MATERIAL	NOTE

PROPRIETARY AND CONFIDENTIAL
 THE INFORMATION CONTAINED IN THIS DRAWING IS THE SOLE PROPERTY OF SEAKEEPER INCORPORATED. ANY REPRODUCTION IN PART OR AS A WHOLE WITHOUT THE WRITTEN PERMISSION OF SEAKEEPER IS PROHIBITED.

SEAKEEPER
 Seakeeper Inc. 44425 Pecan Court, Suite 151 California, MD 20619

NAME: **BOLT-IN INSTALLATION KIT**

WEIGHT - LBS: ---
 MATERIAL: -

DRAWN: BHS DATE: 26APR2010
 ENG APPR: BRD DATE: 26APR10
 PROD APPR: DATE:

DWG NUMBER: **90086** REV. NO. SHEET NO.: **4** 1 OF 1