

NOTE:

- 1) THIS GROUP OF COMPONENTS IS OFFERED AS AN OPTIONAL MEANS OF INSTALLING THE SK6 GYRO USING BONDING ADHESIVE INSTEAD OF A DIRECT BOLT-IN METHOD. SEE BOND-IN INSTALLATION GUIDELINE DWG. # 90399 FOR BOLT TORQUE SPECIFICATIONS AND OTHER IMPORTANT INFORMATION.
- 2) HARDWARE IS INCLUDED: M12-1.75 X 65mm LG. CLASS 8.8 HEX HEAD CAP SCREWS, SPLIT LOCK WASHERS AND FLAT WASHERS. SEAKEEPER RECOMMENDS USING LOC-TITE 243 BLUE THREAD SEALANT DURING ASSEMBLY. TORQUE TO 65 FT-LBS. (88 Nm)

REV NO.	ECN NO.	ZONE	DESCRIPTION	DATE	APPRVD.
2	-		REPLACED 60428 WITH 60482. DECAL SHEET QTY 4, WAS 1	2/28/2019	BRD
3	765		SK5 RELAUNCH	6/28/2019	AVM

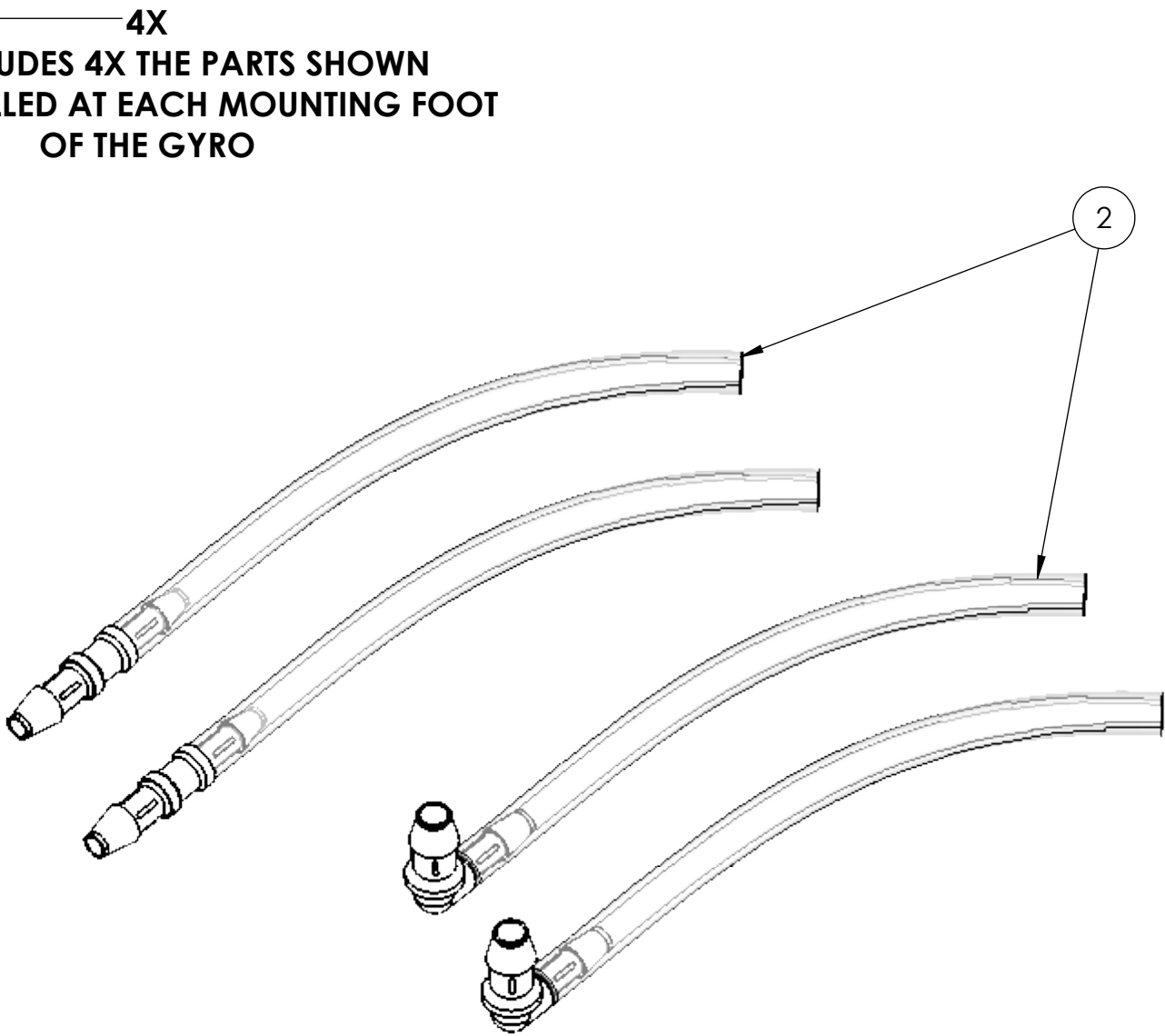
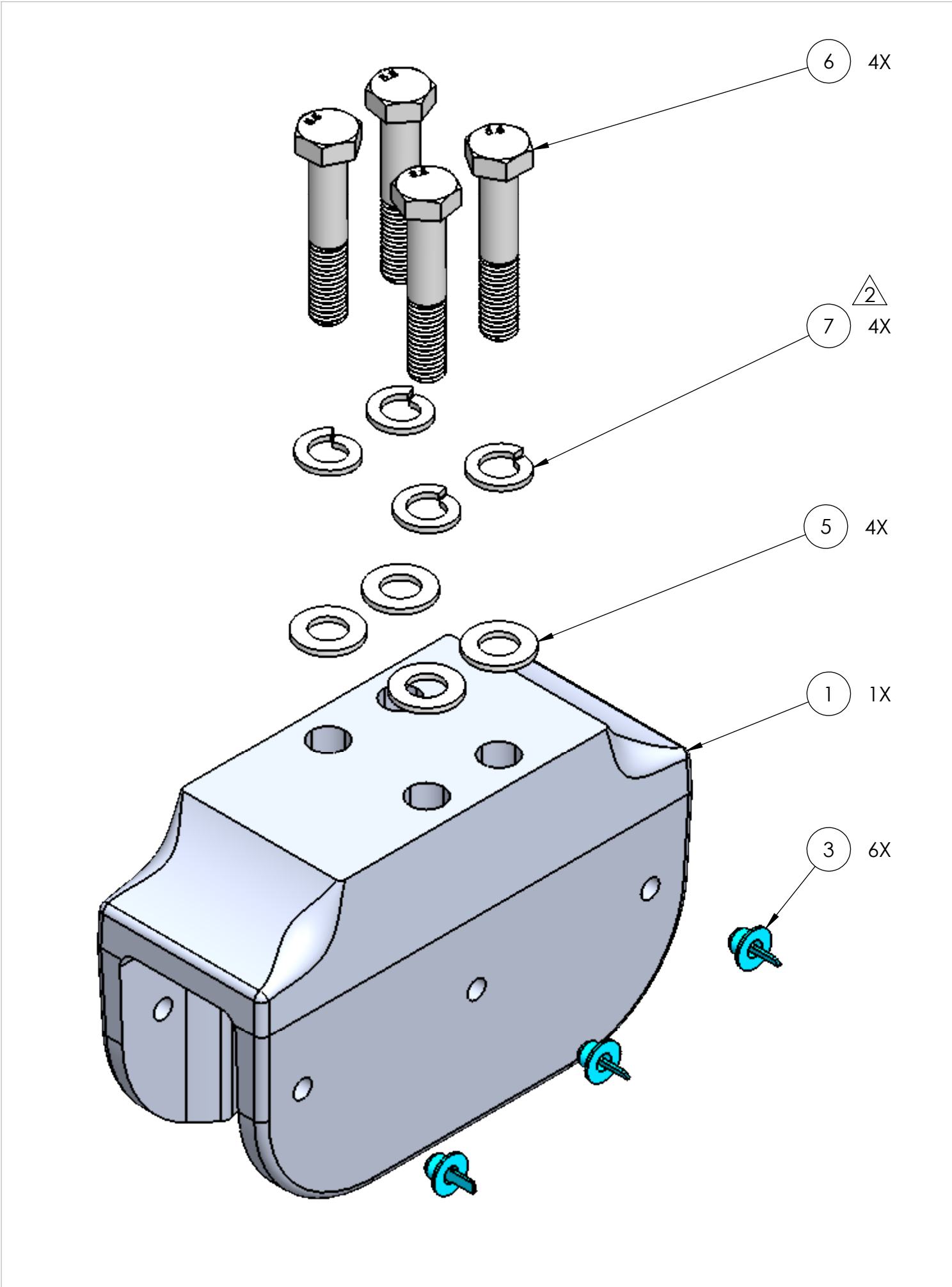

7	60482	WASHER, SPLIT LOC, M12, DIN127B	16
6	60350	SCREW, HX HD CAP, M12X1.75, 65mm LG, GRADE 8.8	16
5	60252	WASHER, FLAT M12 DIN125 8.8	16
4	40370	SK9 SADDLE DECAL SHEET	4
3	40264	PLUG, ADHESIVE INJECTION HOLE, BLUE	24
2	11281	ADHESIVE INJECTION NOZZLE FITTING AND TUBE KIT	2
1	10978	SK5 FINISH MACHINED SADDLE	4
ITEM NO.	PART NUMBER	DESCRIPTION	QTY.

WEIGHT - LBS : ---	DRAWN: WHK ENG APPR: PROD APPR: DATE: 12JUL2016 DATE: DATE:	SEAKEEPER Seakeeper Inc. 44425 Pecan Court, Suite 151 California, MD 20619 NAME: SEAKEEPER 6/5 BOND-IN KIT DWG NUMBER 90401 REV. NO. 3 SHEET NO. 1 OF 1