

## SEAKEEPER 2 UNPACKING INSTRUCTIONS



PRODUCT SEAKEEPER 2

### DESCRIPTION

Instructions for the unpacking of the Seakeeper 2 shipping crate.

### PROCEDURE

1. **INSPECT** crate **AND NOTE** any damage per [TB-90740 – Seakeeper Crate Receipt Inspection](#).
2. With clip removal tool (attached to crate exterior shown in image), **REMOVE** metal clips at top of crate. [See instructions on ATTACHMENT for details]

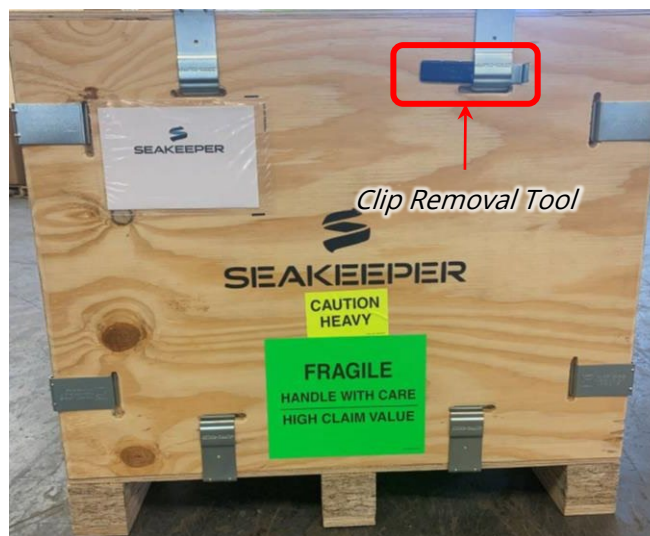

3. **CAREFULLY REMOVE** lid.
4. **REMOVE** four sides of crate.
5. **MAINTAIN** Seakeeper bolted to pallet until ready to install.
6. **REMOVE** top cover of Seakeeper to access lifting eyes of enclosure:
  - a. **RELEASE** push pins with plastic tool to not scratch painted surfaces.



Image of push pin inserted

## SEAKEEPER 2 UNPACKING INSTRUCTIONS



PRODUCT      SEAKEEPER 2

**CAUTION:**

**DAMAGE TO HOSES OR CABLES MAY OCCUR FROM LAG SCREW REMOVAL.**

7. When ready to install, **REMOVE** 3/8-16 hex head cap (HHC) screws at each corner of frame with 9/16-in. socket/wrench. [Screws circled in image]

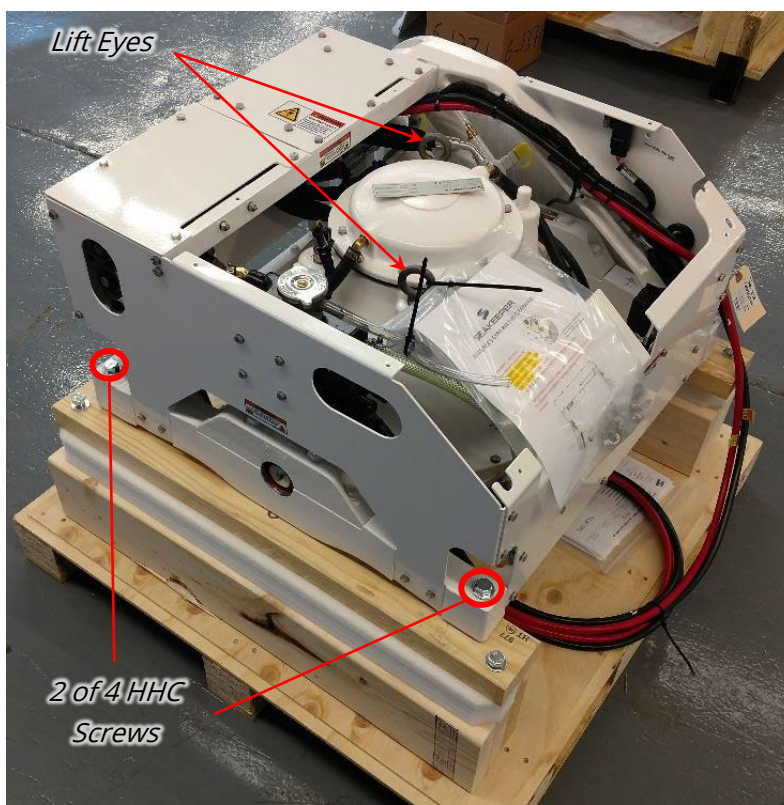

SEAKEEPER 2 UNPACKING INSTRUCTIONS



PRODUCT      SEAKEEPER 2

**CAUTION:**

**DAMAGE TO SEAKEEPER ENCLOSURE MAY OCCUR IF LIFTED BY SHORT SLINGS.**

8.    **ATTACH** long slings or spreader bar to lifting eyes (as shown in images below) at top of enclosure **AND LIFT** Seakeeper for placement.

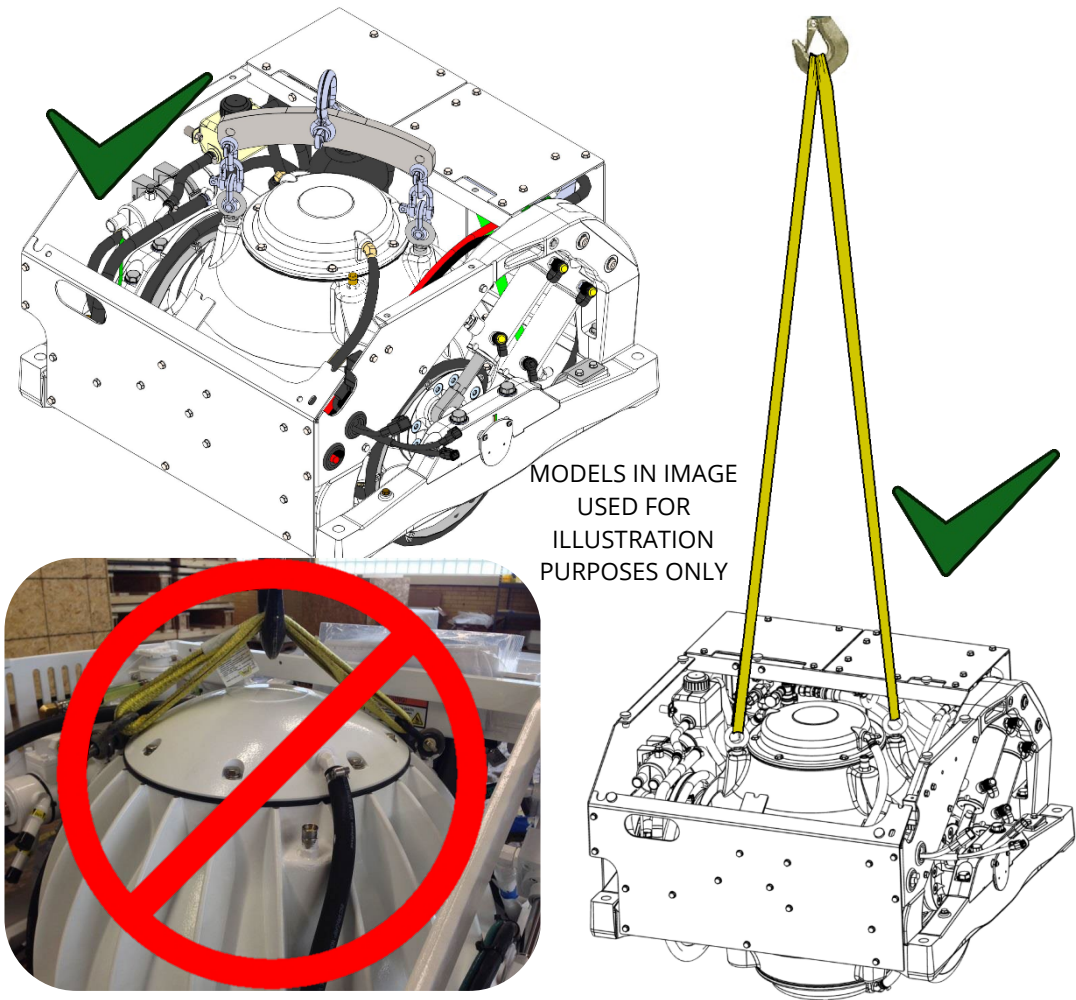

9.    **RETURN** Quick-Crates to Seakeeper for reuse.

\*\*\*\*\* **END** \*\*\*\*\*

Revision	Description	Approval	Date
2	Crate change	BRD	23MAY2019
3	Updated model. Crate change.	A Patricio	29MAR2023

SEAKEEPER 2 UNPACKING INSTRUCTIONS



PRODUCT      SEAKEEPER 2

ATTACHMENT

Quick-Crate Instructions:

<div><b>QUICK-CRATE®</b> <i>The tightest box in the business</i></div>		<div><b>Crate Assembly Instructions</b> Call for assistance 1.800.362.4569</div>
<div>Identify boards and clip leg lengths</div> <div><div>Top &amp; Base</div><div>End x 2</div><div>Side x 2</div></div> <div><div>*Milled Edge Perimeter*</div><div>*2 Vertical Milled Edges*</div><div>*No Milled Edges*</div></div> <div></div>	<div>Attach end to base with clips</div> <div></div> <div><b>Attach 1st</b></div> <div><b>2nd</b></div> <div></div> <div><b>**Always wear safety glasses when installing or removing clips**</b></div>	<div>Attach clip so that the long leg spans across the edge of the overlapping board</div> <div></div> <div><b>Next,</b></div> <div>Push the knee of the clip until it snaps into slot</div>
<div>Attach side to end and base</div> <div></div> <div><b>1st</b></div> <div><b>2nd</b></div> <div><b>3rd</b></div> <div><b>4th</b></div>	<div>Attach end to side and base</div> <div></div> <div><b>1st</b></div> <div><b>2nd</b></div> <div><b>3rd</b></div> <div><b>4th</b></div>	<div>Attach side to both ends and base</div> <div></div> <div><b>3rd</b></div> <div><b>4th</b></div> <div><b>1st</b></div> <div><b>2nd</b></div> <div><b>5th</b></div> <div><b>6th</b></div>
<div>Fit top between the 2 sides and slide into place</div> <div></div>	<div>Be sure top is fully seated, then attach with remaining clips</div> <div></div>	<div>To remove, insert tool into raised pocket on long leg of clip and rotate tool towards center of panel</div> <div></div> <div><b>** Always cover clip with hand when removing **</b></div>

Quick-Crate® is Registered with the U.S. Patent & Trademark Office