

NOTES:
1) THIS DWG. REPRESENTS A SUB-GROUP OF COMPONENTS WITHIN THE SK6/5 COOLING SYSTEM BILL OF MATERIAL AND DOES NOT NECESSARILY REPRESENT THE ACTUAL ASSEMBLY PROCEDURE. THIS DWG DOES PROVIDE TECHNICAL INFORMATION REGARDING COMPONENT LOCATION, SUGGESTED HOSE ROUTING, AND FASTNER APPLICATION.
2) USE TEFLON PIPE THREAD SEALANT ON ALL TAPERED PIPE THREAD FITTINGS, DO **NOT** USE TEFLON TAPE.

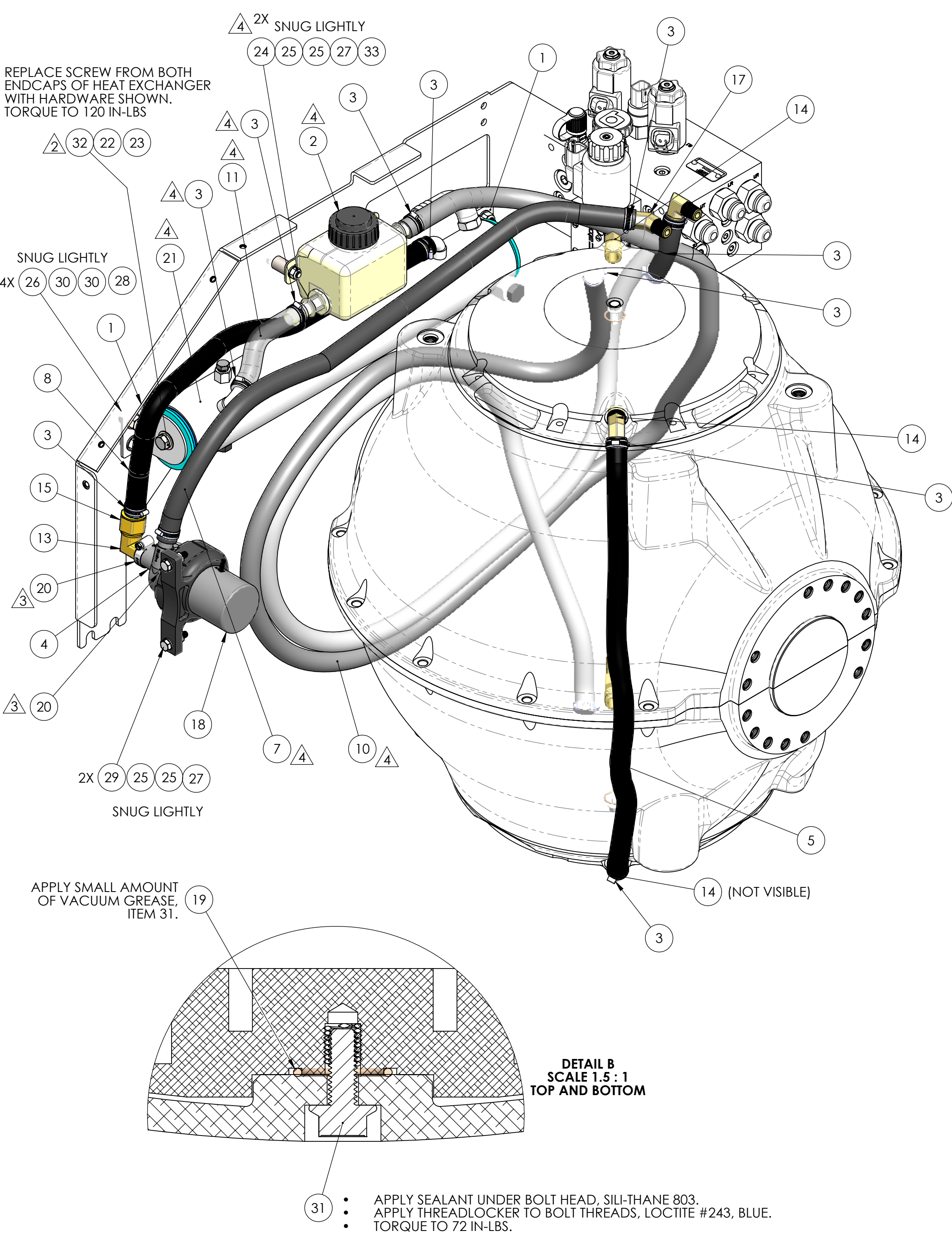

REV NO.	ECN NO.	ZONE	DESCRIPTION	DATE	APPRVD.
2	558	F8	REPLACE 60186 WITH 6054. REPLACE 60141 WITH 60002. REPLACE 60140 WITH 60003.	15SEP2017	BRD
3	638	C/D8	COOLANT PUMP INLET HOSE CLAMPS CHANGED FROM SIZE 10 TO SIZE 08. REMOVED 30015 FROM BOM.	25JUL2018	EMS
4	0845	D6/E7	REPLACED 40384, HEAT EXCHANGER WITH 40706, SK9 HEAT EXCHANGER. ADDED (1x)12431, SK6/9 COOLANT RESERVOIR AND NECESSARY HARDWARE; ADDED (1x) 40227, 40223, COOLANT HOSE, WATERJACKET TO HEAT EXCHANGER LENGTH CHANGED, WAS 80in AND 40223, COOLANT HOSE, PUMP TO DRIVE LENGTH CHANGED, WAS 28in.	11/11/2020	WMG

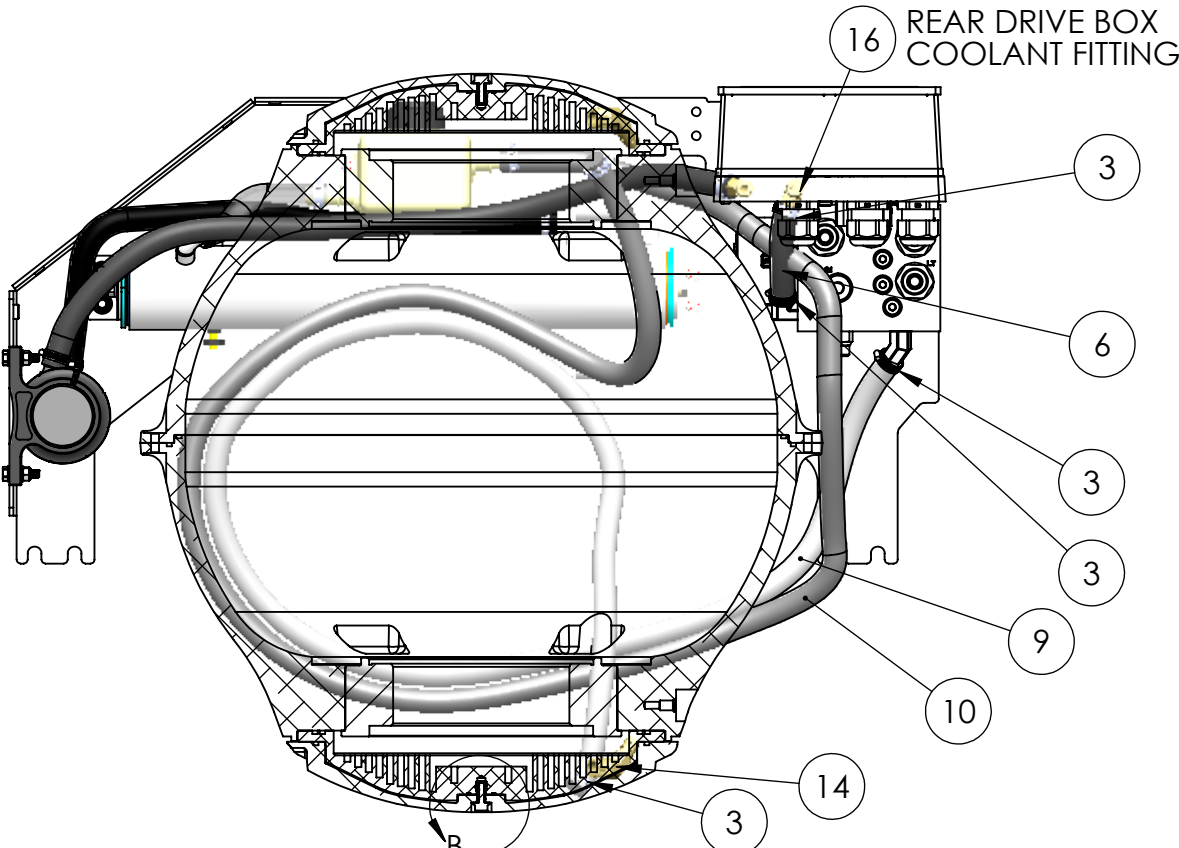

35	70054	THREADLOCKER, LOCTITE #243, BLUE	1
34	70001	VACUUM GREASE	1
33	60758	UNTHREADED SPACER, M6 SCREW SIZE, 18MM LONG, 18-8 SS	2
32	60541	HEX HD CAP SCREW, .56-18 X .87 LG	2
31	60365	SCREW, HEX HD FLANGED M6-1.0 X 16MM FULL TD	2
30	60330	WASHER, FLAT DIN125 M8	8
29	60321	SCREW, HEX HD CAP M6-1.0 X 25MM FULL TD	2
28	60267	HEX NUT, NYLOK M8-1.2 SS	4
27	60255	HEX NUT, NYLOK M6-1.0	4
26	60246	HEX HD CAP SCREW M8-1.25 X 20mm LG. 316SS	4
25	60223	WASHER, FLAT, M6 12MM OD	4
24	60222	HHCS M6-1.0 X 35mm LG FULL THREAD	2
23	60003	WASHER, FLAT TYPE B NARROW 0.31	2
22	60002	WASHER, SPLIT LOC .31	2
21	40706	SEAKEEPER 6 HEAT EXCHANGER W/O THERMOSTAT	1
20	40607	HOSE CLAMP, SIZE 8, 1/2" to 29/32" Dia.	2
19	40472	O-RING, SAE-017	2
18	40434	COOLING PUMP, 12VDC, .625 INLET X .5 OUTLET, WATERPROOF	1
17	40397	ELBOW, 45 DEG FTG. .50 HOSE ID X .25 NPT MALE	1
16	40388	ELBOW, 90 DEG BARBED FTG. 1/2" HOSE ID X 1/4" NPT MALE	1
15	40289	HOSE BARBER ADAPTER, 1/2" HOSE ID X .5" NPTF FEMALE PIPE	1
14	40257	ELBOW, 45 DEG BARBED FTG 1/2" HOSE ID X 3/8" NPT MALE	4
13	40256	90 DEG ELBOW, 5/8" HOSE ID X 1/2" NPT MALE PIPE	1
12	40250	SILI-THANE 803 MARINE SEALANT	1
11	40227	CLEAR, REINFORCED PVC HOSE, .50" ID X 5-1/8" LONG	5-1/8"
10	40223	COOLANT HOSE, 1/2" ID x 77" LG, WATERJACKET TO HE	77"
9	40223	COOLANT HOSE, 1/2" ID x 60" LG, MANIFOLD TO WATERJACKET	60"
8	40223	COOLANT HOSE, 1/2" ID x 20" LG, HE TO PUMP	15.5"
7	40223	COOLANT HOSE, 1/2" ID x 26-1/4" LG, PUMP TO DRIVE	26-1/4"
6	40223	COOLANT HOSE, 1/2" ID x 4.5" LG, MANIFOLD TO DRIVE	4.5"
5	40223	COOLANT HOSE, 1/2" ID x 23" LG, WATERJACKET TO WATERJACKET	23"
4	40199	COOLANT HOSE, .625" ID x 2" LG, ADAPTOR TO PUMP	2"
3	40026	HOSE CLAMP, SIZE 06, 7/16"-25/32" CLAMP ID, 5/16" BAND WIDTH	14
2	12431	SEAKEEPER 6/9 COOLANT RESERVOIR	1
1	10975	SEAKEEPER 5 HEAT EXCHANGER MOUNTING BRACKET	2
ITEM NO.	PART NUMBER	DESCRIPTION	QTY.

WEIGHT - LBS :

MATERIAL:

DRAWN:
WHK

ENG APPR:

PROD APPR:

DATE:
14JULY2016

DATE:

DATE:

PROPRIETARY AND CONFIDENTIAL
THE INFORMATION CONTAINED IN THIS DRAWING IS THE SOLE PROPERTY OF SEAKEEPER INCORPORATED. ANY REPRODUCTION IN PART OR AS A WHOLE WITHOUT THE WRITTEN PERMISSION OF SEAKEEPER IS PROHIBITED.

SEAKEEPER
Seakeeper Inc. 44425 Pecan Court, Suite 151 California, MD 20619

NAME:
SK6 / 5 COOLING SUB-SYSTEM
SERVICE REFERENCE

DWG NUMBER
11677-SP

REV. NO. SHEET NO.
4 1 OF 1