

NOTES:
1) THIS DWG. REPRESENTS A SUB-GROUP OF COMPONENTS WITHIN THE SK6 COVER AND GUARD SYSTEM BILL OF MATERIAL AND DOES NOT NECESSARILY REPRESENT THE ACTUAL ASSEMBLY PROCEDURE. THIS DWG DOES PROVIDE TECHNICAL INFORMATION REGARDING COMPONENT LOCATION AND FASTENER APPLICATION.
2) ITEMS 6, 7, AND 11. ARE REMOVEABLE FOR INSTALLATION AND SERVICE WITH STAINLESS STEEL HARDWARE. PAINTING THIS HARDWARE IS NOT NECESSARY.
3) THREADLOCKER SHOULD BE APPLIED TO REMOVABLE COVERS JUST PRIOR TO SHIPPING AFTER ALL FINAL GYRO TESTING

REV NO.	ECN NO.	ZONE	DESCRIPTION	DATE	APPRVD.
1.1	0765		UPDATED SK6 FACE PANEL, REMOVED 5HD	6/17/2019	AVM
2	0781		REMOVED SEAKEEPER ENGRAVING FROM TOP PANEL.	10/7/2019	EMS
3	0697		CHANGES TO SHEET METAL FOR RECTIFIED MANIFOLD.	12/6/2019	EMS

APPLY BLUE THREAD LOCKER, ITEM 13 TO BOLT THREADS. SNUG TIGHTLY.

9 12 4X

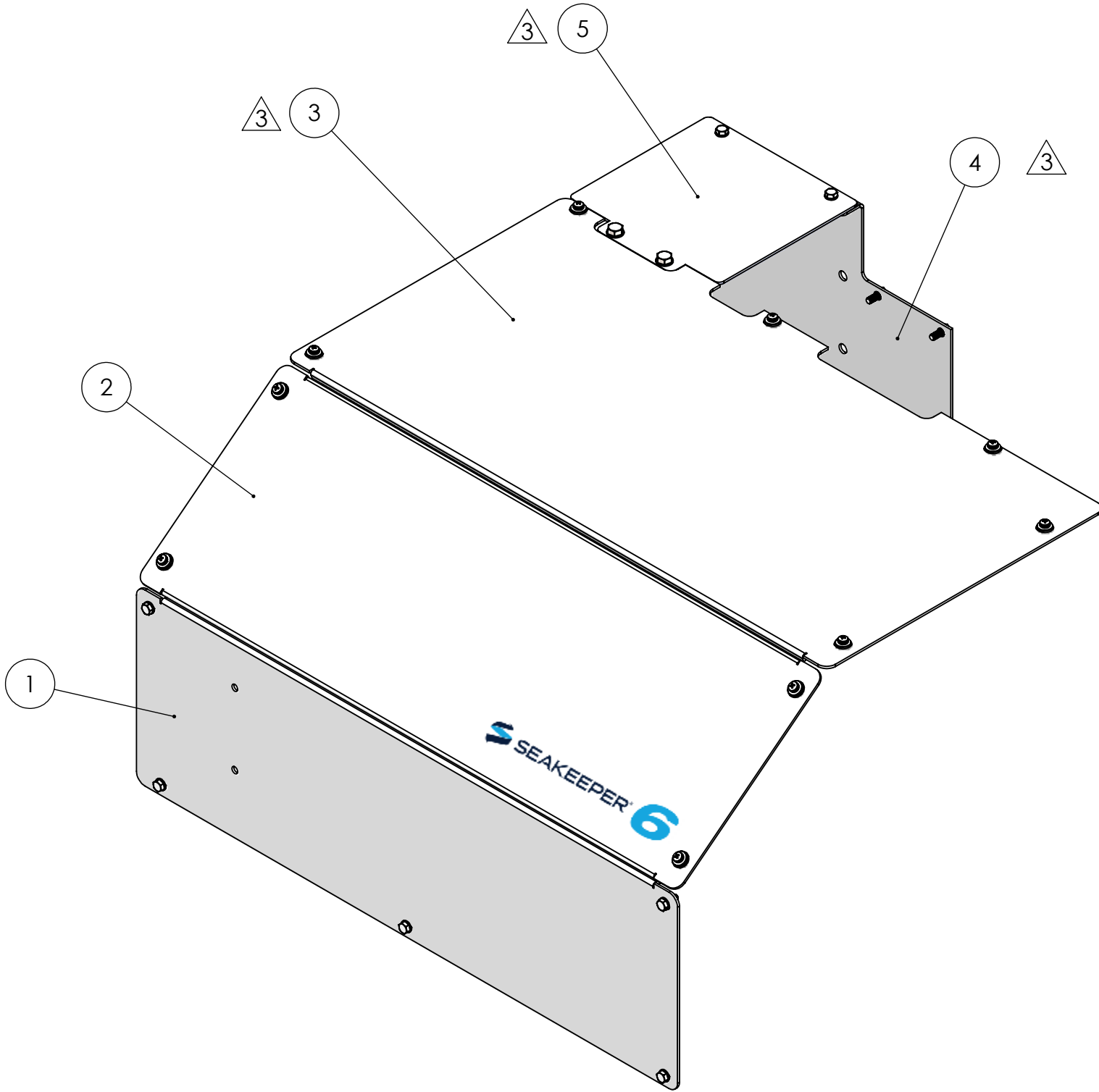
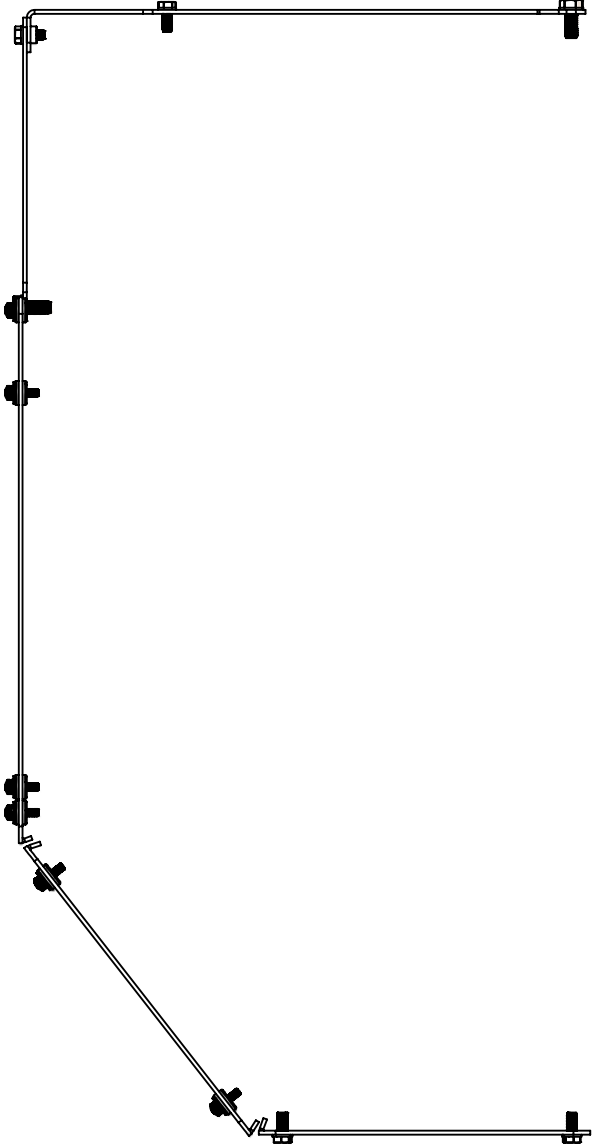
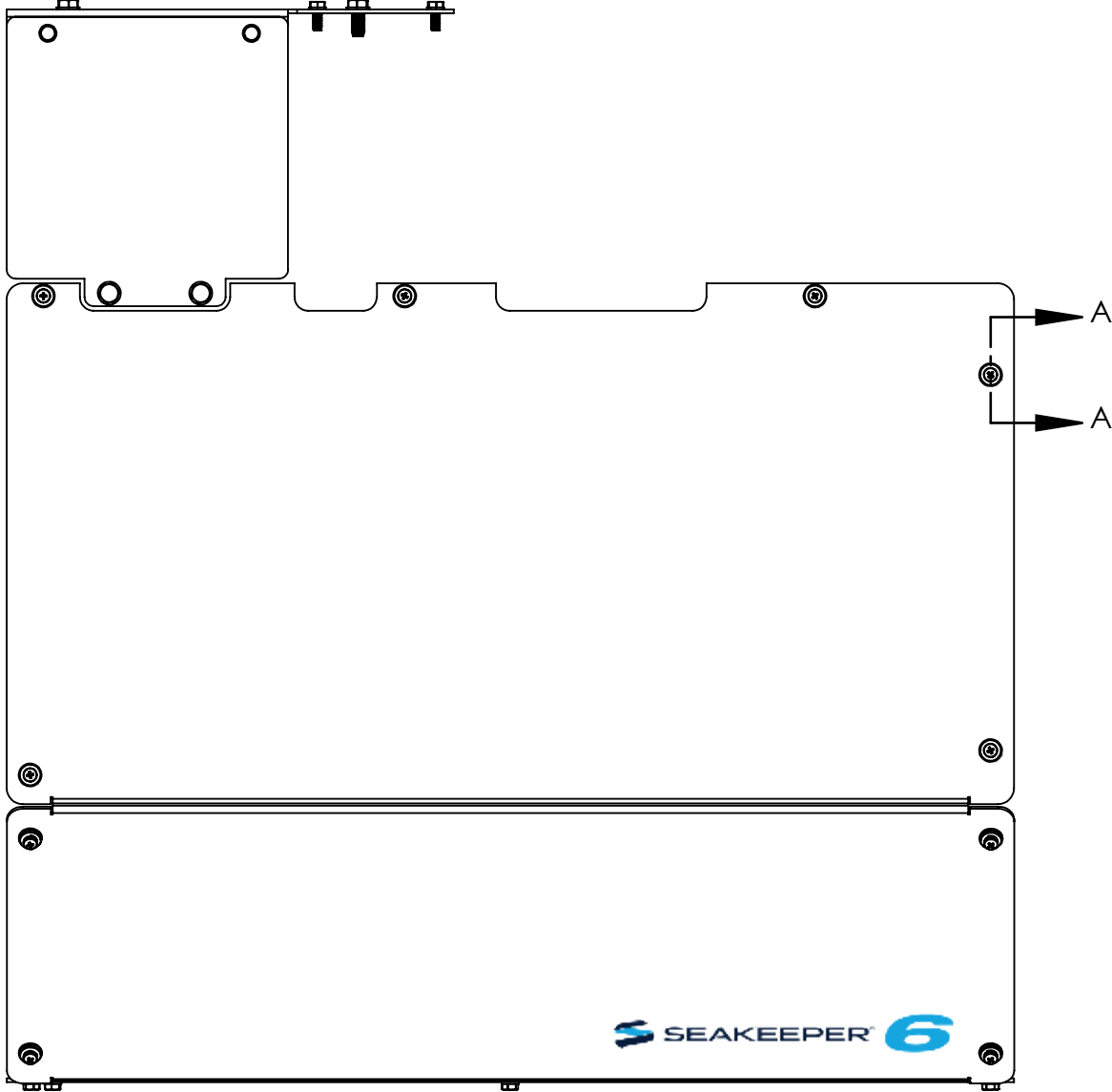

SNUG TIGHTLY.

11 7 6 10X

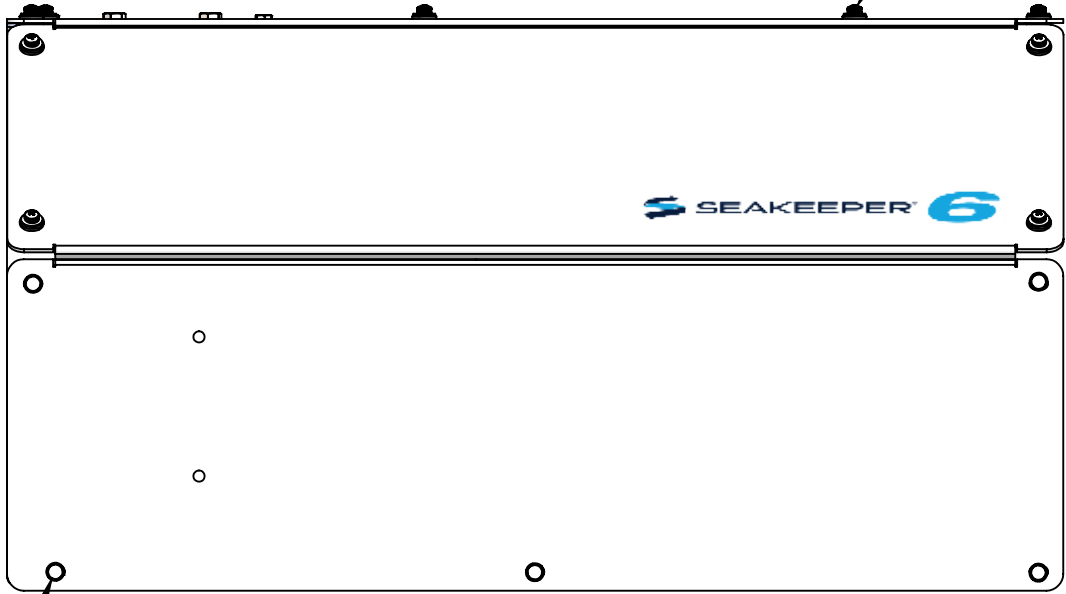

10 8 9X

APPLY BLUE THREAD LOCKER, ITEM 13 TO BOLT THREADS. SNUG TIGHTLY.

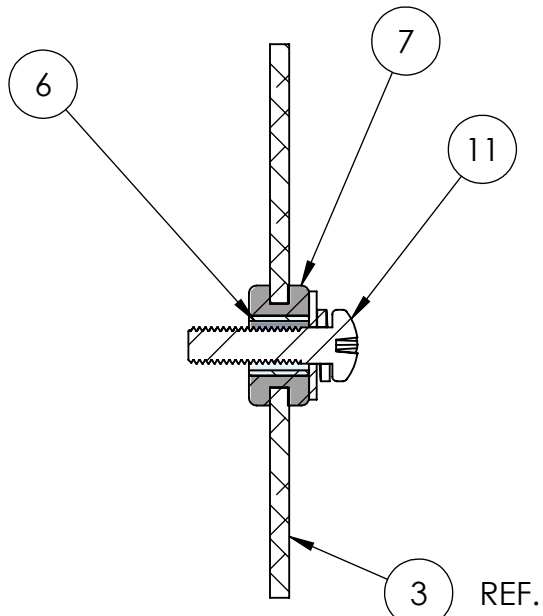

SECTION A-A

13	70054	THREADLOCKER, LOCTITE #243, BLUE	---	AR
12	60330	WASHER, FLAT DIN125 M8	316 SS	4
11	60263	PAN HD PHILLIPS SCREW, INTEGRATED WASHERS 10-32 X 3/4"	18-8 SS	10
10	60256	HEX HEAD CAP SCREW, M6-1.0 X 16mm LG	316 SS	9
9	60246	HEX HD CAP SCREW M8-1.25 X 20mm LG. 316SS	316SS	4
8	60223	WASHER, FLAT, M6 12MM OD	316SS	9
7	40342	RUBBER GROMMET, .31 ID X .62 OD X .31 THK.	NITRILE RUBBER	10
6	40341	ALUMINUM SLEEVE BUSHING	6061-T6 ALUM	10
5	12164	SK6 MANIFOLD COVER PANEL, RECTIFIED MANIFOLD	ALUMINUM 5052	1
4	12163	SK6 MANIFOLD & IMU PANEL, RECTIFIED MANIFOLD	ALUMINUM 5052	1
3	12161	SK6 TOP PANEL, RECTIFIED MANIFOLD	ALUMINUM 5052	1
2	11654	SK6 FACE PANEL	ALUMINUM 5052	1
1	11638	SK6 FRONT PANEL	ALUMINUM 5052	1
ITEM NO.	PART NO.	DESCRIPTION	MATERIAL	QTY.

WEIGHT - LBS : ---

MATERIAL: ---

PROPRIETARY AND CONFIDENTIAL

THE INFORMATION CONTAINED IN THIS DRAWING IS THE SOLE PROPERTY OF SEAKEEPER INCORPORATED. ANY REPRODUCTION IN PART OR AS A WHOLE WITHOUT THE WRITTEN PERMISSION OF SEAKEEPER IS PROHIBITED.

DRAWN: WHK
ENG APPR: DATE: 14SEP2016
PROD APPR: DATE:

SEAKEEPER®

Seakeeper Inc. 44425 Pecan Court, Suite 151 California, MD 20619

NAME: SK6 COVER SUB-SYSTEM SERVICE REFERENCE

DWG NUMBER 11678-SP

REV. NO. 3
SHEET NO. 1 OF 1