

NOTES: 1) THIS DRAWING REPRESENTS A SUB-GROUP OF COMPONENTS WITHIN THE SEAKEEPER 16 AND 18 ELECTRONICS SYSTEM BILL OF MATERIAL AND DOES NOT NECESSARILY REPRESENT ANY ACTUAL ASSEMBLY PROCEDURE. THIS DRAWING DOES PROVIDE TECHNICAL INFORMATION REGARDING COMPONENT LOCATION, SUGGESTED WIRE HARNESS ROUTING, AND FASTENER APPLICATION

2) ITEMS SHOWN IN PHANTOM ARE FOR REFERENCE ONLY AND ARE DISPLAYED TO SHOW WIRE HARNESS CONNECTIONS.

3) SOME ITEMS SHOWN ARE FOR BILL OF MATERIAL REFERENCE ONLY AND MAY NOT GET ASSEMBLED TO SEAKEEPER UNTIL INSTALLATION, THESE ITEMS WILL SHIP SEPARATELY.

4) WHEN USING LOCTITE THREADLOCKER, REFER TO WORK INSTRUCTION WI-085 FOR PROPER APPLICATION.

4 5) FOLLOW PWI-0038, CHANGES TO ELIMINATE VACUUM PRESSURE SENSOR, #30288 AND MODIFIED WIRE HARNESS.

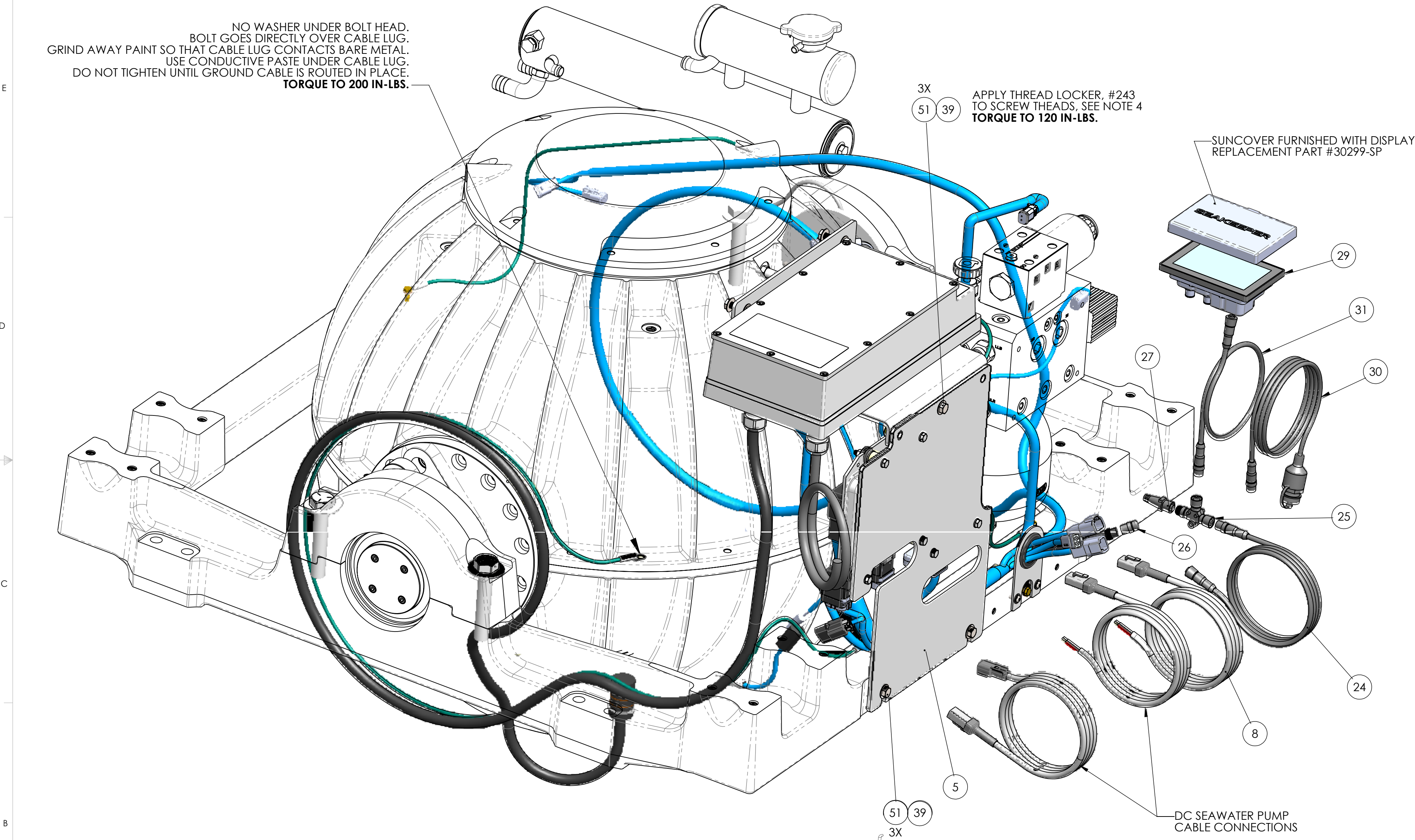

REV.	ECN NO.	ZONE	DESCRIPTION	DATE	APPROVED
1	0757	---	RELEASED FOR PRODUCTION	10/29/2019	WMG
2	0808	---	NO CHANGES MADE TO THIS DRAWING. REVISED DRAWING TO VISUALLY REFLECT THE CHANGES MADE TO THE MANIFOLD, 50298	2/13/2020	WMG
3	0830	SHT 2,E1	REPLACED #30179, MARINE GRADE ELECTRICAL CABLE, 10-3 AC POWER WITH ITEM #12, 20394, AC INPUT POWER 10/3 CABLE ASSEMBLY; #30197, QTY CHANGED FROM 5 TO 3; REMOVED #30240	6/18/2020	WMG
Cut-in 4	18-203-0118 0841	SHT1, F5, SHT3, B7	REPLACED WASCO VACUUM PRESSURE SENSOR, 30288 WITH ORB HEX SOCKET O-RING BOSS PLUG, 60760 AND ADDED NOTE #5	8/11/2020	WMG

65	70087	THREAD LOCKER, LOC-TITE #425, BLUE	---	AR	
64	70061	THERMAL JOINT COMPOUND - WAKEFIELD TYPE 120	---	AR	
63	70054	THREAD LOCKER, LOC-TITE #243, BLUE	---	AR	
62	60760	ORB HEX SOCKET O-RING BOSS PLUG, 316 SS	316 SS		1
61	60370	SCREW, HEX HD FLANGED M6-1 X 12MM FULL TD	18-8 SS		2
60	60321	SCREW, HEX HD CAP M6-1.0 X 25MM FULL TD	316 SS		2
59	60278	HEX HD CAP SCREW,M6-1.0 X 16mm LG, FULL THREAD	BRASS		5
58	60267	HEX NUT, NYLOK M8-1.2 SS	316 SS		2
57	60260	STAND OFF, NYLON, .31X.75X.5	NYLON		4
56	60259	BTN SKT HD MACHINE SCREW M5-.8 X 12mm LG	18-8 SS		5
55	60258	HHCS M6-1.0 X 45mm LG	316 SS		4
54	60256	HEX HEAD CAP SCREW, M6-1.0 X 16mm LG	316 SS		4
53	60255	HEX NUT, NYLOK M6-1.0	316 SS		6
52	60247	HEX HD CAP SCREW M8-1.25 X 40mm LG 316SS	316SS		2
51	60246	HEX HD CAP SCREW M8-1.25 X 20mm LG. 316SS	316SS		3
50	60223	WASHER, FLAT, M6 12MM OD	316SS		16
49	60177	SCREW, PHILLIPS HD PAN 8-32 X 0.63	18-8 SS		2
48	60161	NUT, NYLOCK HEX 8-32	18-8 SS		2
47	60096	WASHER, SPLIT LOC .25 ID	SILICON BRONZE		5
46	60038	FLAT WASHER, M4	18-8 SS		2
45	60037	SPRING LOCK WASHER, M4	18-8 SS		2
44	60036	BUTTON SKT HD CAP SCREW, M4-.7 X 20MM LG	18-8 SS		2
43	60034	SCREW, SOCKET HD CAP M4-.7 X 16MM FULL TD	18-8SS		2
42	60033	FLAT WASHER #10	316SS		9
41	60017	SKT HD CAP SCREW, #10-24 X 2.25 LG	ALLOY STEEL		8
40	60015	WASHER, HI COLLAR LOC #10	ALLOY STEEL		8
39	60003	WASHER, FLAT TYPE B NARROW 0.31	316 SS		7
38	40367	GROMMET, PUSH IN 1-1/4 ID X 3/32 PANEL THKNSS.	SBR RUBBER		1
37	40366	MOTOR DRIVE COVER LABEL	ANODIZED ALUM.		1
36	40250	SILI-THANE 803 MARINE SEALANT	---	AR	
35	40142	O-RING, SIZE 024 A75 DUROMETER	VITON		2
34	40107	RETAINING RING, EXTERNAL, 1.25 DIA	SS		1
33	30323	BLIND PLUG, 514GFK/225/OR, THREAD M25x1.5, POLYAMIDE, WITH O-RING	Polyamide GRP		1
32	30302	ECU ASSEMBLY WITH BOOT LOAD SECURITY	---		1
31	30301	CABLE, 2FT. MALE/FEMALE, NMEA 2000 PLASTIC MICRO	---		1
30	30300	CABLE, M12 12 PIN MALE TO USB-A RECEPTACLE	---		1
29	30298	5 INCH TOUCH DISPLAY, GYRO CONTROLLER	---		1
28	30254	RING TERMINAL, 12-10 GA SIZE #8 INSULATED, YELLOW	---		1
27	30249	TERMINATOR, NMEA 2000 MICRO, 120OHM FEMALE	PLASTIC		1
26	30246	AMPHENOL LTW PLASTIC CAP, MALE	---		1
25	30244	DISPLAY CABLE T- ADAPTOR	---		1
24	30243	CABLE, MALE/FEMALE, NMEA 2000 PLASTIC MICRO, 25M LG.	---		1
23	30241	POWER RELAY	---		2
22	30235	THERMISTOR, GE WTS 1797	316 SS		2
21	30197	FERRULE 10 AWG, .47" PIN LENGTH	---		3
20	30016	LARGE CLICK BOND WIRE TIE ANCHOR	COMPOSITE		4
19	30015	SMALL CLICK BOND WIRE TIE ANCHOR	COMPOSITE		3
18	30003	POSITION MARKER	---		1
17	20455	GYRO DC INPUT POWER CABLE ASSEMBLY, 5M LG.	---		1
16	20454	DC OUTPUT POWER CABLE ASSY, 2X14AWG, DTP FEMALE ONLY, 5M LENGHT	---		1
15	20446	SEAKEEPER 18 WIRE HARNESS	---		1
14	20409	SK18 ROTOR ASSEMBLY	---		1
13	20403	SEAKEEPER 18 MOTOR STATOR AND HOUSING ASSEMBLY	---		1
12	20394	AC INPUT POWER 10/3 CABLE ASSEMBLY	---		1
11	20350	CAN IMU VERSION 2	---		1
10	20252	SEAKEEPER 16 GROUND CABLE ASSEMBLY, 25-1/2"	---		1
9	20251	SEAKEEPER 16 SPHERE GROUND CABLE ASSEMBLY, 4 AWG, 69"	---		1
8	20248	GYRO DC INPUT POWER CABLE ASSEMBLY, 5M LG.	---		1
7	20222	GIMBAL ANGLE SENSOR & CONNECTOR ASSEMBLY	---		1
6	20216	SEAKEEPER MOTOR DRIVE BOX	ALUMINUM		1
5	12190	SEAKEEPER 18 ELECTRICAL COMPONENT PANEL	.18 ALUM. SHEET		1
4	12126	SEAKEEPER 18 MOTOR CABLE SHIELD	5052 ALUM.		1
3	11165	SEAKEEPER 16 CABLE BULKHEAD PLATE	.100 ALUM SHT.		1
2	11109	SEAKEEPER 16 MOTOR DRIVE BOX MOUNT	.18 ALUM. SHEET		1
1	11050	SEAKEEPER 16 ANGLE SENSOR MOUNT FINISH MACHINED	CAST ALUM		1
ITEM NO.	PART NO.	DESCRIPTION	MATERIAL	QTY.	NOTE

THE INFORMATION CONTAINED IN THIS DRAWING IS THE SOLE PROPERTY OF SEAKEEPER INCORPORATED. ANY REPRODUCTION IN PART OR AS A WHOLE WITHOUT THE WRITTEN PERMISSION OF SEAKEEPER IS PROHIBITED.		<b>SEAKEEPER</b> Seakeeper Inc. 44425 Pecan Court, Suite 151 California, MD 20619	
WEIGHT - LBS : ---	MATERIAL: ---	DRAWN: WMG 06NOV2019 ENG APPR: WHK 08NOV2019 PROD APPR: ---	DATE: 08NOV2019 DWG NUMBER: 20438-SP REV. NO: 4 SHEET NO: 1 OF 3



