

NOTES: 1) THIS DRAWING REPRESENTS A SUB-GROUP OF COMPONENTS THAT ARE WITHIN THE SEAKEEPER 35 ELECTRONICS SUB-SYSTEM BILL OF MATERIAL AND DOES NOT NECESSARILY REPRESENT ANY ACTUAL ASSEMBLY PROCEDURE. THIS DRAWING DOES PROVIDE TECHNICAL INFORMATION REGARDING COMPONENT LOCATION, SUGGESTED WIRE HARNESS ROUTING, AND FASTENER APPLICATION.
 2) SOME ITEMS SHOWN IN PHANTOM ARE FOR REFERENCE ONLY TO SHOW WIRE HARNESS CONNECTIONS, AND CABLE ROUTING.
 3) THE GYRO DISPLAY COMPONENTS ARE SHOWN FOR BOM REFERENCE AND DO NOT GET ASSEMBLED TO GYRO.

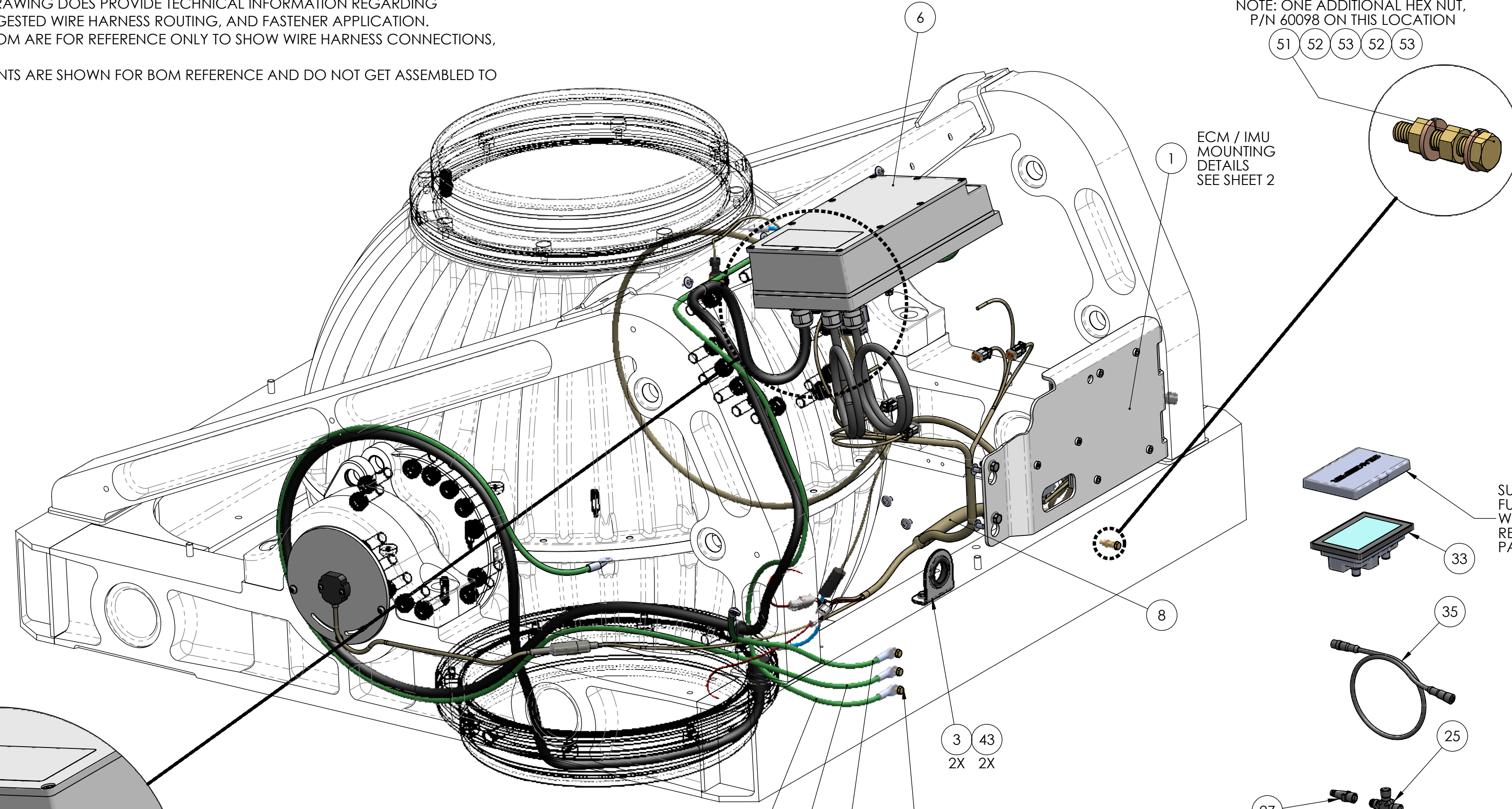

VESSEL GROUND CONNECTION
 "SEE GROUNDING FASTENER DETAIL"
 NOTE: ONE ADDITIONAL HEX NUT,
 P/N 60098 ON THIS LOCATION

ECM / IMU MOUNTING
 DETAILS
 SEE SHEET 2

SUNCOVER
 FURNISHED
 WITH DISPLAY
 REPLACEMENT
 PART 30299-SP

GROUNDING FASTENER DETAIL

REMOVE PAINT AROUND HOLE
 BOTH SIDES, USE CORROSION RESISTANT
 CONDUCTIVE PASTE UNDER GROUND
 LUG AND WASHER.
 4 PLACES

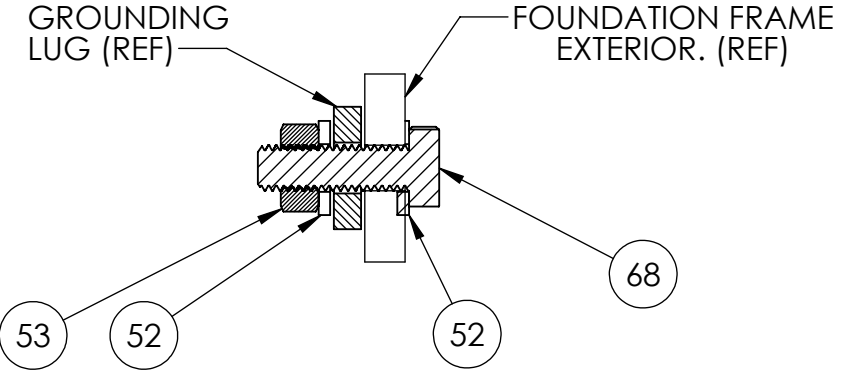

DRIVE BOX GROUND DETAIL

REMOVE ANY PAINT ON SURFACE THAT
 GROUND LUG WILL MAKE CONTACT WITH.
 USE CORROSION RESISTANT CONDUCTIVE PASTE
 UNDER GROUND LUG AND BRONZE WASHERS.

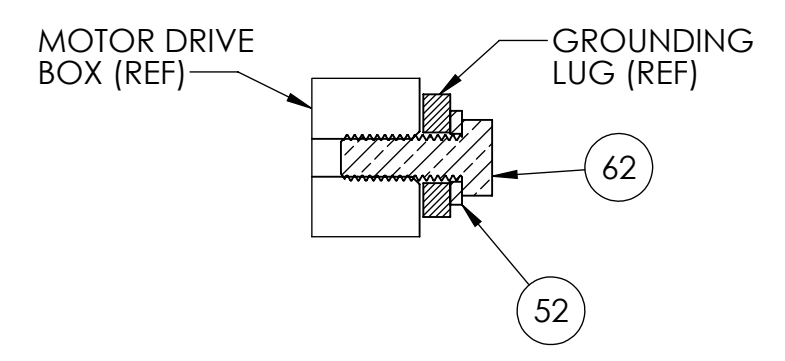

DETAIL E
 SCALE 2 : 5

1X 40246
 3X 30197

USE SILL-THANE 803 MARINE SEALANT
 AROUND BOLT HOLES IN FRAME.
 APPLY THREADLOCKER,
 LOCTITE #243 BLUE
 TO BOLT THREADS.
 TORQUE EQUALLY TO 40 IN / LBS

45 63
 3X 3X

48 49 50
 2X 2X 2X

REV NO.	ECN NO.	ZONE	DESCRIPTION	DATE	APPRVD.
3	452, 504		GROUND CABLES CHANGED FROM 4AWG TO 10AWG. REPLACED ALL SERRATED TOOTH LOCK WASHERS WITH SPLIT LOCK WASHERS UNDER GROUND SCREWS. ADDED 40107 (1) AND 40142 (2).	24FEB2017	BRD
4	484, 504		REPLACED SENSATA VAC SENSOR 30236 WITH WASCO SENSOR 30288. ADDED 40107 AND 40142.	14APR2017	BRD
5	535, 566		REPLACED 30234 WITH 30302. REMOVED 30268, 30269, 20223, 30246, 20208. ADDED 30298, 30301.	16NOV2017	BRD
6	716		IMU2 REPLACED IMU1 - 20350 REPLACED 20206. 60365 (2) REPLACED 60321 AND 60223 (2).	1/31/2019	BRD
7	762		ADDED FLYWHEEL GUARD.	10/22/2019	EMS
8	0830		REPLACED 30179, MARINE GRADE ELECTRICAL CABLE. 10-3, AC POWER, 12.5 FT LONG WITH ITEM #15, 20394, AC INPUT POWER 10/3 CABLE ASSEMBLY; AND REPLACED MARINE GRADE ELECTRICAL CABLE. 10-3, SEAWATER PUMP, 12.5 FT LONG ITEM #16, 20394, AC INPUT POWER 10/3 CABLE ASSEMBLY; REMOVED #30255, RING TERMINAL, 1.6-1.4 GA, SIZE #8 INSULATED, BLUE (QTY 1) AND #34, 30280, FERRULE, 16 AWG, .47" PIN LENGTH (QTY 2); #30197 QTY CHANGED FROM 5 TO 3	6/19/2020	WMG

72	70061	THERMAL JOINT COMPOUND, WAKEFIELD TYPE 120	---	AR
71	70054	THREADLOCKER, LOCTITE #243, BLUE	---	AR
70	70029	CORROSION RESISTANT CONDUCTIVE PASTE	---	AR
69	70001	VACUUM GREASE	---	AR
68	60406	SCREW, HEX HD CAP, M6-1.0 X 20MM, FULL TD	BRASS	3
67	60379	SCREW, HEX HD CAP, M6-1.0 X 35MM, FULL TD	316 STAINLESS STEEL	4
66	60370	SCREW, HEX HD FLANGED M6-1 X 12MM FULL TD	18-8 SS	6
65	60365	SCREW, HEX HD FLANGED M6-1.0 X 16MM FULL TD	18-8 SS	6
64	60363	SCREW, HEX HD FLANGED M8-1.25 X 20MM FULL TD	18-8 STAINLESS	4
63	60309	SCREW, SOCKET HD BUTTON, M5-.8 X 16MM, FULL TD	316 SS	3
62	60278	HEX HD CAP SCREW, M6-1.0 X 16mm LG, FULL THREAD	BRASS	1
61	60271	SCREW, SOCKET HD CAP 10-24 x 1.25 FULL TD	ALLOY STEEL	8
60	60260	STAND OFF, NYLON, .31X.75X.5	NYLON	4
59	60257	SCREW, HEX HD CAP M6-1.0 X 20MM FULL TD	316 SS	1
58	60255	HEX NUT, NYLON M6-1.0	316 SS	1
57	60223	WASHER, FLAT, M6 12MM OD	316SS	4
56	60177	SCREW, PHILLIPS HD PAN 8-32 X 0.63	18-8 SS	1
55	60162	FLAT WASHER, #8	316 SS	2
54	60161	NUT, NYLOCK HEX 8-32	18-8 SS	1
53	60098	NUT, FULL HEX, DIN 934, M6-1.0	BRASS	5
52	60096	WASHER, SPLIT LOC .25 ID	SILICON BRONZE	9
51	60090	SCREW, HEX HD CAP, M6-1.0 X 30MM, FULL TD	BRASS	1
50	60038	FLAT WASHER, M4	18-8 SS	2
49	60037	SPRING LOCK WASHER, M4	18-8 SS	2
48	60036	BUTTON SKT HD CAP SCREW, M4-.7 X 20MM LG	18-8 SS	2
47	60035	WASHER, SPLIT LOC DIN7980, M4	18-8 SS	2
46	60034	SCREW, SOCKET HD CAP M4-.7 X 16MM FULL TD	18-8SS	2
45	60033	FLAT WASHER #10	316SS	3
44	60015	WASHER, HI COLLAR LOC #10	ALLOY STEEL	8
43	40367	GROMMET, PUSH IN 1-1/4 ID X 3/32 PANEL THKNSS.	SBR RUBBER	2
42	40366	MOTOR DRIVE COVER LABEL	ANODIZED ALUM.	1
41	40250	SILI-THANE 803 MARINE SEALANT	POLYURETHANE	AR
40	40246	SHRINK TUBING, 3/4" X 1" LG. (USED ON MOTOR POWER CABLE)	---	---
39	40142	O-RING, SIZE 024 A75 DUROMETER	VITON	2
38	40107	RETAINING RING, EXTERNAL, 1.25 DIA	SS	1
37	40093	RUBBER CUSHION LOOP CLAMP, .5 DIA	300 SER SS	1
36	30302	ECU ASSEMBLY WITH BOOT LOAD SECURITY	---	1
35	30301	CABLE, 2FT. MALE/FEMALE, NMEA 2000 PLASTIC MICRO	---	1
34	30300	CABLE, M12 12 PIN MALE TO USB-A RECEPTACLE	---	1
33	30298	5 INCH TOUCH DISPLAY, GYRO CONTROLLER	---	1
32	30288	VACUUM SENSOR, WASCO	BRASS	1
30	30261	CABLE TIE MOUNT, PUSH IN TYPE	---	7
28	30254	RING TERMINAL, 12-10 GA. #8 STUD, NYLON INSULATED, YELLOW	---	1
27	30249	TERMINATOR, NMEA 2000 MICRO, 120OHM FEMALE	PLASTIC	1
26	30246	AMPHENOL LTW PLASTIC CAP, MALE	---	1
25	30244	DISPLAY CABLE T- ADAPTOR	---	1
24	30243	CABLE, MALE/FEMALE, NMEA 2000 PLASTIC MICRO, 25M LG.	---	1
23	30241	POWER RELAY	---	1
22	30235	THERMISTOR, GE WTS 1797	316 SS	2
21	30197	FERRULE, 10AWG, .47 PIN LENGTH	---	3
20	30190	MOISTURE SEAL, HEAT SHRINK END CAP	---	3
19	30112	TUBING, HEAT SHRINKABLE, WITH ADHESIVE, BLK, 1/2" DIA X 3' LG	---	1
18	30012	CABLE TIE, 50#, BLACK	NYLON	1
17	30003	POSITION MARKER	---	1
16	20395	AC OUTPUT POWER 14/3 CABLE ASSEMBLY	---	1
15	20394	AC INPUT POWER 10/3 CABLE ASSEMBLY	---	1
14	20350	CAN IMU VERSION 2	---	1
13	20248	GYRO DC INPUT POWER CABLE ASSEMBLY, 5M LG.	---	1
12	20239	SEAKEEPER 35, MOTOR ROTOR ASSEMBLY	---	1
11	20236	SEAKEEPER 35, GROUND CABLE ASSEMBLY, HEAT EXCHANGER TO FRAME	---	1
10	20235	SEAKEEPER 35, GROUND CABLE ASSEMBLY, ENCLOSURE TO FRAME	---	1
9	20234	SEAKEEPER 35, GROUND CABLE ASSEMBLY, DRIVE BOX TO FRAME	---	1
8	20230	SEAKEEPER 35, GYRO WIRING HARNESS	---	1
7	20222	GIMBAL ANGLE SENSOR & CONNECTOR ASSEMBLY	---	1
6	20216	SEAKEEPER MOTOR DRIVE BOX	ALUMINUM	1
5	20215	SEAKEEPER 35, MOTOR STATOR ASSEMBLY	---	1
4	12157	SK35 MOTOR CABLE SHIELD	5052 ALUM.	1
3	11141	SEAKEEPER 35, CABLE EXITING GUIDE	5052 ALUMINUM	2
2	11081	GIMBAL ANGLE SENSOR MOUNT	6061-T6	1
1	11056	SEAKEEPER 35, ECM / IMU MOUNTING BRACKET	5052 ALUMINUM	1

REMOVE PAINT AROUND HOLE
 USE CORROSION RESISTANT
 CONDUCTIVE PASTE UNDER GROUND
 LUG AND WASHER. "SEE DRIVE BOX
 GROUND DETAIL"

APPLY THREADLOCKER, LOCTITE #243, BLUE
 TO BOLT THREADS.
 TORQUE EQUALLY TO 72 IN/LBS.
 4X

SEAKEEPER
 Seakeeper Inc. 44425 Pecan Court, Suite 151 California, MD 20619

SEAKEEPER 35 ELECTRICAL SUB-SYSTEM,
 SERVICE REFERENCE

11132-SP

8 1 OF 2

LIGHTLY APPLY VACUUM GREASE TO O-RINGS PRIOR TO INSTALLING.

LIGHTLY APPLY VACUUM GREASE TO O-RINGS PRIOR TO INSTALLING.

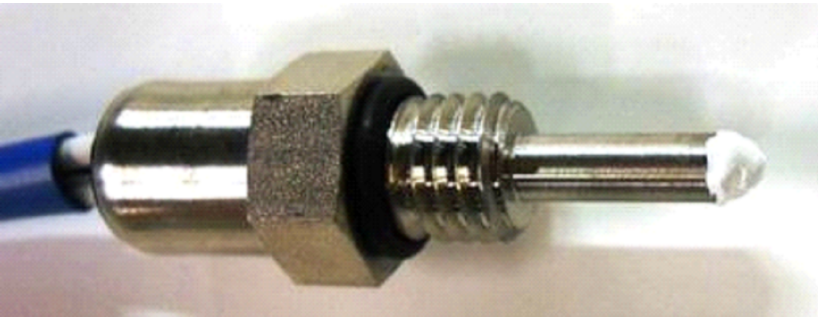

APPLY THERMAL PASTE COMPOUND, ITEM 70061 TO END OF SENSOR PROBE, AS SHOWN. LIGHTLY APPLY VACUUM GREASE TO O-RING PRIOR TO INSTALLATION.

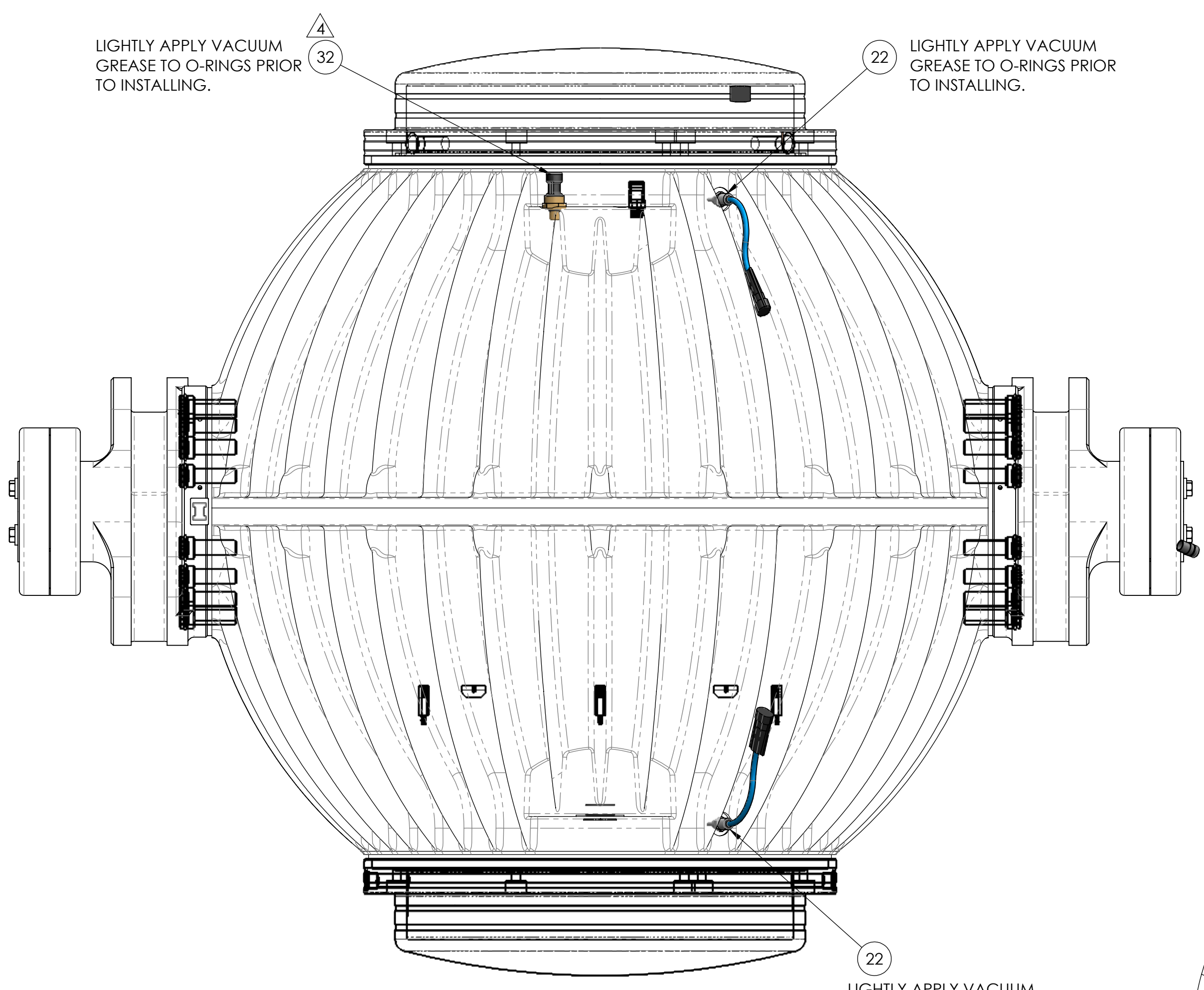

REAR VIEW

LIGHTLY APPLY VACUUM GREASE TO O-RINGS PRIOR TO INSTALLING.

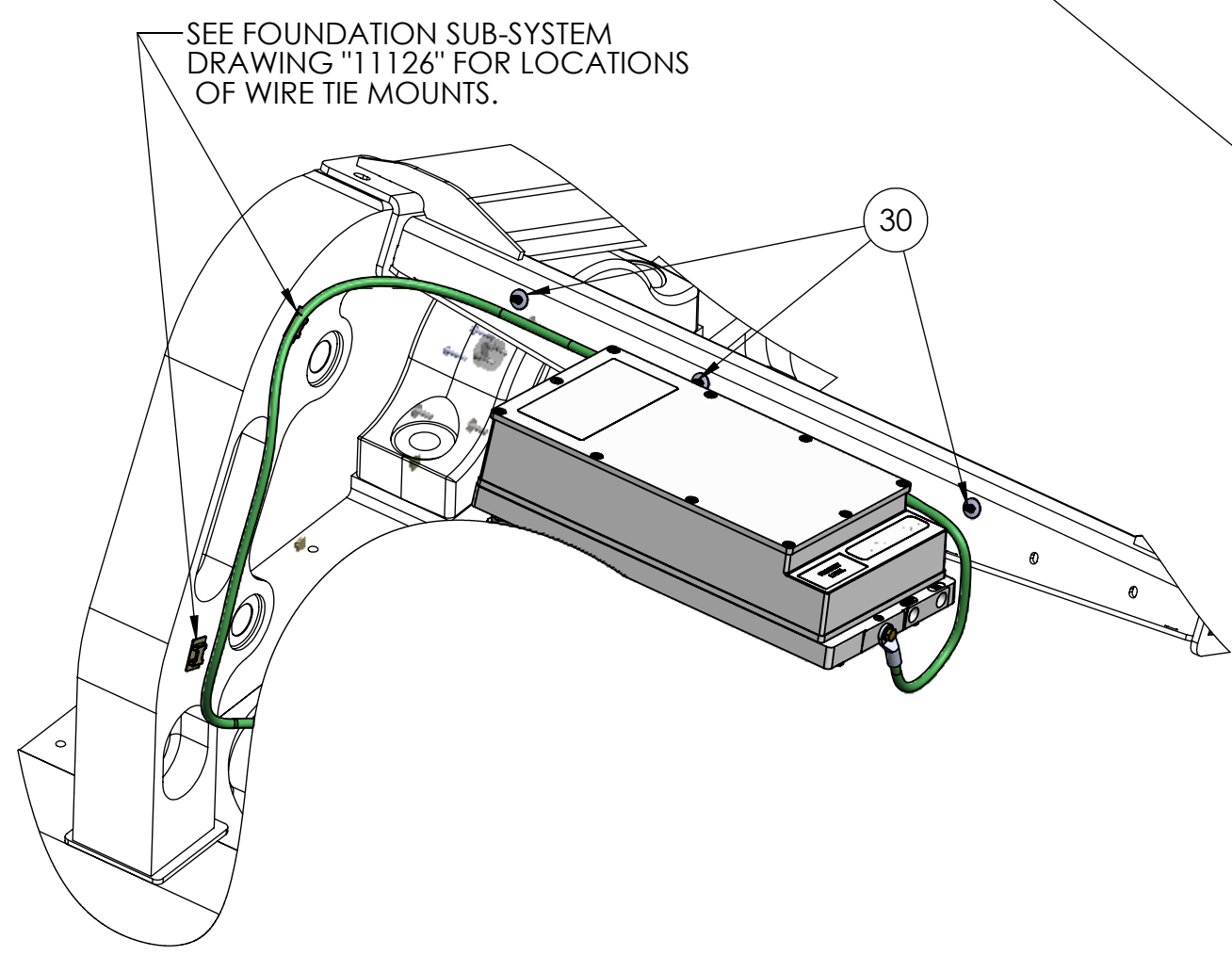

SEE FOUNDATION SUB-SYSTEM DRAWING "11126" FOR LOCATIONS OF WIRE TIE MOUNTS.

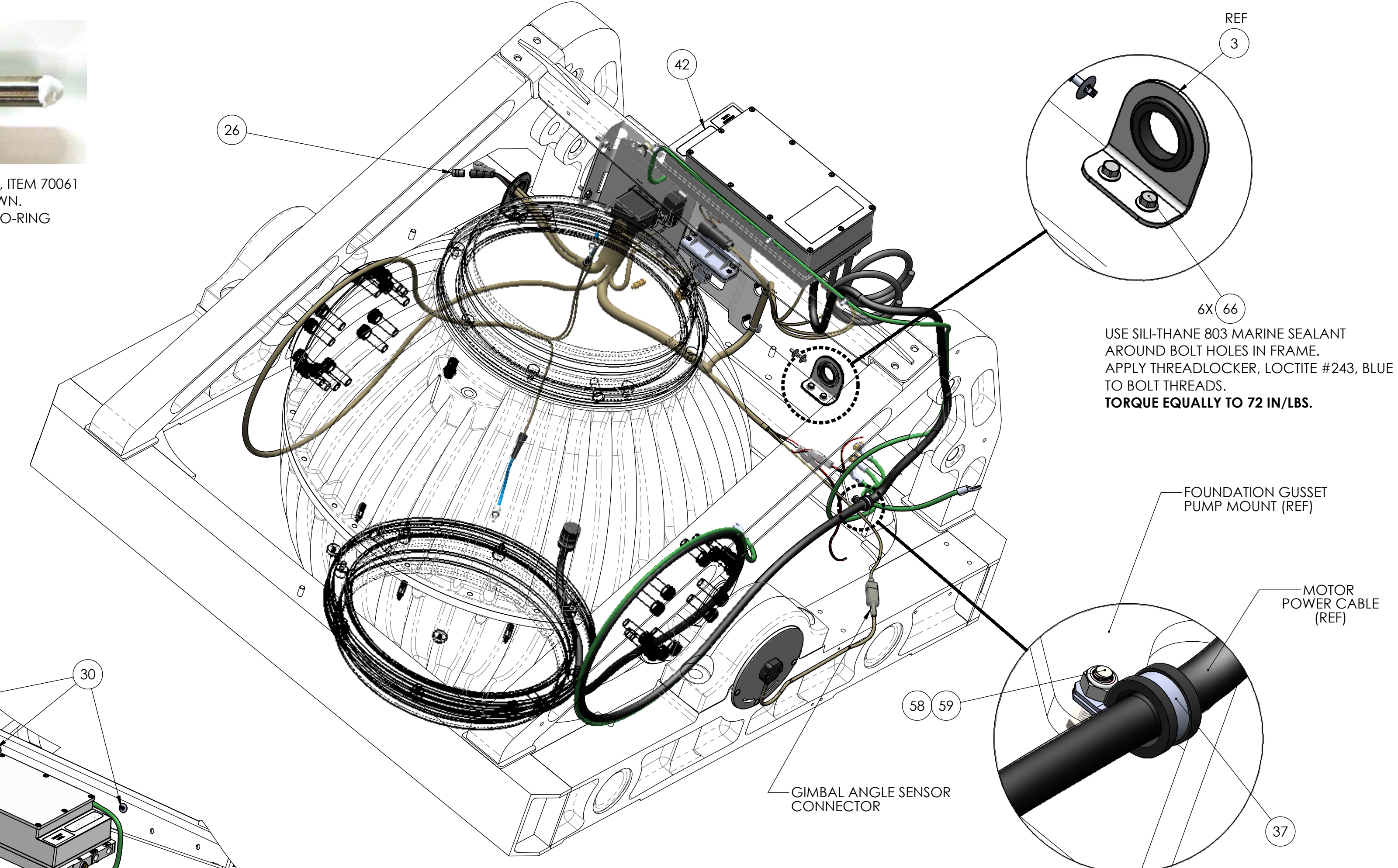

USE SILI-THANE 803 MARINE SEALANT AROUND BOLT HOLES IN FRAME. APPLY THREADLOCKER, LOCTITE #243, BLUE TO BOLT THREADS. TORQUE EQUALLY TO 72 IN/LBS.

FOUNDATION GUSSET PUMP MOUNT (REF)

MOTOR POWER CABLE (REF)

GIMBAL ANGLE SENSOR CONNECTOR

APPLY THREADLOCKER, LOCTITE #243, BLUE TO BOLT THREADS. TORQUE EQUALLY TO 72 IN/LBS.

ECM / IMU MOUNTING DETAILS

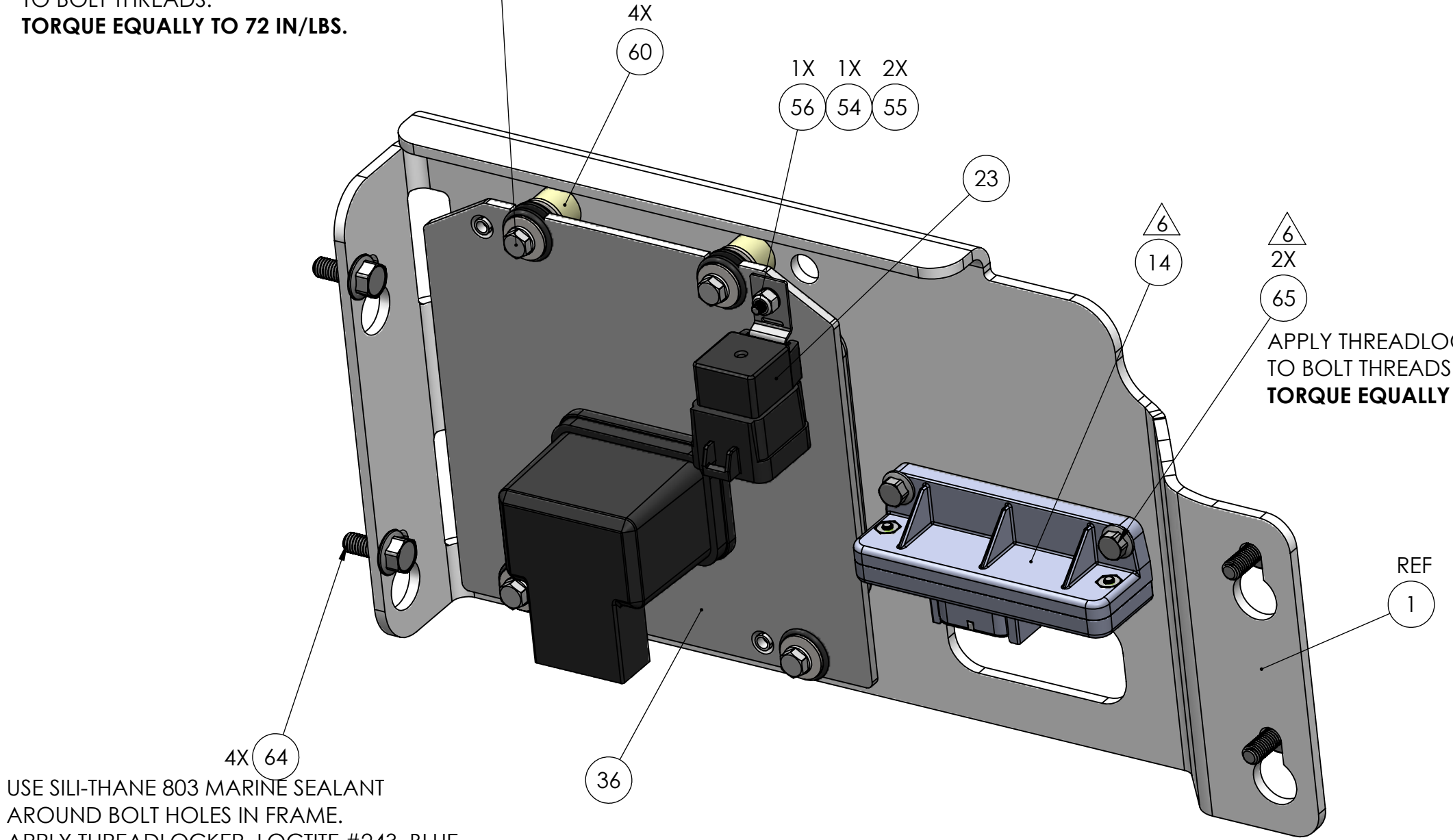

USE SILI-THANE 803 MARINE SEALANT AROUND BOLT HOLES IN FRAME. APPLY THREADLOCKER, LOCTITE #243, BLUE TO BOLT THREADS. TORQUE EQUALLY TO 170 IN/LBS.

APPLY THREADLOCKER, LOCTITE #243, BLUE TO BOLT THREADS. TORQUE EQUALLY TO 72 IN/LBS.

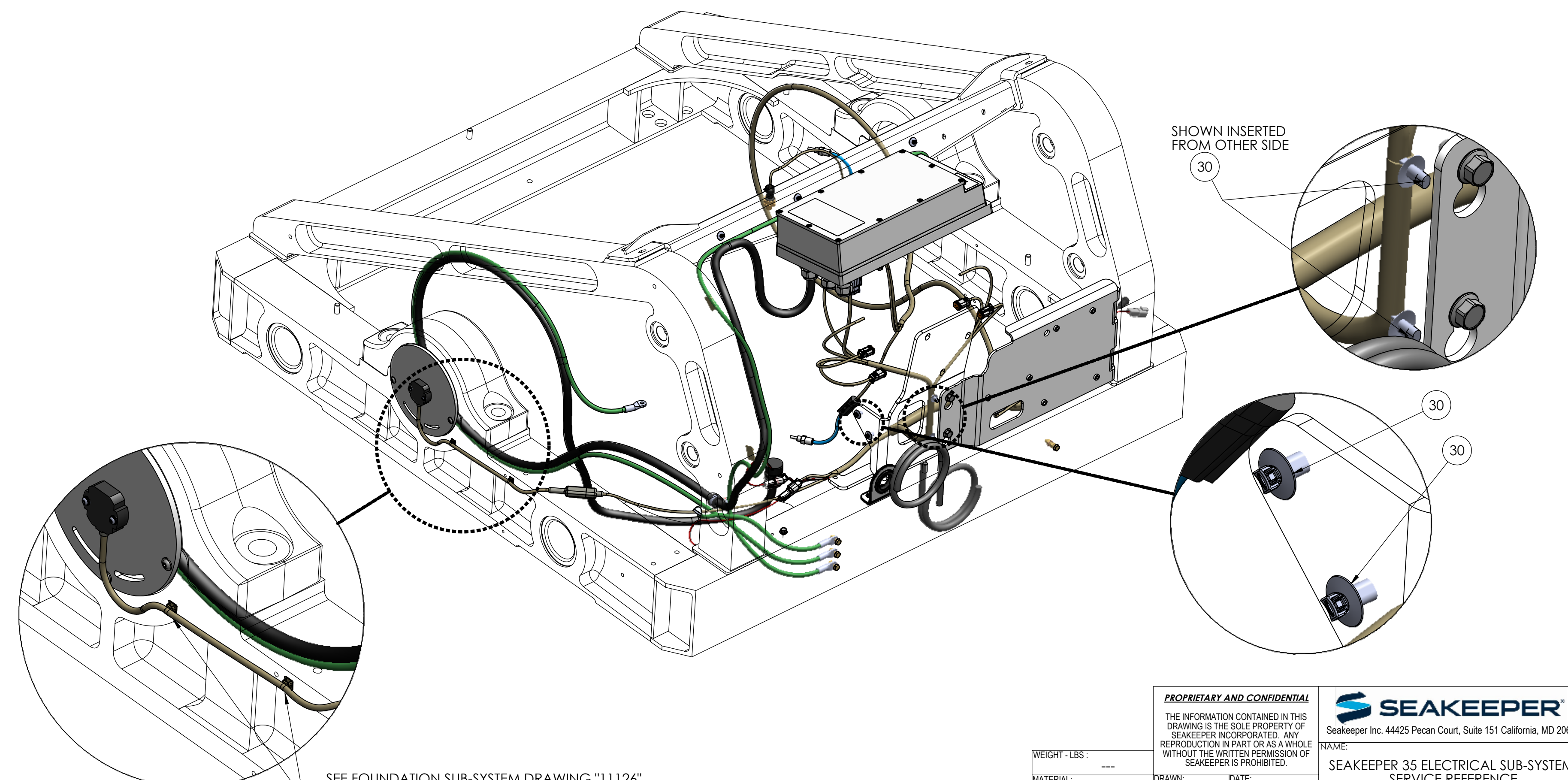

SHOWN INSERTED FROM OTHER SIDE

SEE FOUNDATION SUB-SYSTEM DRAWING "11126" FOR LOCATIONS OF WIRE TIE MOUNTS. THIS VIEW IS FOR ROUTING REFERENCE OF THE GIMBAL ANGLE SENSOR CABLE

SEAKEEPER
Seakeeper Inc. 44425 Pecan Court, Suite 151 California, MD 20619

PROPRIETARY AND CONFIDENTIAL
THE INFORMATION CONTAINED IN THIS DRAWING IS THE SOLE PROPERTY OF SEAKEEPER INCORPORATED. ANY REPRODUCTION IN PART OR AS A WHOLE WITHOUT THE WRITTEN PERMISSION OF SEAKEEPER IS PROHIBITED.

WEIGHT - LBS. ---	DRAWN: PRA	DATE: 05FEB2015	NAME: SEAKEEPER 35 ELECTRICAL SUB-SYSTEM, SERVICE REFERENCE
MATERIAL: SEE BOM	ENG APPR: BRD	DATE: 05FEB2015	DWG NUMBER: 11132-SP
	PROD APPR:		REV. NO. SHEET NO. 8 2 OF 2