

ITEMS NOT SHOWN TO SCALE, SOME ITEMS MAY APPEAR LARGER THAN NORMAL

REV NO.	ECN NO.	ZONE	DESCRIPTION	DATE	APPRVD.
2	742		SHIPPING CRATE CHANGE	6/21/2019	BRD

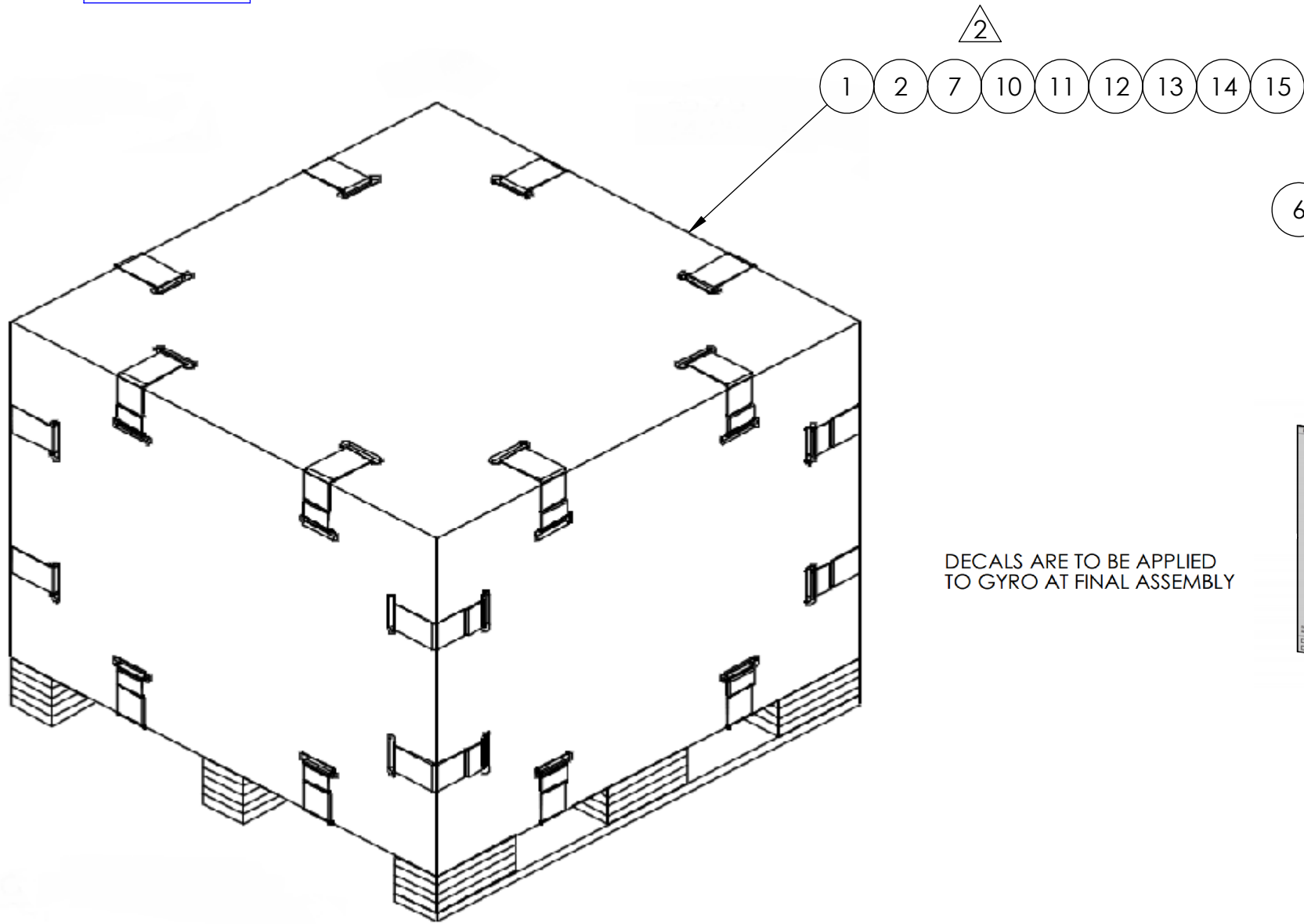

DECALS ARE TO BE APPLIED TO GYRO AT FINAL ASSEMBLY

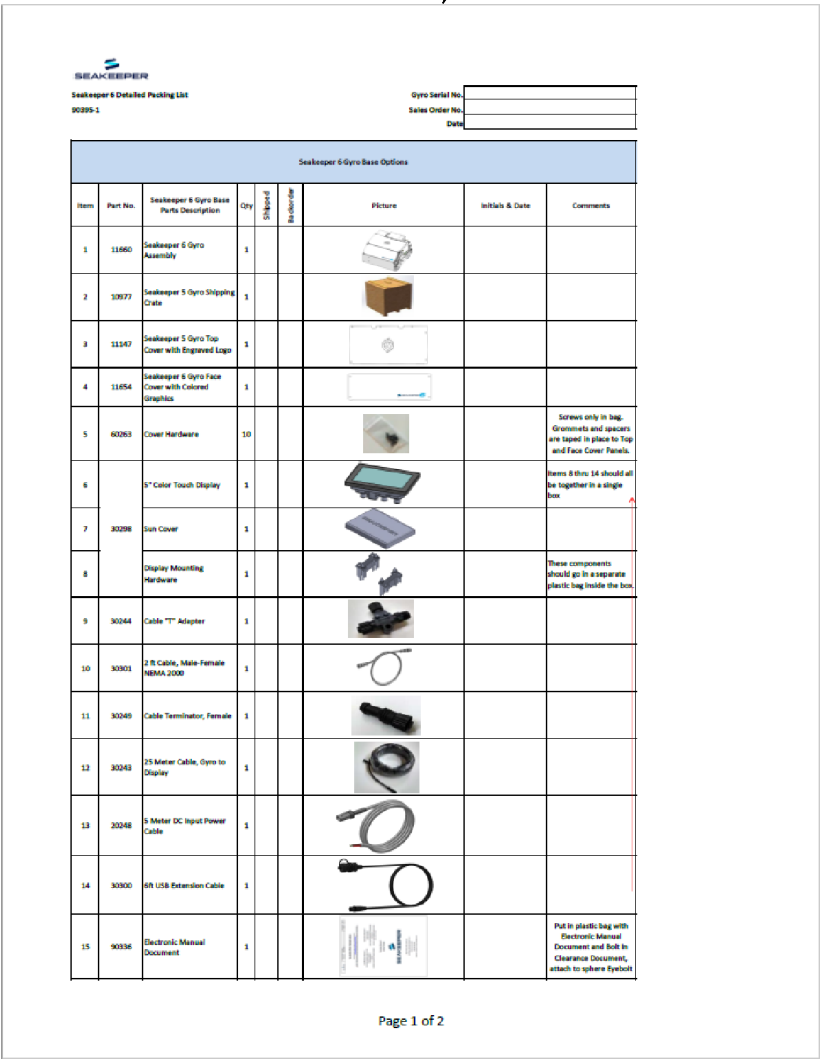
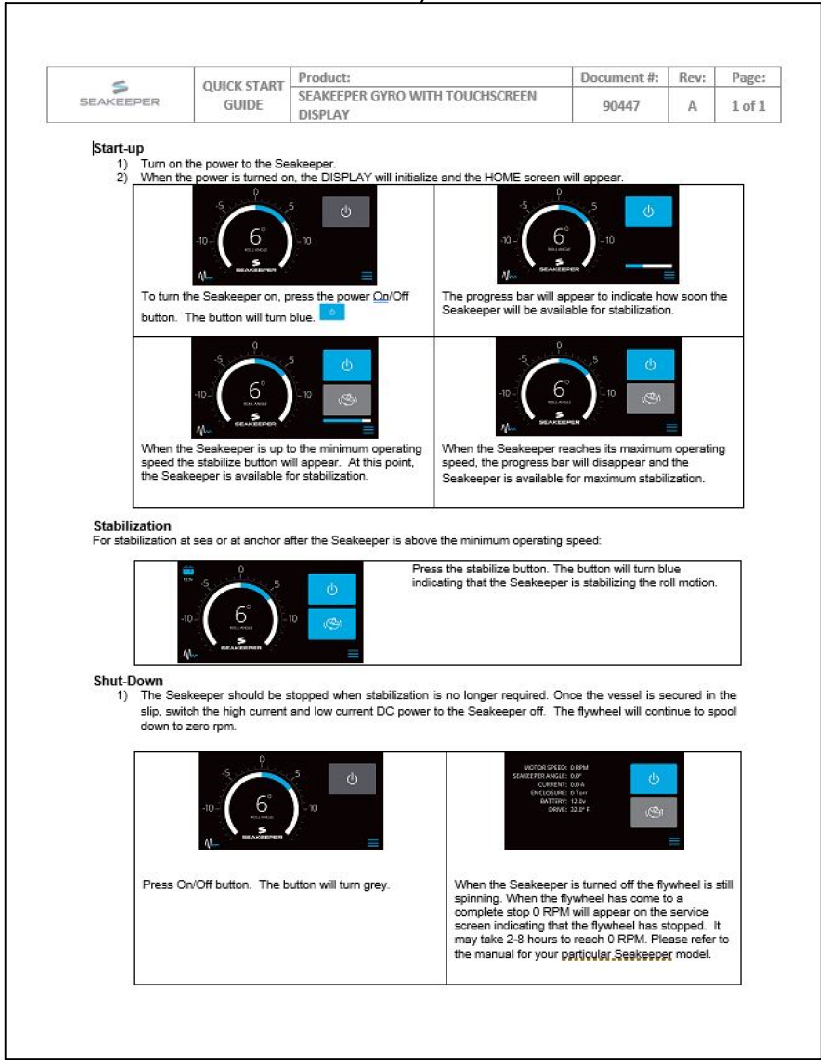
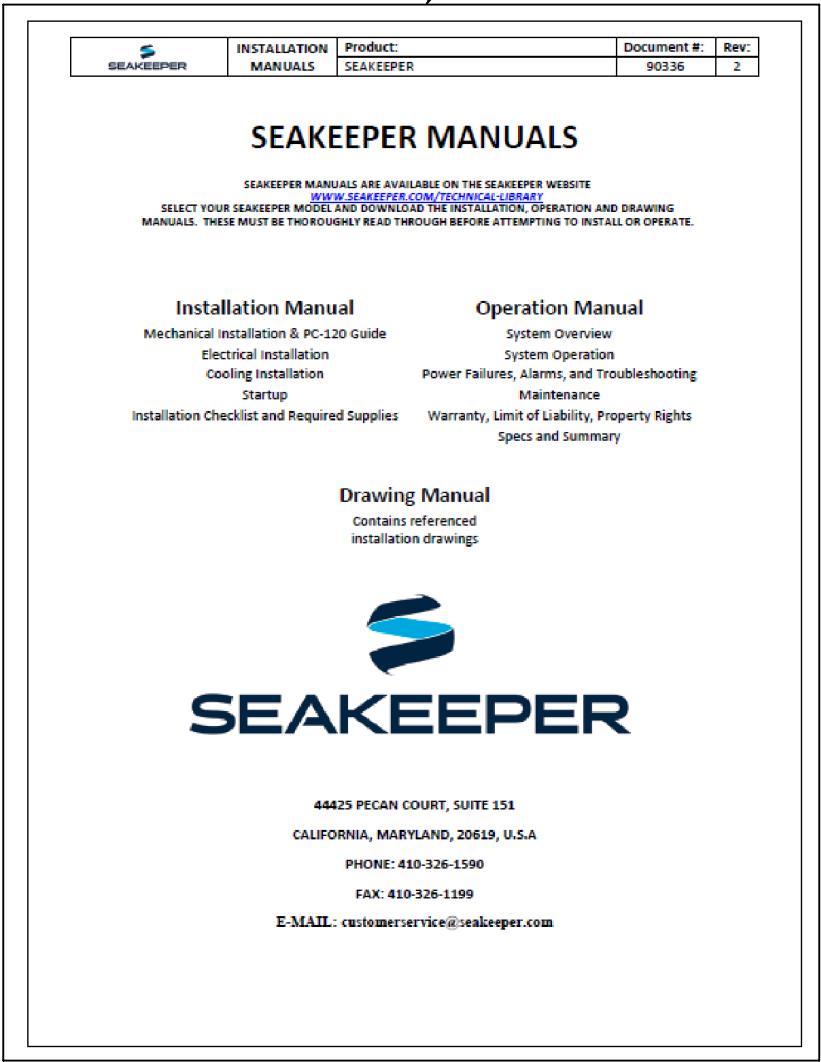
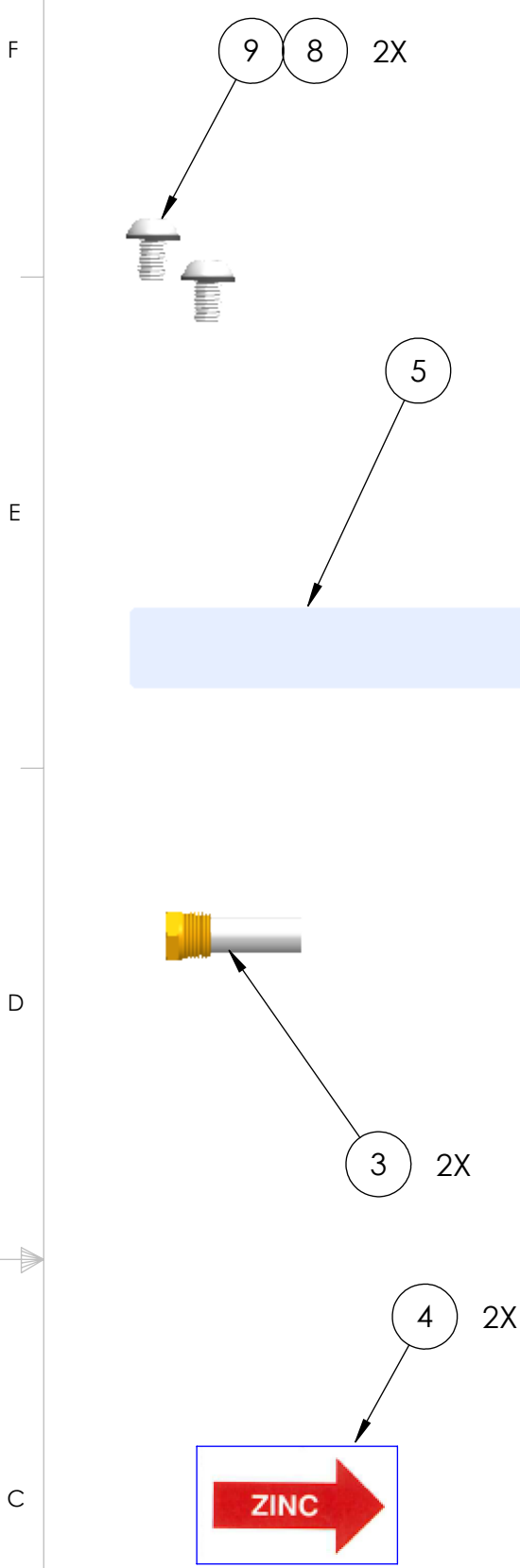

ITEM NO.	PART NO.	DESCRIPTION	QTY.	NOTE
18	90447	TOUCHSCREEN QUICK START GUIDE	1	
17	90395	SK6 PACKING LIST	1	
16	90336	SEAKEEPER ELECTRONIC MANUAL DOCUMENT	1	
15	60651	SCREW, HEX HD CAP, 3/8-16 X 3.75" LG, GR 5	2	
14	60650	FLAT WASHER, 3/8" SCREW SIZE	4	
13	60649	HEX NUT, NYLOCK, 3/8-16, GR 5	2	
12	60638	1/2" LAG SCREW, 6" LONG	4	
11	60636	1/2" LAG SCREW, 3" LONG	4	
10	60635	1/2" FLAT WASHER, NYLON	10	
9	60485	SCREW, BUTTON HD SKT CAP, M10-1.5 X 16MM LG	2	
8	60484	WASHER, FLAT, .75OD X .375ID X .062THK	2	
7	60359	1/2" FLAT WASHER, STEEL	12	
6	40513	SK6 DECAL SHEET	1	
5	40512	SK6 SERIAL PLATE	1	
4	40481	ZINC ANODE DECAL	2	
3	40446	ZINC ANODE, 3/8" NPT PLUG, 1/2" DIA X 1.25" LG	2	SPARES
2	12134	SK6 SHIPPING CRATE COMPONENTS	1	WOOD & FOAM
1	12131	SK6/9 COLLAPSIBLE SHIPPING CRATE	1	

WEIGHT - LBS : ---		MATERIAL: ---		DRAWN: WHK DATE: 14SEP2016		ENG APPR: DATE:		PROD APPR: DATE:		PROPRIETARY AND CONFIDENTIAL THE INFORMATION CONTAINED IN THIS DRAWING IS THE SOLE PROPERTY OF SEAKEEPER INCORPORATED. ANY REPRODUCTION IN PART OR AS A WHOLE WITHOUT THE WRITTEN PERMISSION OF SEAKEEPER IS PROHIBITED.		SEAKEEPER® 45310 ABELL HOUSE LANE, SUITE 350, CALIFORNIA, MD 20619 NAME: SK6/5 OTHER SUB-SYSTEM, SERVICE REFERENCE		DWG NUMBER 11675-SP		REV. NO. 2 SHEET NO. 1 OF 1	
--------------------	--	---------------	--	----------------------------	--	-----------------	--	------------------	--	---	--	--	--	---------------------	--	-----------------------------	--