

NOTES:

- 1) THIS DWG. REPRESENTS A SUB-GROUP OF COMPONENTS WITHIN THE NG9 COOLING SYSTEM BILL OF MATERIAL AND DOES NOT NECESSARILY REPRESENT THE ACTUAL ASSEMBLY PROCEDURE. THIS DWG DOES PROVIDE TECHNICAL INFORMATION REGARDING COMPONENT LOCATION, SUGGESTED HOSE ROUTING, AND FASTENER APPLICATION.
- 2) USE TEFLON PIPE THREAD SEALANT ON ALL TAPERED PIPE THREAD FITTINGS. DO NOT USE TEFLON TAPE.

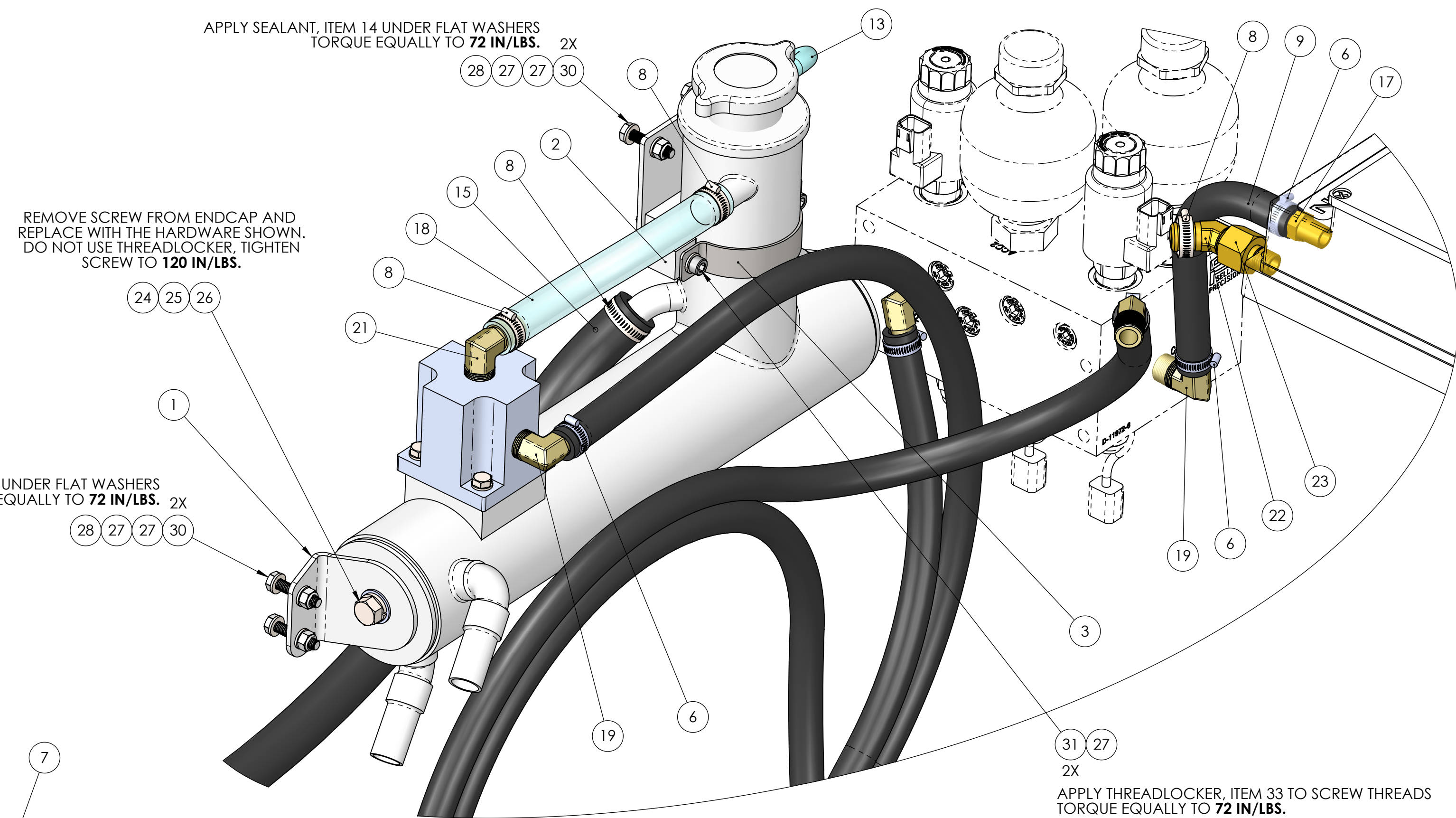
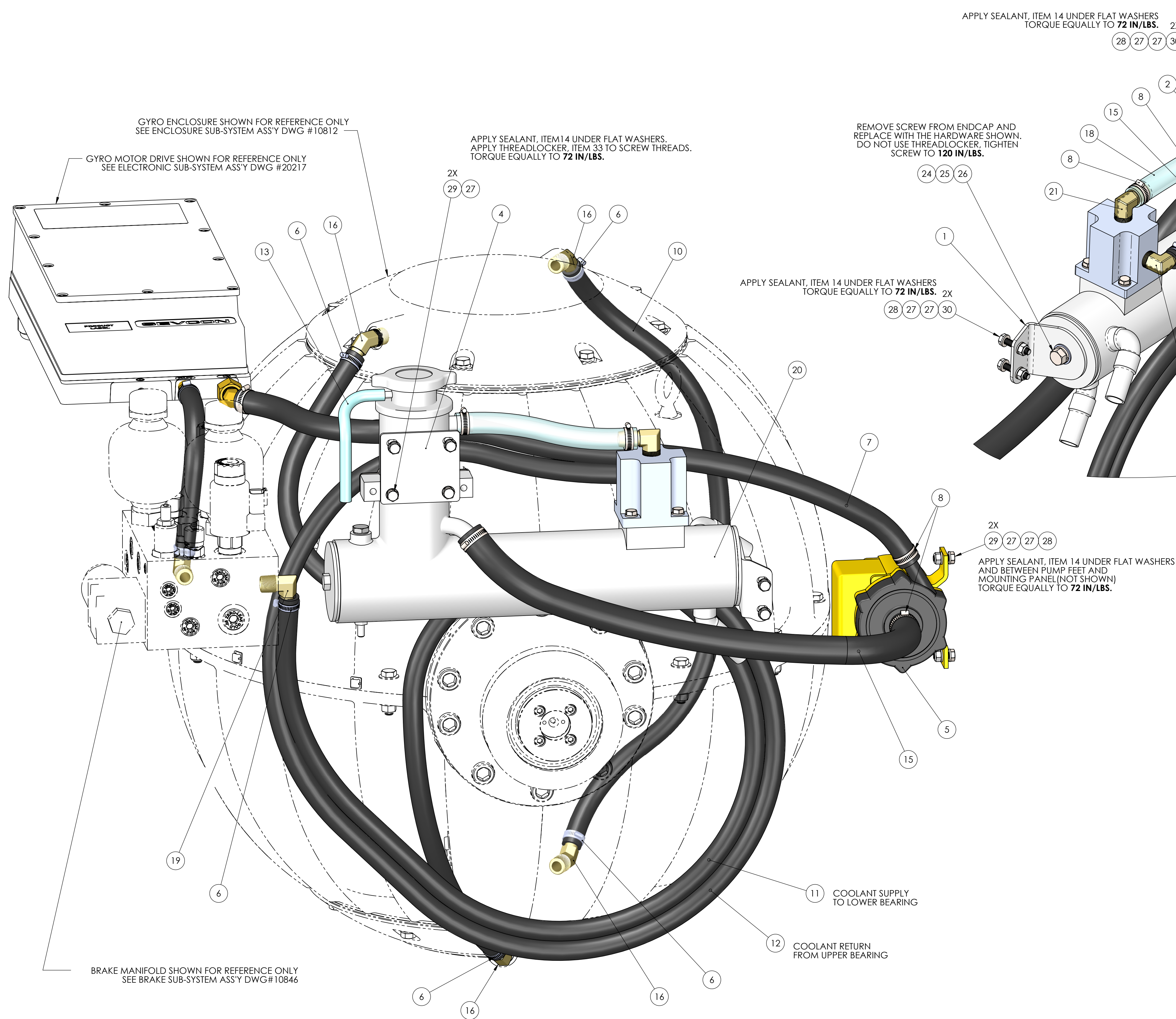

33	70054	THREADLOCKER, LOCTITE #243 BLUE	---	AR	
32	70010	THREAD SEALANT, PTFE	---	AR	2
31	60285	SOCKET HEAD CAP SCREW M6-1.0 X 16mm LG	316 SS	2	
30	60262	HHCS M6-1.0 X 30mm LG	316 SS	4	
29	60256	HHCS M6-1.0 X 16mm LG	316 SS	4	
28	60255	HEX NUT, NYLOK M6-1.0	316 SS	6	
27	60223	FLAT WASHER M6 SCREW SIZE	316 SS	16	
26	60186	HEX HD CAP SCREW, 3/8-16 X 1" LG	18-8 SS	1	
25	60141	SPRING LOCK WASHER, 3/8	18-8 SS	1	
24	60140	FLAT WASHER, 3/8 X 7/8 OD	18-8 SS	1	
23	40365	ADAPTOR, 3/8" NPT FEMALE X 1/4" NPT MALE	BRASS	1	
22	40364	45 DEG ELBOW, 5/8" HOSE BARB X 3/8" NPT MALE	BRASS	1	
21	40340	ELBOW, 90 DEG BARBED FTG. 5/8" HOSE ID X 3/8" NPT MALE	BRASS	1	2
20	40337	NG9 HEAT EXCHANGER WITH INTEGRATED THERMOSTAT		1	
19	40298	ELBOW, 90 DEG BARBED FTG. 1/2" HOSE ID X 3/8" NPT MALE	BRASS	3	2
18	40273	5/8" CLEAR PVC PUSH-ON HOSE X 7" LG.	CLEAR PVC	7"	
17	40262	HOSE BARB ADAPTER, 1/2" HOSE ID X 1/4" NPTF MALE PIPE	BRASS	1	
16	40257	ELBOW, 45 DEG BARBED FTG 1/2" HOSE ID X 3/8" NPT MALE	BRASS	4	2
15	40255	5/8" PUSH-ON SUCTION HOSE X 21" LG.	BLK RUBBER	21"	
14	40250	SILI-THANE B03 MARINE SEALANT	---	AR	
13	40235	HOSE, 5/16 INCH PUSH-ON, BRAKE MANIFOLD OVERFLOW	CLEAR PVC	48"	
12	40223	HOSE, 1/2" PUSH-ON X 86-1/2" LG	BLK RUBBER	86.5"	
11	40223	HOSE, 1/2" PUSH-ON X 65" LG.	BLK RUBBER	65"	
10	40223	HOSE, 1/2" PUSH-ON X 28-1/2" LG.	BLK RUBBER	28"	
9	40223	HOSE, 1/2" PUSH-ON X 8" LG.	BLK RUBBER	8"	
8	40210	HOSE CLAMP, SIZE 10	316 SS	6	
7	40199	HOSE, 5/8" PUSH-ON X 31" LG.	BLK RUBBER	31"	
6	40026	HOSE CLAMP, SIZE 06	SS	8	
5	20229	NG9 GYRO 24V COOLING PUMP AND CONNECTOR ASSY	---	1	
4	10900	NG8 HEAT EXCHANGER REAR MOUNT PLATE	5052 ALUM. SHEET		
3	10872	NG8 HEAT EXCHANGER TOP CLAMP STRAP	304 SS	1	
2	10871	NG8 HEAT EXCHANGER TOP CLAMP BLOCK	ALUMINUM BAR	1	
1	10870	NG8 HEAT EXCHANGER FORWARD BRACKET	5052 ALUM. SHT.	1	
ITEM NO.	PART NO.	DESCRIPTION	MATERIAL	QTY.	NOTE