

NOTES:

- 1) THIS DWG. REPRESENTS A SUB-GROUP OF COMPONENTS WITHIN THE NG9 COOLING SYSTEM BILL OF MATERIAL AND DOES NOT NECESSARILY REPRESENT THE ACTUAL ASSEMBLY PROCEDURE. THIS DWG DOES PROVIDE TECHNICAL INFORMATION REGARDING COMPONENT LOCATION, SUGGESTED HOSE ROUTING, AND FASTNER APPLICATION.
- 2) USE TEFLON PIPE THREAD SEALANT ON ALL TAPERED PIPE THREAD FITTINGS, DO NOT USE TEFLON TAPE.

REV.	ECH NO.	ZONE	DESCRIPTION	DATE	APPROVED
1	0174		RELEASED FOR PRODUCTION	3/13/2014	RSK
2	0223		COOLANT PUMP REPLACED WITH NEW BRAND, ITEM 11 WAS 5/8" HOSE.	3/16/2015	RSK

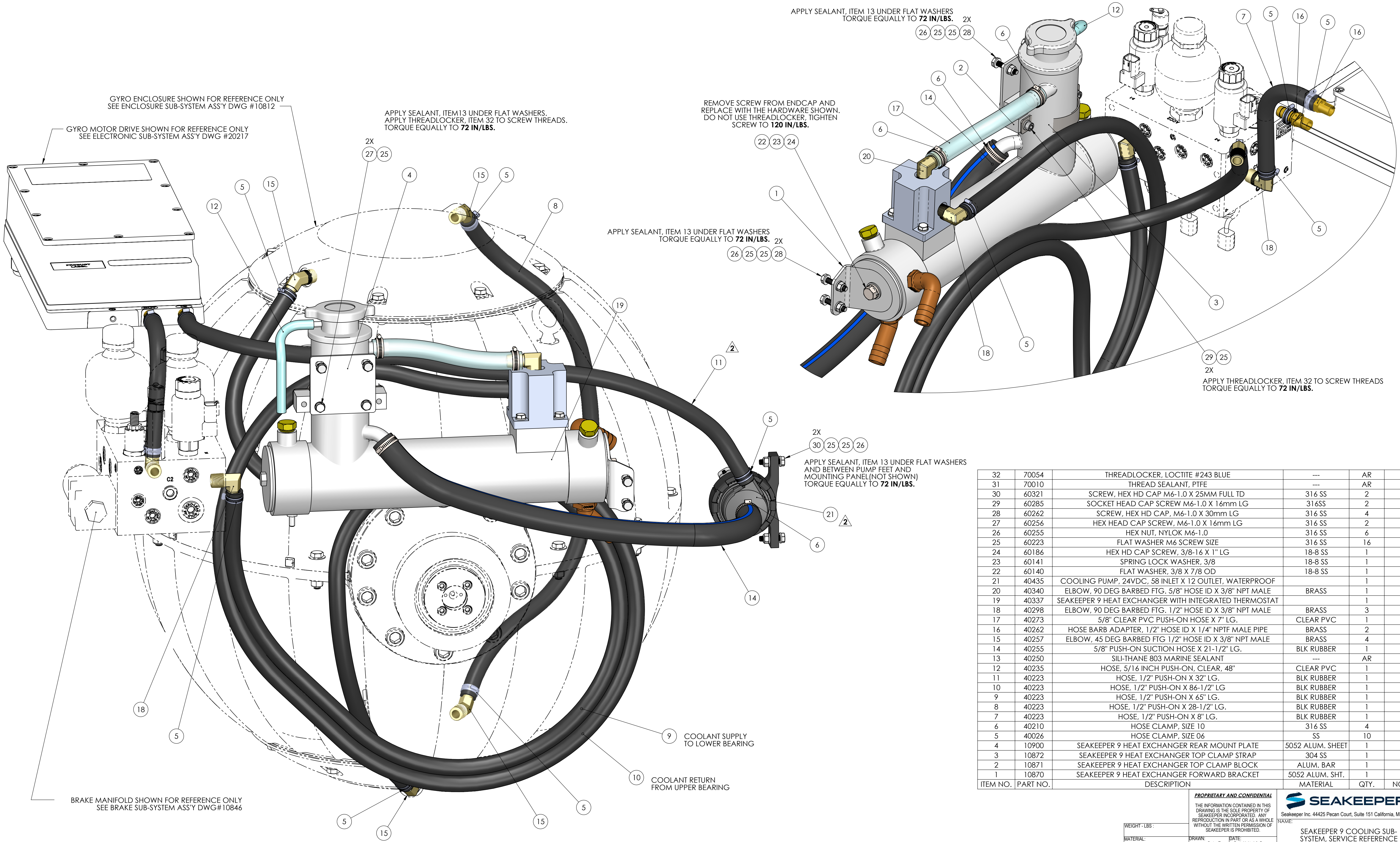

32	70054	THREADLOCKER, LOCTITE #243 BLUE	---	AR	
31	70010	THREAD SEALANT, PTFE	---	AR	2
30	60321	SCREW, HEX HD CAP M6-1.0 X 25MM FULL TD	316 SS	2	
29	60285	SOCKET HEAD CAP SCREW M6-1.0 X 16mm LG	316SS	2	
28	60262	SCREW, HEX HD CAP, M6-1.0 X 30mm LG	316 SS	4	
27	60256	HEX HEAD CAP SCREW, M6-1.0 X 16mm LG	316 SS	2	
26	60255	HEX NUT, NYLOK M6-1.0	316 SS	6	
25	60223	FLAT WASHER M6 SCREW SIZE	316 SS	16	
24	60186	HEX HD CAP SCREW, 3/8-16 X 1" LG	18-8 SS	1	
23	60141	SPRING LOCK WASHER, 3/8	18-8 SS	1	
22	60140	FLAT WASHER, 3/8 X 7/8 OD	18-8 SS	1	
21	40435	COOLING PUMP, 24VDC, 58 INLET X 12 OUTLET, WATERPROOF		1	
20	40340	ELBOW, 90 DEG BARBED FTG, 5/8" HOSE ID X 3/8" NPT MALE	BRASS	1	
19	40337	SEAKEEPER 9 HEAT EXCHANGER WITH INTEGRATED THERMOSTAT		1	
18	40298	ELBOW, 90 DEG BARBED FTG, 1/2" HOSE ID X 3/8" NPT MALE	BRASS	3	
17	40273	5/8" CLEAR PVC PUSH-ON HOSE X 7" LG.	CLEAR PVC	1	
16	40262	HOSE BARB ADAPTER, 1/2" HOSE ID X 1/4" NPTF MALE PIPE	BRASS	2	
15	40257	ELBOW, 45 DEG BARBED FTG 1/2" HOSE ID X 3/8" NPT MALE	BRASS	4	
14	40255	5/8" PUSH-ON SUCTION HOSE X 21-1/2" LG.	BLK RUBBER	1	
13	40250	SILI-THANE 803 MARINE SEALANT	---	AR	
12	40235	HOSE, 5/16 INCH PUSH-ON, CLEAR, 48"	CLEAR PVC	1	
11	40223	HOSE, 1/2" PUSH-ON X 32" LG.	BLK RUBBER	1	
10	40223	HOSE, 1/2" PUSH-ON X 86-1/2" LG	BLK RUBBER	1	
9	40223	HOSE, 1/2" PUSH-ON X 65" LG.	BLK RUBBER	1	
8	40223	HOSE, 1/2" PUSH-ON X 28-1/2" LG.	BLK RUBBER	1	
7	40223	HOSE, 1/2" PUSH-ON X 8" LG.	BLK RUBBER	1	
6	40210	HOSE CLAMP, SIZE 10	316 SS	4	
5	40026	HOSE CLAMP, SIZE 06	SS	10	
4	10900	SEAKEEPER 9 HEAT EXCHANGER REAR MOUNT PLATE	5052 ALUM. SHEET	1	
3	10872	SEAKEEPER 9 HEAT EXCHANGER TOP CLAMP STRAP	304 SS	1	
2	10871	SEAKEEPER 9 HEAT EXCHANGER TOP CLAMP BLOCK	ALUM. BAR	1	
1	10870	SEAKEEPER 9 HEAT EXCHANGER FORWARD BRACKET	5052 ALUM. SHT.	1	
ITEM NO.	PART NO.	DESCRIPTION	MATERIAL	QTY.	NOTE

PROPRIETARY AND CONFIDENTIAL

THE INFORMATION CONTAINED IN THIS
DRAWING IS THE SOLE PROPERTY OF
SEAKEEPER INCORPORATED. ANY
REPRODUCTION IN PART OR AS A WHOLE
WITHOUT THE WRITTEN PERMISSION OF
SEAKEEPER IS PROHIBITED.



Seakeeper Inc. 44425 Pecan Court, Suite 151 California, MD 20619

SEAKEEPER 9 COOLING SUB-
SYSTEM, SERVICE REFERENCE

DWG NUMBER

10847-SP

REV. NO. SHEET NO.

2

1 OF 1