

NOTES:

- 1) PRESSURE SWITCHES ARE TO BE SET AT 72 PSI FALLING, +/- 2 PSI.
2) REPLACEMENT COIL FOR ITEM 11 - SEAKEEPER #50156
3) APPLY THREAD SEALANT TO THREADS OF ITEM 1 PRIOR TO ASSEMBLY.

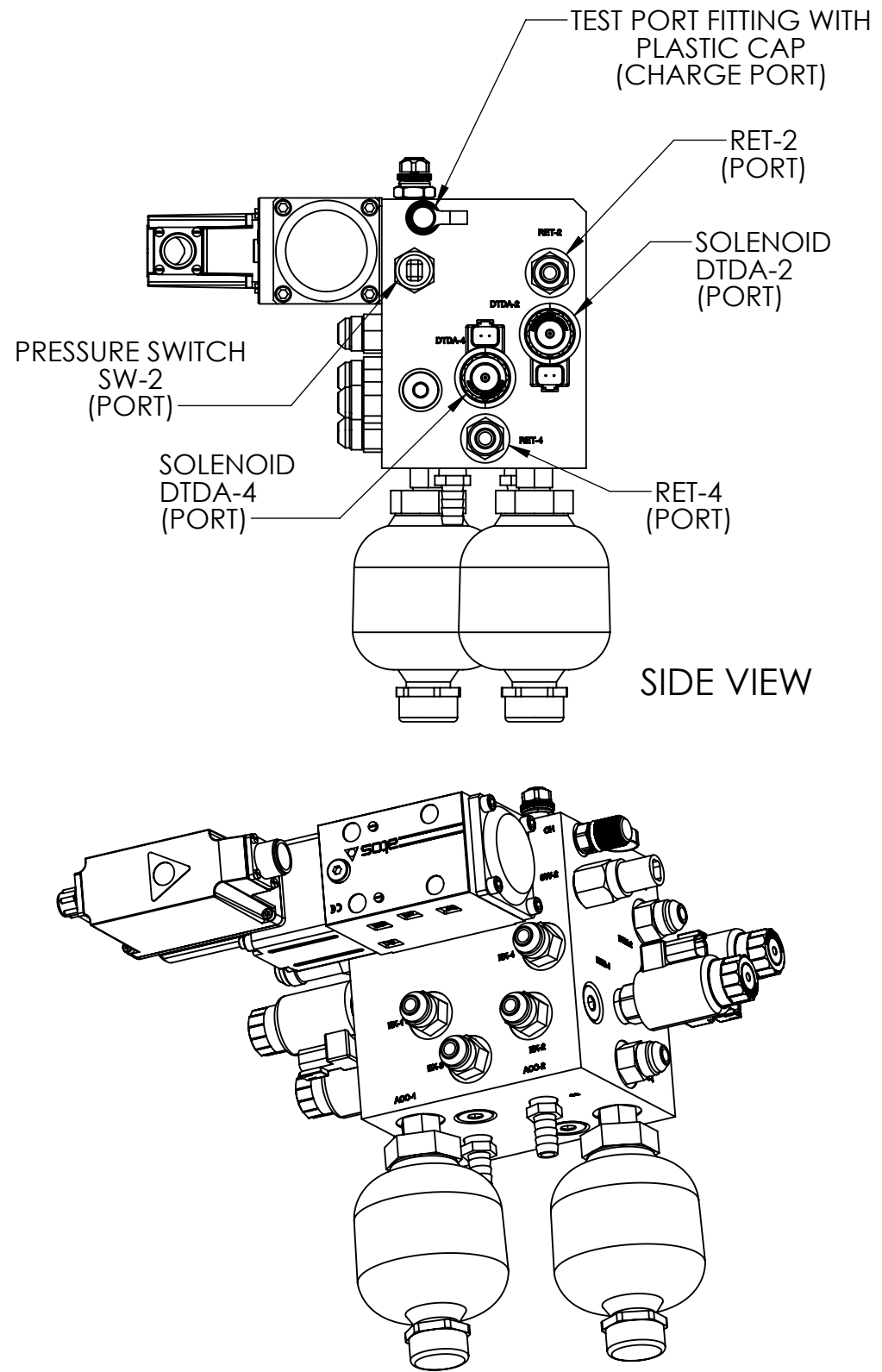
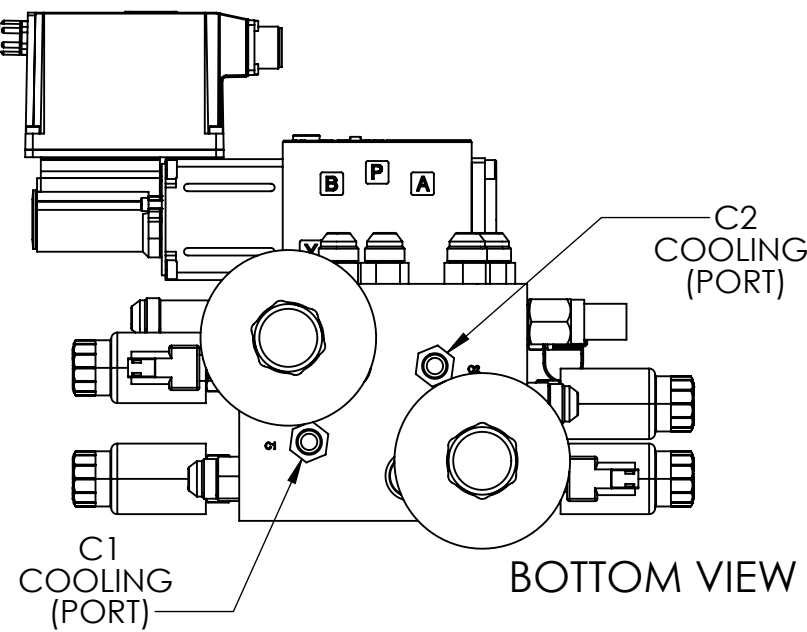
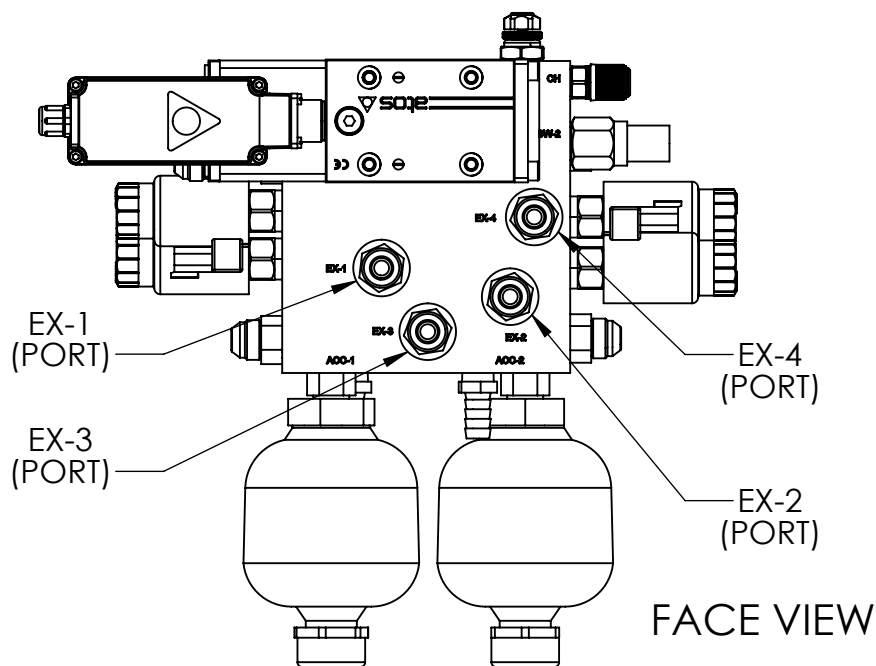
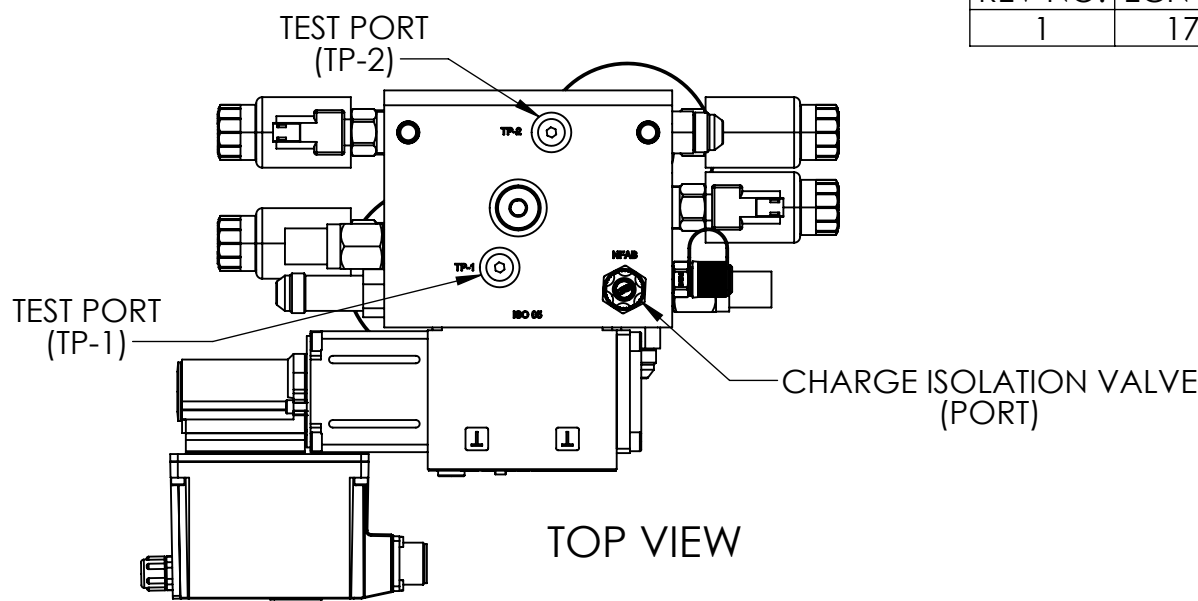
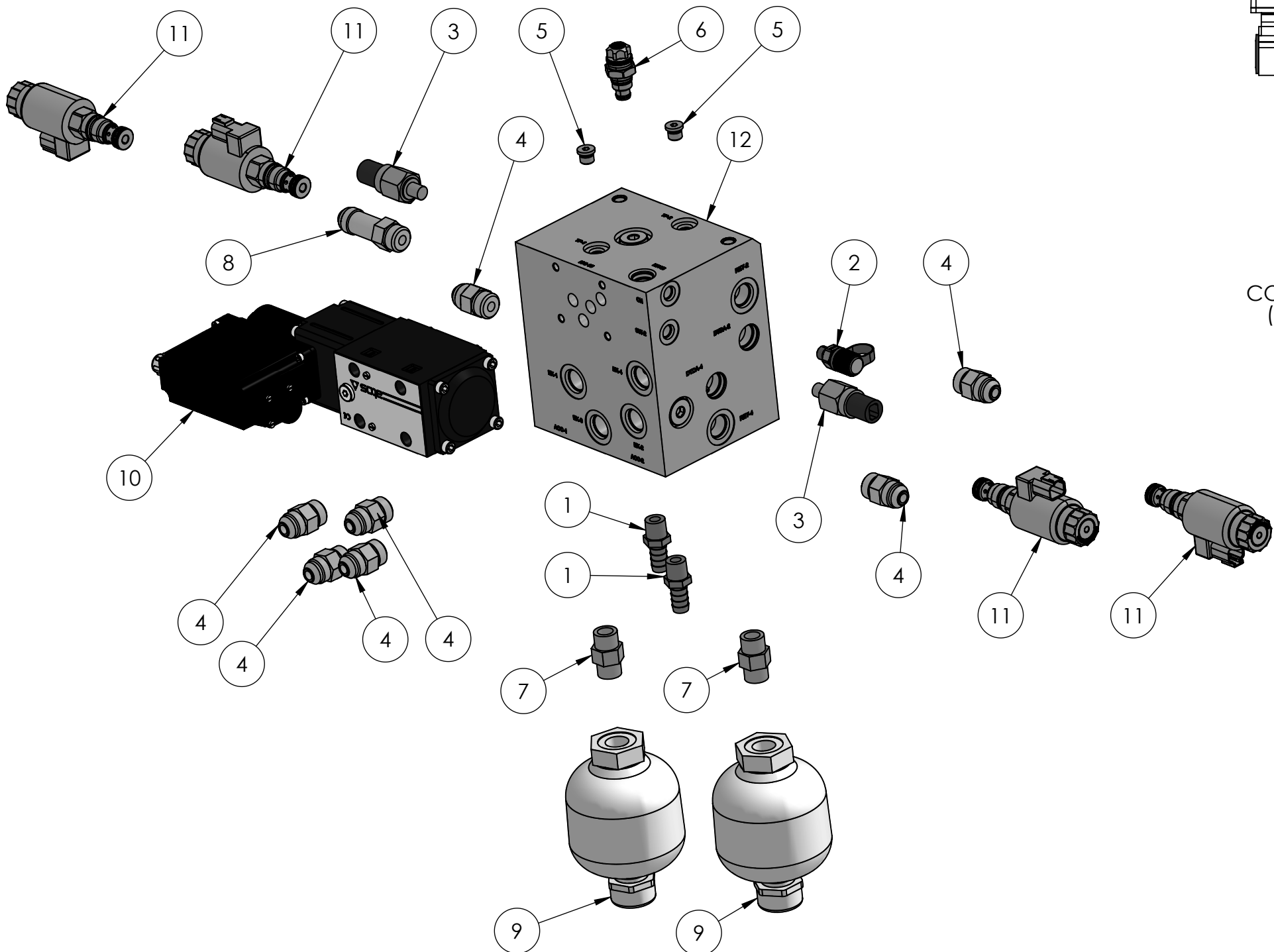
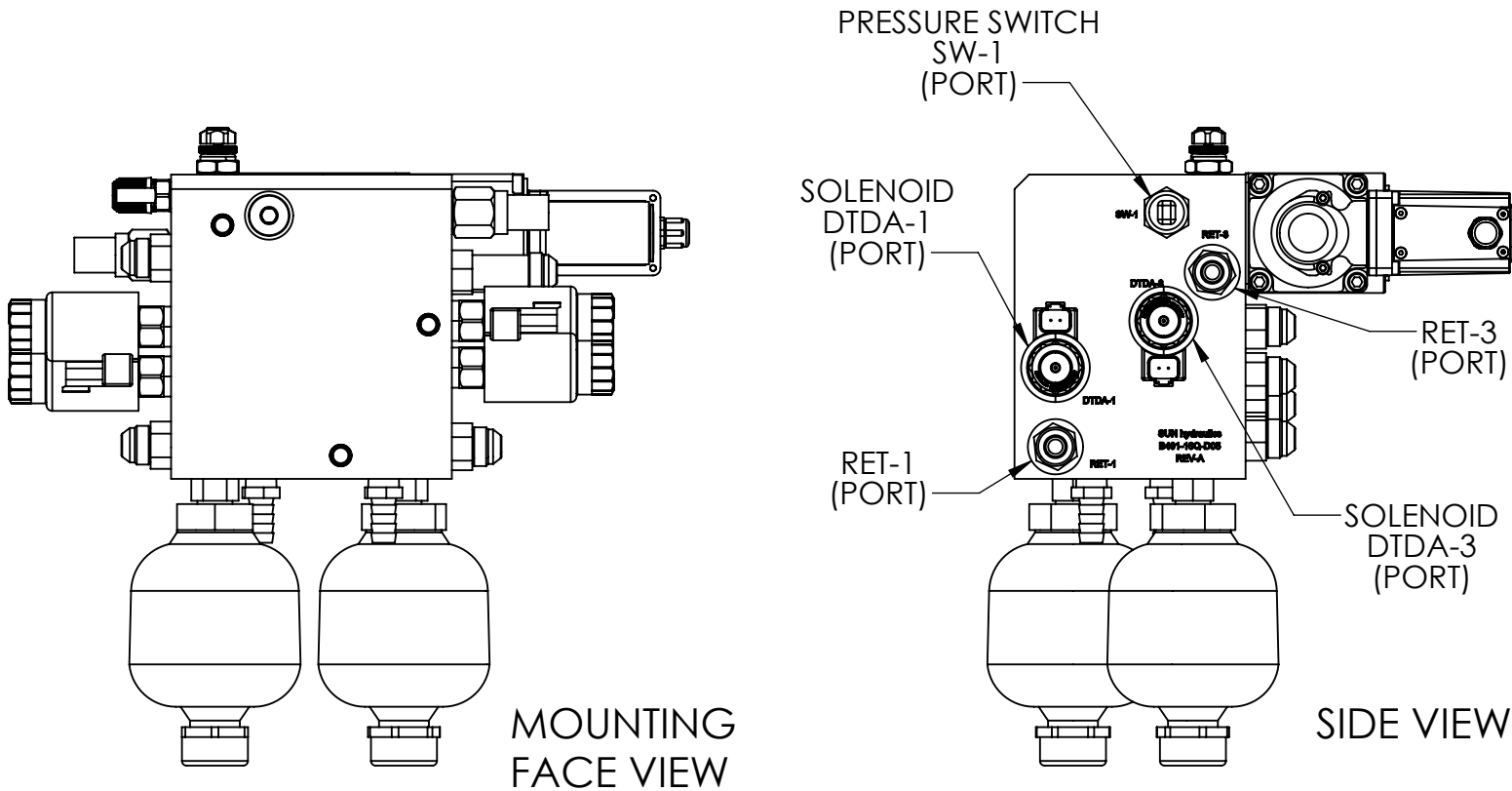

12	50168	BRAKE MANIFOLD BLOCK	6061 ALUMINUM	1	
11	50118	SOLENOID VALVE, 24VDC NORMALLY CLOSED	---	4	
10	50091	PROPORTIONAL VALVE, D05, WITH DIGITAL OBE	---	1	
9	50086	ACCUMULATOR, 20 CU IN, -8 SAE ORB PORT	---	2	
8	50081	ADAPTOR, LONG, -8 SAE ORB TO -8 JIC MALE STRT	ZINC PLTD STEEL	1	
7	50167	-8 SAE ORB ADAPTER FITTING, ORIFICE WITH FREE FLOW CHECK		2	
6	50055	CHARGE ISOLATION VALVE	---	1	
5	50027	PLUG, HOLLOW HEX, -4 SAE ORB	-	2	
4	50008	ADAPTOR, MALE, STRAIGHT	STEEL	7	
3	50166	PRESSURE SWITCH, DEUTSCH CONNECTOR, 72 PSI SETPOINT	---	2	
2	50006	TEST PORT FITTING W/PLASTIC CAP	STEEL	1	
1	40299	HOSE BARB ADAPTER, 1/2" HOSE ID X 3/8" NPTF MALE	BRASS	2	
ITEM NO.	PART NO.	DESCRIPTION	MATERIAL	QTY.	NOTE

WEIGHT - LBS : 42.8

MATERIAL: ---

PROPRIETARY AND CONFIDENTIAL

THE INFORMATION CONTAINED IN THIS DRAWING IS THE SOLE PROPERTY OF SEAKEEPER INCORPORATED. ANY REPRODUCTION IN PART OR AS A WHOLE WITHOUT THE WRITTEN PERMISSION OF SEAKEEPER IS PROHIBITED.

DRAWN: PRA
ENG APPR: BRD
PROD APPR:

DATE: 07APR2015
DATE: 07APR2015
DATE:

SEAKEEPER
Seakeeper Inc. 44425 Pecan Court, Suite 151 California, MD 20619

NAME: SEAKEEPER 35-26, BRAKE MANIFOLD, SERVICE REFERENCE

DWG NUMBER: 11067-SP

REV. NO. 1
SHEET NO. 1 OF 1