

NOTES:

- 1) THIS DWG. REPRESENTS A SUB-GROUP OF COMPONENTS WITHIN THE NG9 ELECTRONICS SYSTEM BILL OF MATERIAL AND DOES NOT NECESSARILY REPRESENT THE ACTUAL ASSEMBLY PROCEDURE. THIS DWG DOES PROVIDE TECHNICAL INFORMATION REGARDING COMPONENT LOCATION, SUGGESTED WIRE HARNESS ROUTING, AND FASTENER APPLICATION.
- 2) ITEMS SHOWN IN PHANTOM ARE FOR REFERENCE ONLY. THESE REFERENCE ITEMS ARE PART OF OTHER SUB-GROUPS AND ARE DISPLAYED IN THIS DWG TO SHOW WIRE HARNESS CONNECTION POINTS.

REV.	ECN NO.	ZONE	DESCRIPTION	DATE	APPROVED
1	0174		RELEASED FOR PRODUCTION	3/6/2014	RSK
2	0204		ADDED ITEM 18 TO BILL OF MATERIAL	7/23/2014	RSK

69	70061	THERMAL JOINT COMPOUND - WAKEFIELD TYPE 120	---	AR	
68	70054	THREAD LOCKER, LOCTITE #243, BLUE	---	AR	
67	60278	HEX HD CAP SCREW,M6-1.0 X 16mm LG, FULL THREAD	BRASS	5	-
66	60276	INTERNAL TOOTH LOCK WASHER, 5/16" SCREW SIZE	BRONZE	1	-
65	60260	STAND-OFF, NYLON 5/16" ID X 3/4" OD X 1/2" LG.	NYLON	4	
64	60259	BTN SKT HD MACHINE SCREW M5-.8 X 12mm LG	18-8 SS	3	
63	60258	HHCS M6-1.0 X 45mm LG	316 SS	4	
62	60256	HHCS M6-1.0 X 16mm LG	316 SS	4	
61	60255	HEX NUT, NYLOK M6-1.0	316 SS	6	
60	60246	HEX HD CAP SCREW M8-1.25 X 20mm LG. 316SS	316SS	7	
59	60223	FLAT WASHER M6 SCREW SIZE	316 SS	16	
58	60222	HHCS M6-1.0 X 35mm LG FULL THREAD	316 SS	2	
57	60177	PHMS 8-32 X 5/8 LG	18-8 SS	2	
56	60162	FLAT WASHER, #8 SS	316 SS	4	
55	60161	HEX NUT NYLOCK 8-32	18-8 SS	2	
54	60105	SKT HD CAP SCREW, #10-24 X 2.0 LG	ALLOY STEEL	8	
53	60097	INTERNAL TOOTH LOCK WASHER, 1/4"	BRONZE	5	-
52	60087	PAN HD MACHINE SCREW, #8-32 X 3/8 LG	18-8SS	1	
51	60061	PAN HD MACHINE SCREW 10-24 X .50 LG	18-8SS	2	-
50	60038	FLAT WASHER, M4	18-8 SS	2	
49	60037	SPRING LOCK WASHER, M4	18-8 SS	2	
48	60036	BUTTON SKT HD CAP SCREW, M4-.7 X 20MM LG	18-8 SS	2	
47	60034	SKT HD CAP SCREW, M4-.7 X 16 LG. SS	18-8 SS	2	
46	60033	FLAT WASHER #10	316SS	5	
45	60015	SPRING LOCK WASHER, HI-COLLAR, #10	ALLOY STEEL	8	
44	60003	FLAT WASHER, 5/16	316SS	7	
43	40367	GROMMET, PUSH IN 1-1/4 ID X 3/32 PANEL THKNSS.	SBR RUBBER	1	-
42	40366	MOTOR DRIVE COVER LABEL	ANODIZED ALUM.	1	-
41	40271	CLICK BOND CABLE TIE ANCHOR,TRANSVERSE BASE	COMP	2	
40	40250	SILI-THANE 803 MARINE SEALANT	---	AR	
39	30255	RING TERMINAL, 16-14 GA SIZE #8 INSULATED, BLUE	---	1	
38	30254	RING TERMINAL, 12-10 GA SIZE #8 INSULATED,YELLOW	---	1	
37	30249	TERMINATOR, 'CAN' MICRO, 120OHM FEMALE	PLASTIC	1	-
36	30247	AMPHENOL LTW PLASTIC CAP, FEMALE	---	1	-
35	30246	AMPHENOL LTW PLASTIC CAP, MALE	---	1	-
34	30244	T- ADAPTOR, 'CAN', DISPLAY CABLE	---	1	-
33	30243	CABLE, 'CAN', MALE/FEMALE, PLASTIC MICRO, 25M LG.	---	1	-
32	30242	FERRULE 12 AWG, .47" PIN LENGTH	---	3	
31	30241	POWER RELAY	---	1	
30	30240	FERRULE 14 AWG, .47 PIN LENGTH	---	2	
29	30239	MARINE GRADE ELECTRICAL CABLE, 14-3 SEAWATER PUMP	---	10 FT.	-
28	30236	VACUUM SENSOR, SENSATA 100CP8-17	BRASS	1	
27	30235	THERMISTOR, GE WTS 1797	316 SS	2	
26	30234	NG8 ECU WITH ISOLATORS	---	1	
25	30233	DEUTSCH PIN PLUG	PLASTIC	12	-
24	30232	DEUTSCH CONNECTOR BODY	PLASTIC	1	-
23	30230	DISPLAY SUN COVER	---	1	-
22	30229	GYRO CONTROLLER DISPLAY	---	1	-
21	30197	FERRULE 10 AWG, .47" PIN LENGTH	---	2	
20	30179	MARINE GRADE ELECTRICAL CABLE, 10-3 AC POWER	---	10 FT.	-
19	30011	CABLE TIE ANCHOR CLIP	---	2	
18	30003	POSITION MARKER	---	1	
17	20248	GYRO DC INPUT POWER CABLE ASSEMBLY, 5M LG.	---	1	-
15	20228	GROUND CABLE ASSY, 4 AWG, 13" LG.	---	1	-
14	20223	CANvu 355 DISPLAY INTERFACE CABLE	---	1	-
13	20222	GIMBAL ANGLE SENSOR & CONNECTOR ASSEMBLY	---	1	-
12	20220	GROUND CABLE ASSY, 4 AWG, 90" LG.	---	1	-
11	20219	GROUND CABLE ASSY, 4 AWG, 18" LG.	---	1	-
10	20218	NG8 GYRO WIRING HARNESS	---	1	
9	20216	NG8 MOTOR CONTROL DRIVE	---	1	-
8	20210	DISPLAY SUN COVER GRAPHICS	---	1	
7	20209	BRACKET, GYRO DISPLAY MOUNT	5052 ALUM	1	-
6	20208	DISPLAY LABEL	---	1	-
5	20206	NG8 CAN-IMU UNIT	---	1	
4	11023	NG9 ELECTRONICS BASEPLATE	5052 ALUM	1	-
3	11021	WIRE BULKHEAD PLATE	.100 ALUM SHT.	1	-
2	10852	NG8 MOTOR DRIVE BRACKET	5052 ALUM	1	-
1	10832	NG8 GIMBAL ANGLE SENSOR MOUNT MACHINED	CAST ALUM	1	-
ITEM NO.	PART NO.	DESCRIPTION	MATERIAL	QTY	NOTE

PROPRIETARY AND CONFIDENTIAL  
THE INFORMATION CONTAINED IN THIS  
DRAWING IS THE SOLE PROPERTY OF  
SEAKEEPER INCORPORATED. ANY  
REPRODUCTION IN PART OR AS A WHOLE  
WITHOUT THE WRITTEN PERMISSION OF  
SEAKEEPER IS PROHIBITED.

Seakeeper Inc.  
44425 Pecan Court  
Suite 151  
California, MD 20619  
NAME:

SEAKEEPER 9, ELECTRICAL  
SUB-SYSTEM SERVICE REFERENCE

WEIGHT - LBS :

MATERIAL:

DRAWN: SAC

ENG APPR: DATE: 06MAR14

PROD APPR: DATE:

DWG NUMBER

20217-SP

REV. NO. SHEET NO.

2 1 OF 3



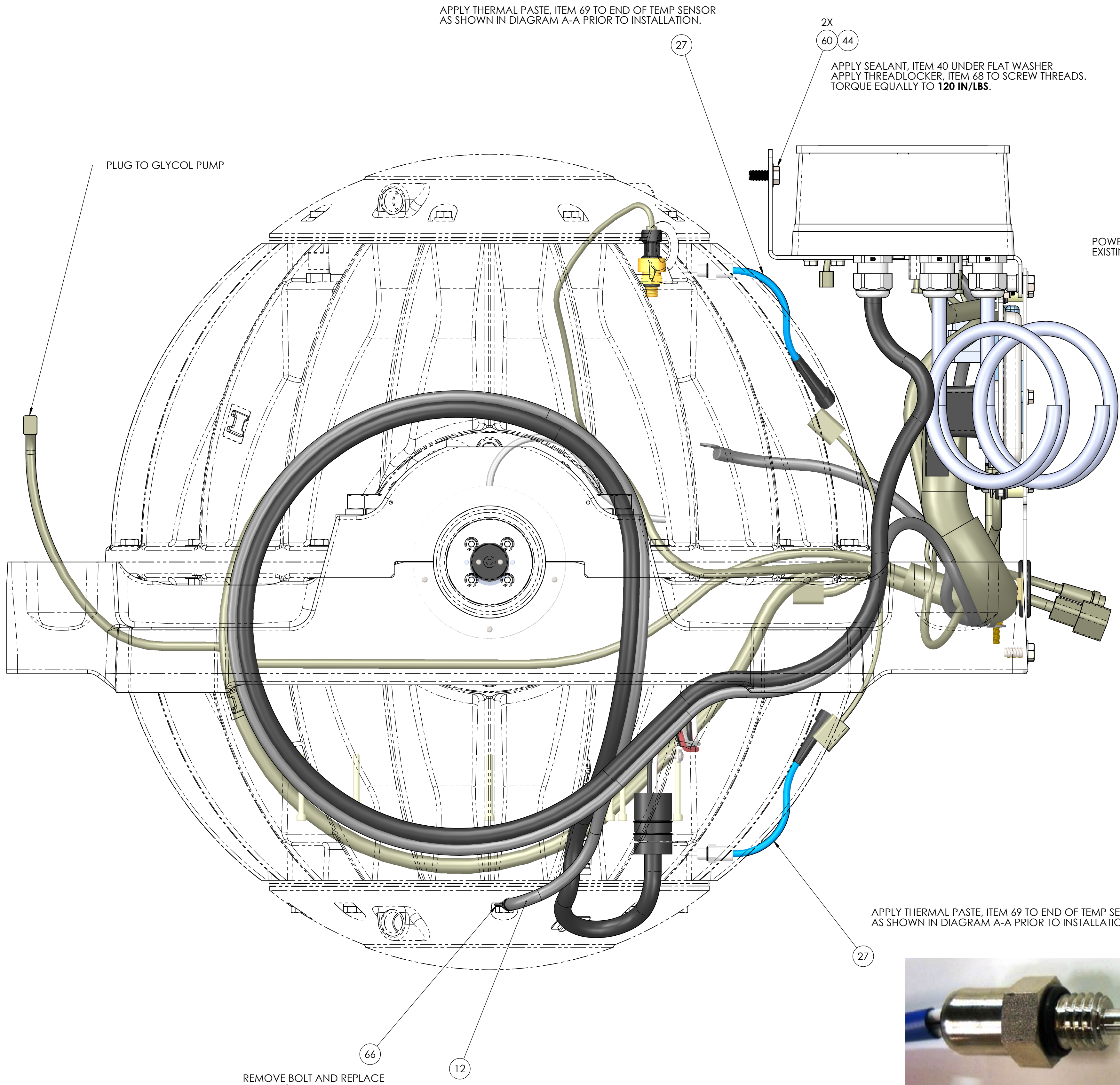
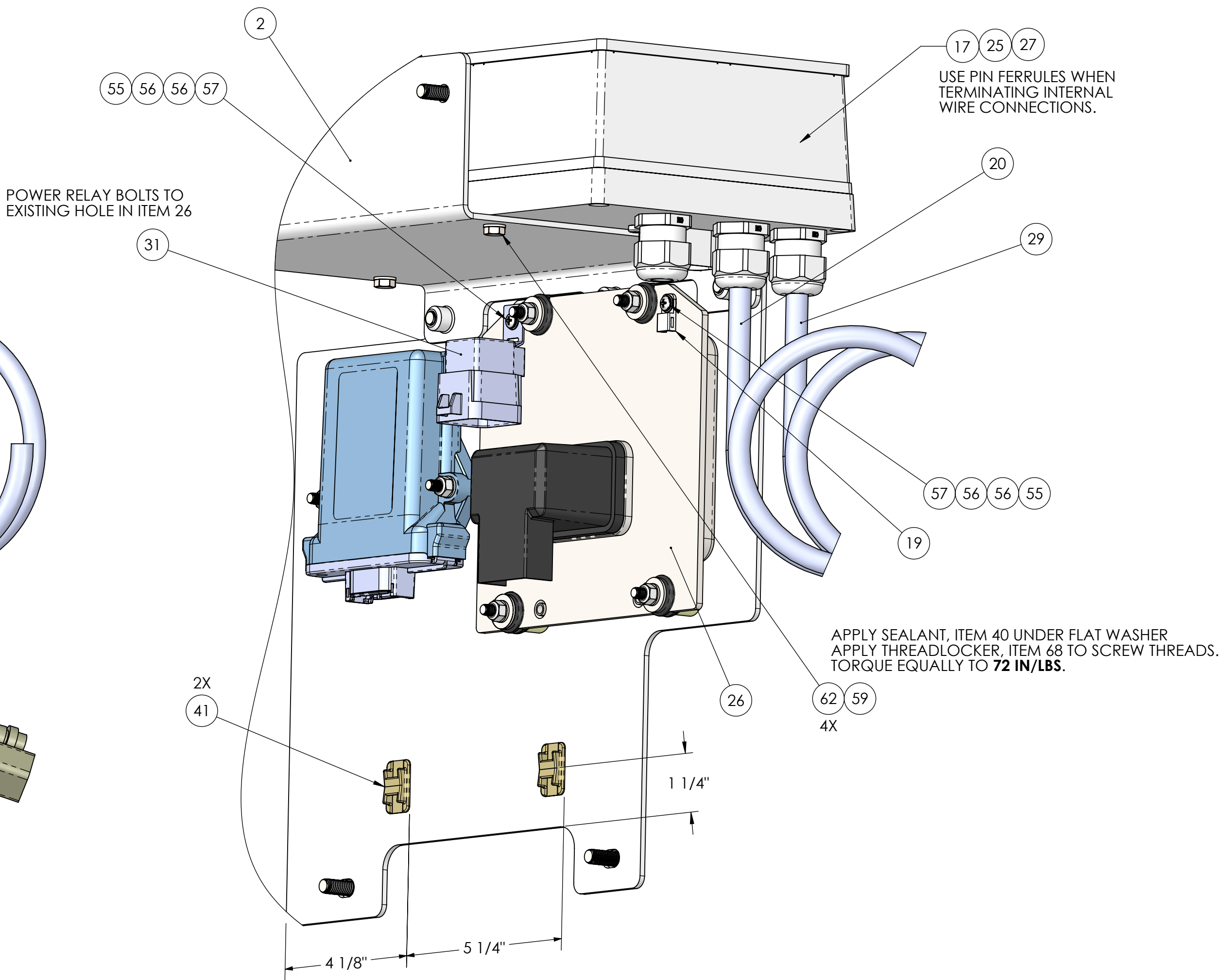
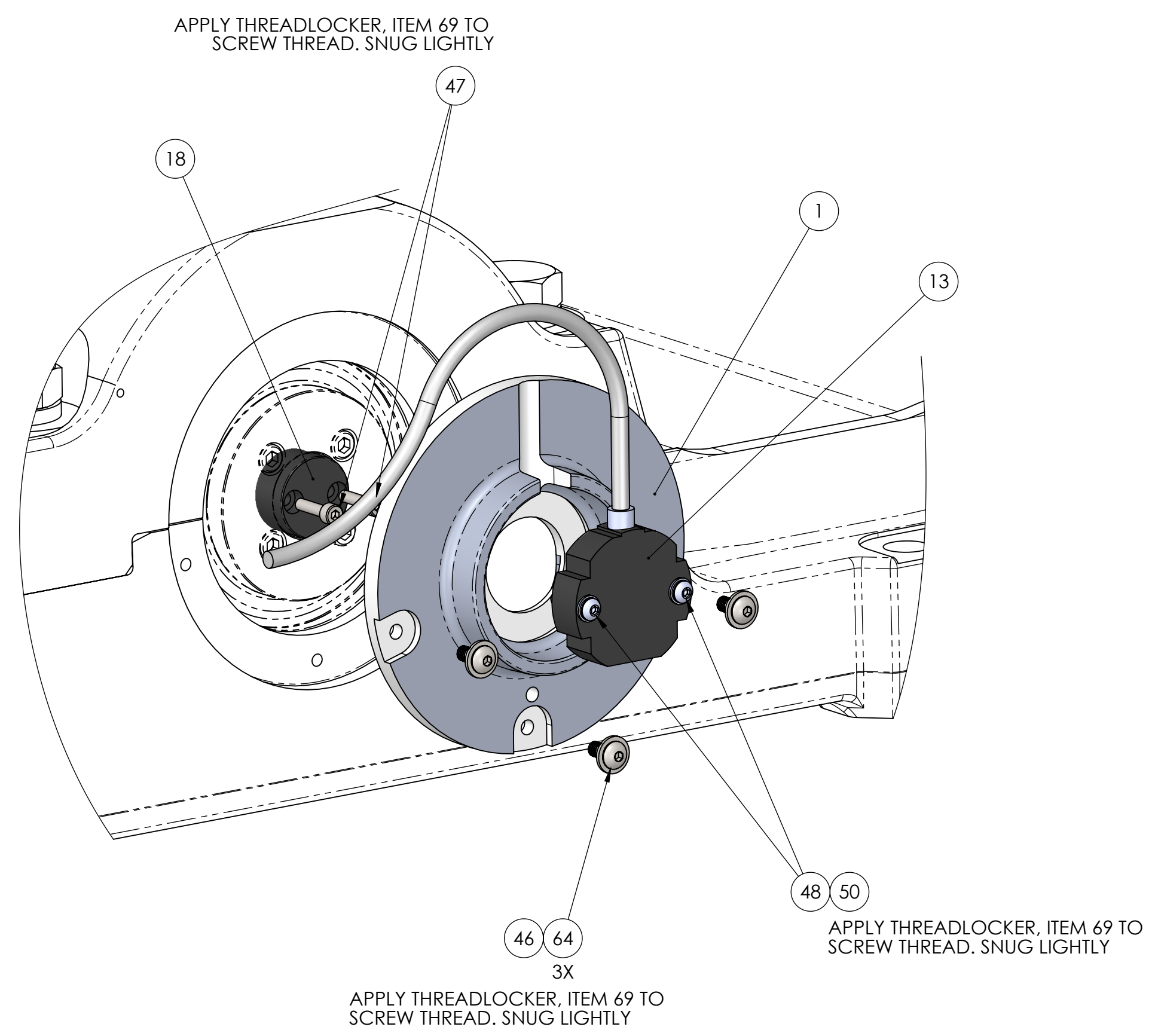
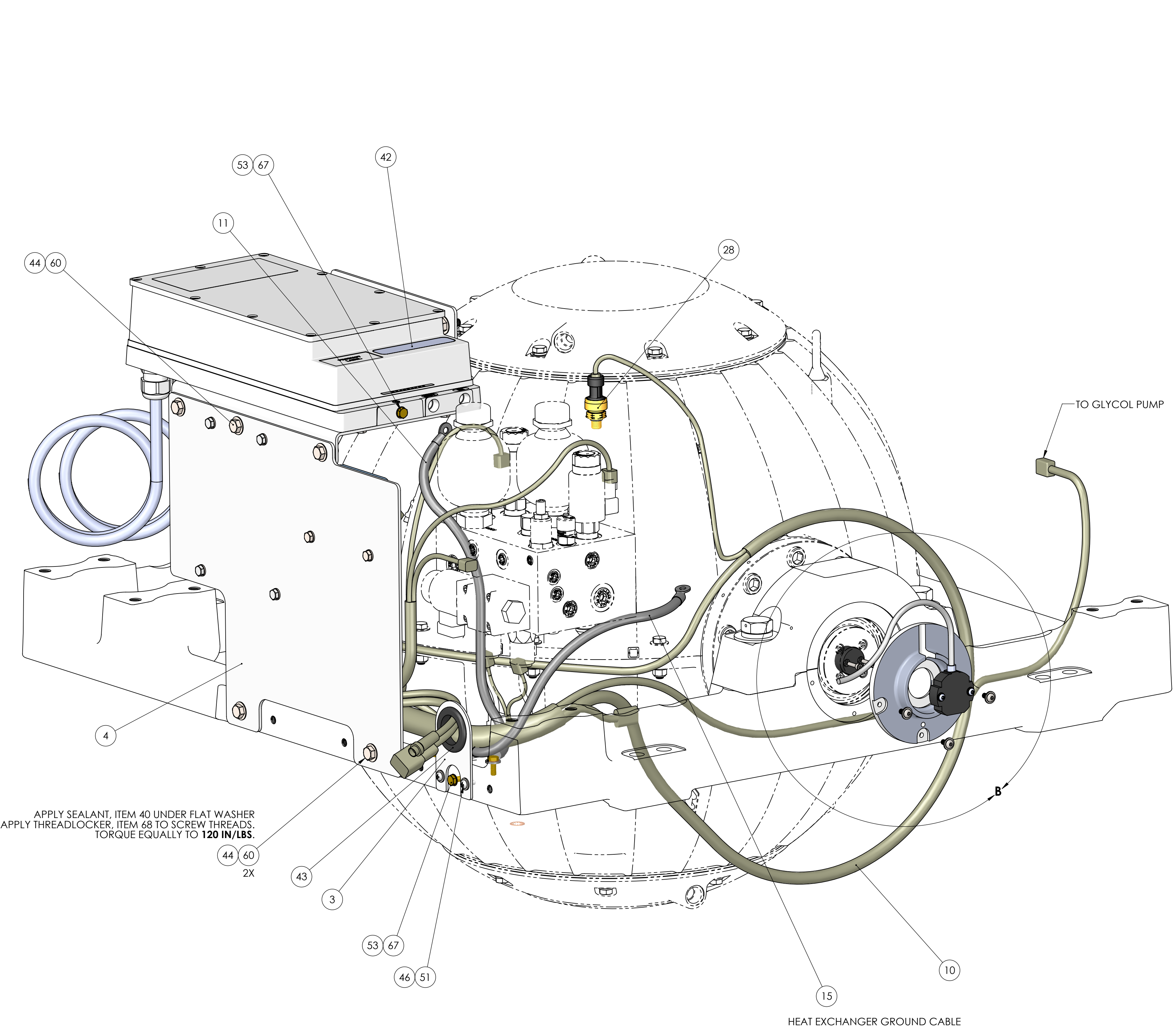

DIAGRAM A-A







DETAIL B  
SCALE 1 : 1.5