

- NOTES:
- 1) THIS DWG. REPRESENTS A SUB-GROUP OF COMPONENTS WITHIN THE NG9 ELECTRONICS SYSTEM BILL OF MATERIAL AND DOES NOT NECESSARILY REPRESENT THE ACTUAL ASSEMBLY PROCEDURE. THIS DWG DOES PROVIDE TECHNICAL INFORMATION REGARDING COMPONENT LOCATION, SUGGESTED WIRE HARNESS ROUTING, AND FASTENER APPLICATION.
- 2) ITEMS SHOWN IN PHANTOM ARE FOR REFERENCE ONLY. THESE REFERENCE ITEMS ARE PART OF OTHER SUB-GROUPS AND ARE DISPLAYED IN THIS DWG TO SHOW WIRE HARNESS CONNECTION POINTS.
- 3) ITEMS 6,7,15,18,23, 24, 25, 26, 34, 35, 36, 37, AND 38 ARE SHOWN FOR BILL OF MATERIAL REFERENCE ONLY. THESE COMPONENTS SHIP WITH THE GYRO SEPARATELY.

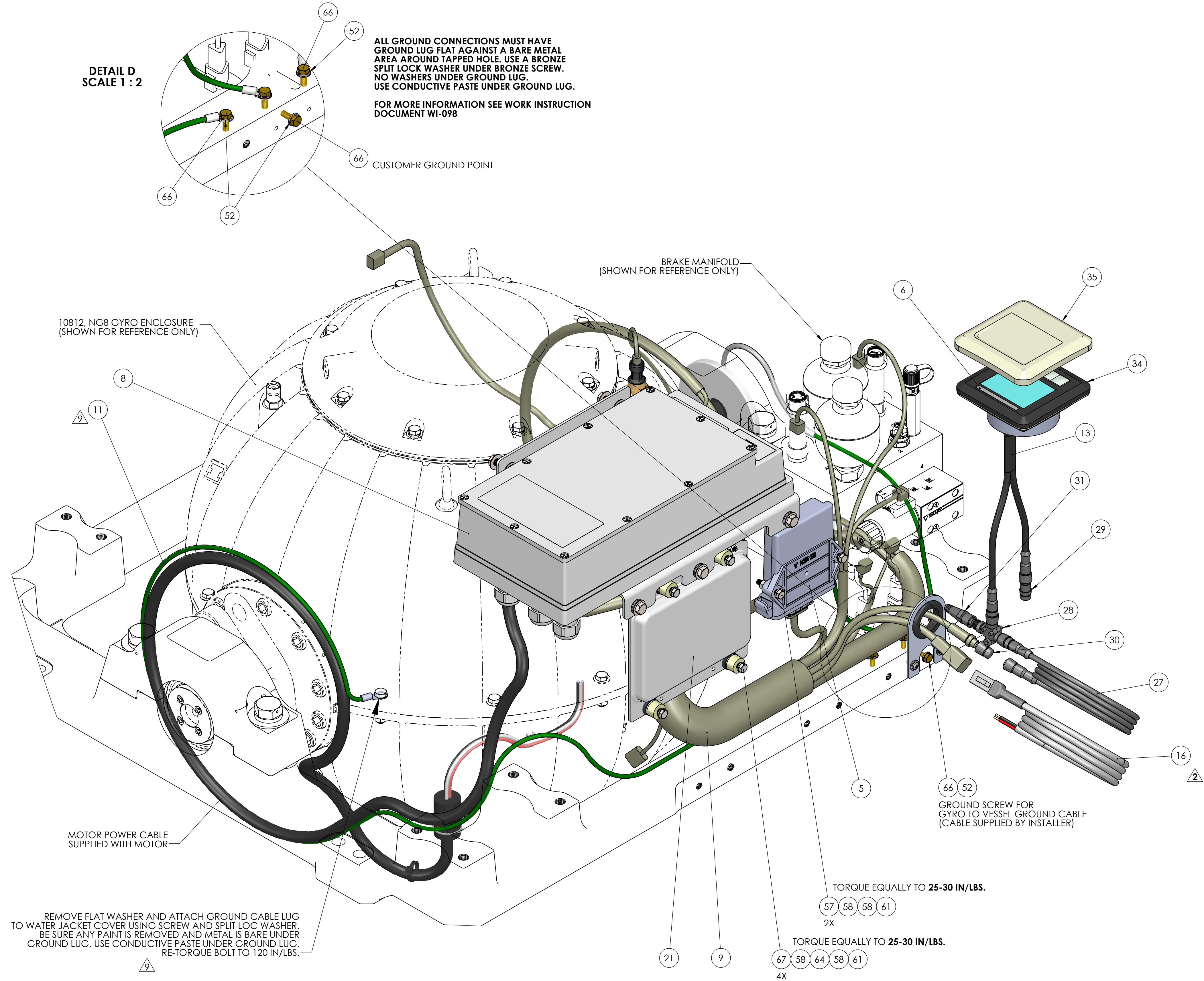

REV.	ECN NO.	ZONE	DESCRIPTION	DATE	APPROVED
1	0174		RELEASED FOR PRODUCTION	3/6/2014	RSK
2	0204		ADDED ITEM 18 TO BILL OF MATERIAL	7/23/2014	RSK
3	0218		UPDATED GYRO CONTROL DISPLAY AND SUNCOVER	2/9/2015	RSK
4	0274		THRU BOLTED MOTOR DRIVE BOX BRACKET TO FRAME CROSSBAR	4/27/2015	RSK
5	0323		SEAKEEPER BRANDING CHANGE ON DISPLAY LABEL AND DRIVE BOX LABEL	5/18/2015	SAC
6	0448		GROUND CABLES CHANGED SIZE FROM 4AWG TO 10AWG, REPLACED ALL SERRATED TOOTH LOCK WASHERS WITH SPLIT LOCK WASHERS UNDER GROUND SCREWS	10/4/2016	SAC
7	0496	B5, SHT 2	O-RINGS AND RETAINER CLIP FOR MOTOR FEEDTHRU ADDED TO BOM LIST, NOW SUPPLIED BY SEAKEEPER	2/3/2017	SAC
8	0479		SENSATA BRAND VACUUM SENSOR REPLACED WITH WASCO BRAND SENSOR	4/11/2017	SAC
9	0477	A8, A6 SHT2	THE SPHERE ENCLOSURE GROUND CABLE 20220 WAS SHORTENED 14" AND NOW TERMINATES AT THE EQUATOR. ADDED PROTECTIVE BRACKET TO LOWER WATER JACKET FOR MOTOR POWER CABLE	4/27/2017	SAC

69	70061	70061	THERMAL JOINT COMPOUND - WAKEFIELD TYPE 120	---	AR	
68	70054	70054	THREAD LOCKER, LOCTITE #243, BLUE	---	AR	
67	60335	316 SS	SCREW, HEX HD CAP M6-1.0 X 40MM FULL TD	4	-	
66	60278	BRASS	HEX HD CAP SCREW, M6-1.0 X 16mm LG, FULL THREAD	5	-	
65	60267	316 SS	HEX NUT, NYLOK M8-1.2 SS	2	-	
64	60260	NYLON	STAND OFF, NYLON, .31X.75X.5	4	-	
63	60259	18-8 SS	BTN SKT HD MACHINE SCREW M5-.8 X 12mm LG	3	-	
62	60256	316 SS	HEX HEAD CAP SCREW, M6-1.0 X 16mm LG	4	-	
61	60255	316 SS	HEX NUT, NYLOK M6-1.0	6	-	
60	60247	316SS	HEX HD CAP SCREW M8-1.25 X 40mm LG 316SS	2	-	
59	60246	316SS	HEX HD CAP SCREW M8-1.25 X 20mm LG, 316SS	5	-	
58	60223	316SS	WASHER, FLAT, M6 12MM OD	16	-	
57	60222	316 SS	HHCS M6-1.0 X 35mm LG FULL THREAD	2	-	
56	60177	18-8 SS	SCREW, PHILLIPS HD PAN 8-32 X 0.63	2	-	
55	60162	316 SS	FLAT WASHER, #8	4	-	
54	60161	18-8 SS	NUT, NYLOCK HEX 8-32	2	-	
53	60105	BLK OXIDE STL	SCREW, SOCKET HD CAP 10-24 X 2.0 GRD8	8	-	
52	60096	SILICON BRONZE	WASHER, SPLIT LOC .25 ID	5	-	
51	60087	18-8 SS	SCREW, PHILLIPS HD PAN 8-32 X 0.38	1	-	
50	60061	18-8SS	PAN HD MACHINE SCREW 10-24 X .50 LG	2	-	
49	60038	18-8 SS	FLAT WASHER, M4	2	-	
48	60037	18-8 SS	SPRING LOCK WASHER, M4	2	-	
47	60036	18-8 SS	BUTTON SKT HD CAP SCREW, M4-.7 X 20MM LG	2	-	
46	60034	18-8SS	SCREW, SOCKET HD CAP M4-.7 X 16MM FULL TD	2	-	
45	60033	316SS	FLAT WASHER #10	5	-	
44	60015	ALLOY STEEL	WASHER, HI COLLAR LOC #10	8	-	
43	60003	316 SS	WASHER, FLAT TYPE B NARROW 0.31	9	-	
42	40367	SBR RUBBER	GROMMET, PUSH IN 1-1/4 ID X 3/32 PANEL THKNSS.	1	-	
41	40366	ANODIZED ALUM.	MOTOR DRIVE COVER LABEL	1	-	
40	40271	COMP	CLICK BOND CABLE TIE ANCHOR, TRANSVERSE BASE	2	-	
39	40250	---	SILI-THANE 803 MARINE SEALANT	AR		
38	40142	VITON	O-RING, SIZE 024 A75 DUROMETER	2	-	
37	40107	SS	RETAINING RING, EXTERNAL, 1.25 DIA	1	-	
36	30288	BRASS	VACUUM SENSOR, WASCO	1	-	
35	30269	---	SEAKEEPER DISPLAY SUNCOVER	1	-	
34	30268	---	SEAKEEPER CONTROLLER DISPLAY	1	-	
33	30255	---	RING TERMINAL, 16-14 GA SIZE #8 INSULATED, BLUE	1	-	
32	30254	---	RING TERMINAL, 12-10 GA SIZE #8 INSULATED, YELLOW	1	-	
31	30249	PLASTIC	TERMINATOR, NMEA 2000 MICRO, 120OHM FEMALE	1	-	
30	30247	---	AMPHENOL LTW PLASTIC CAP, FEMALE	1	-	
29	30246	---	AMPHENOL LTW PLASTIC CAP, MALE	1	-	
28	30244	---	DISPLAY CABLE T- ADAPTOR	1	-	
27	30243	---	CABLE, MALE/FEMALE, NMEA 2000 PLASTIC MICRO, 25M LG.	1	-	
26	30242	---	FERRULE 12 AWG, .47" PIN LENGTH	3	-	
25	30241	---	POWER RELAY	1	-	
24	30240	---	FERRULE 14 AWG, .47 PIN LENGTH	2	-	
23	30239	---	MARINE GRADE ELECTRICAL CABLE, 14-3 SEAWATER PUMP	1	-	
22	30235	316 SS	THERMISTOR, GE WTS 1797	2	-	
21	30234	---	ECU ASSEMBLY INCLUDING ISOLATION BUSHINGS	1	-	
20	30197	---	FERRULE 10 AWG, .47" PIN LENGTH	2	-	
19	30179	---	MARINE GRADE ELECTRICAL CABLE, 10-3 AC POWER	1	-	
18	30011	---	CABLE TIE ANCHOR CLIP	2	-	
17	30003	---	POSITION MARKER	1	-	
16	20248	---	GYRO DC INPUT POWER CABLE ASSEMBLY, 5M LG.	1	-	
15	20232	---	NG9 FLYWHEEL MOTOR ROTOR	1	-	
14	20228	---	GROUND CABLE ASSY, 4 AWG, 13" LG.	1	-	
13	20223	---	CANvu 355 DISPLAY INTERFACE CABLE	1	-	
12	20222	---	GIMBAL ANGLE SENSOR & CONNECTOR ASSEMBLY	1	-	
11	20220	---	GROUND CABLE ASSY, 4 AWG, 75" LG.	1	-	
10	20219	---	GROUND CABLE ASSY, 4 AWG, 18" LG.	1	-	
9	20218	---	SEAKEEPER 9 GYRO WIRING HARNESS	1	-	
8	20216	ALUMINUM	SEAKEEPER MOTOR DRIVE BOX	1	-	
7	20212	---	NG9 FLYWHEEL MOTOR STATOR	1	-	
6	20208	---	DISPLAY LABEL	1	-	
5	20206	---	CAN IMU ASSEMBLY	1	-	
4	11023	5052 ALUM	SEAKEEPER 9 ELECTRONICS BASEPLATE	1	-	
3	11021	.100 ALUM. SHT.	SEAKEEPER 9 WIRE BULKHEAD PLATE	1	-	
2	10852	5052 ALUM	SEAKEEPER 9 MOTOR DRIVE BRACKET	1	-	
1	10832	CAST ALUM	SEAKEEPER 9 GIMBAL ANGLE SENSOR MOUNT FINISH MACHINED	1	-	
ITEM NO.	PART NO.	DESCRIPTION	MATERIAL	QTY	NOTE	

PROPRIETARY AND CONFIDENTIAL

THE INFORMATION CONTAINED IN THIS DRAWING IS THE SOLE PROPERTY OF SEAKEEPER INCORPORATED. ANY REPRODUCTION IN PART OR AS A WHOLE WITHOUT THE WRITTEN PERMISSION OF SEAKEEPER IS PROHIBITED.



Seakeeper Inc. 44425 Pecan Court, Suite 151 California, MD 20619

NAME:

SEAKEEPER 9 ELECTRONIC SUB SYSTEM ASSEMBLY-SERVICE

DWG NUMBER

20217

REV. NO.

9

SHEET NO. 1 OF 3

WEIGHT - LBS:

MATERIAL:

DRAWN:

SAC 06MAR14

ENG APPR:

PROD APPR:

DATE:

DATE:

8 7 6 5 4 3 2 1

F

E

D

C

B

A

SEE DETAIL VIEW D ON SHEET 1
FOR GROUND CABLE TERMINATION
INSTRUCTION.

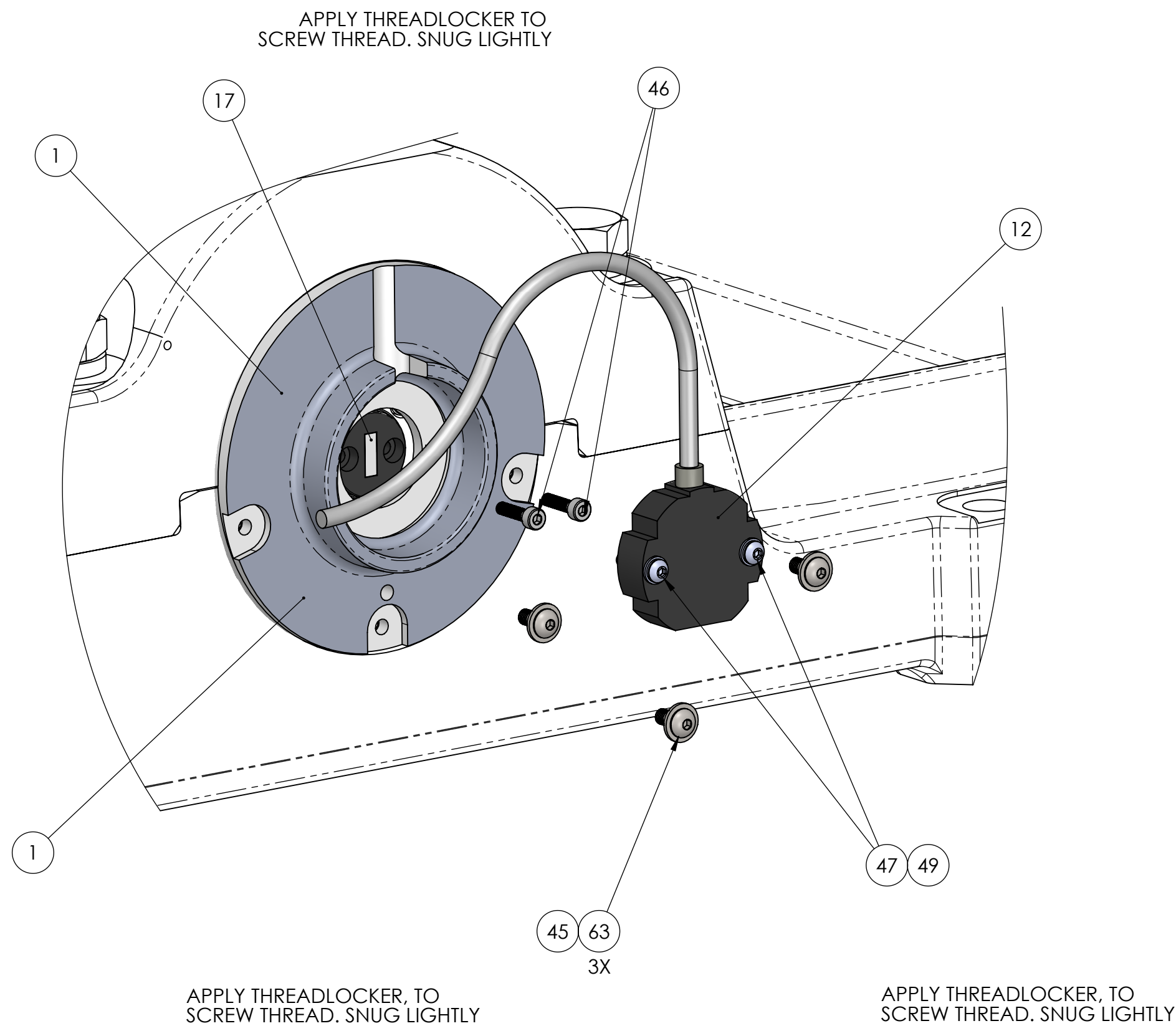
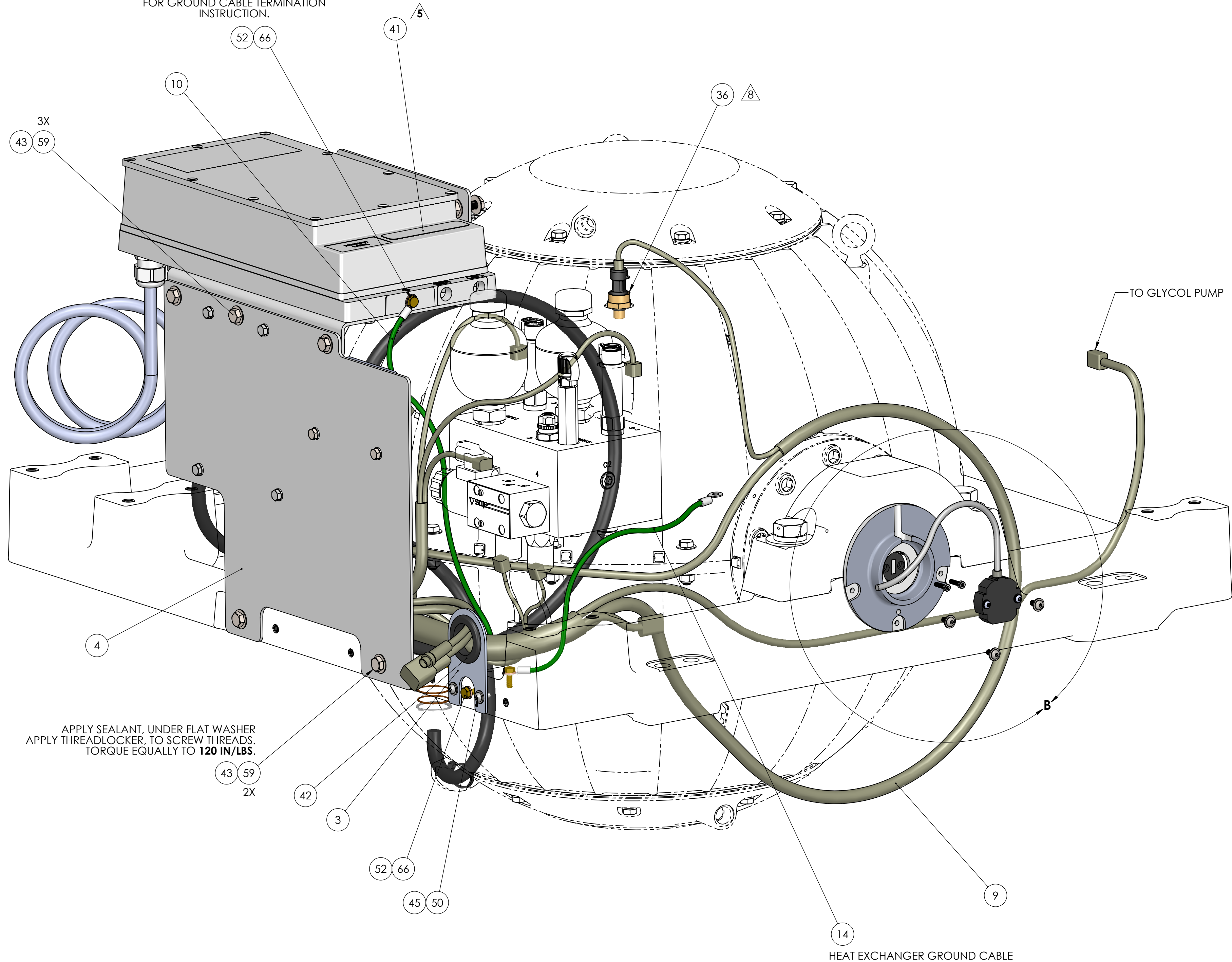

DETAIL B
SCALE 1 : 1.5

PROPRIETARY AND CONFIDENTIAL
THE INFORMATION CONTAINED IN THIS
DRAWING IS THE SOLE PROPERTY OF
SEAKEEPER INCORPORATED. ANY
REPRODUCTION IN PART OR AS A WHOLE
WITHOUT THE WRITTEN PERMISSION OF
SEAKEEPER IS PROHIBITED.

SEAKEEPER
Seakeeper Inc. 44425 Pecan Court, Suite 151 California, MD 20619

SEAKEEPER 9 ELECTRONICS SUB
SYSTEM-SERVICE

20217

REV. NO. | SHEET NO.
9 | 3 OF 3

WEIGHT - LBS.

MATERIAL:

DRAWN: **SAC** DATE: **06MAR14**

ENG APPR. DATE:

PROD APPR. DATE:

DWG NUMBER

REV. NO. | SHEET NO.