

ATTENTION: BEFORE REMOVING SEAKEEPER, USE 90395, SEAKEEPER 6 PACKING LIST, AS A CHECKLIST TO ENSURE ALL NECESSARY ITEMS ARE PRESENT WITHIN THE SHIPPING CRATE. (SOME ITEMS COULD BE PACKED UNDERNEATH THE SEAKEEPER)

REV NO.	ECN NO.	ZONE	DESCRIPTION	DATE	DRAWN	APPRVD.
1	---		INITIAL RELEASE	09SEP2016	WHK	WHK
2	908		RE-DESIGNED ASSY	10NOV2021	ZGY	TMD
3	908		REMOVED CONNECTBOX COMPONENTS.	19AUG2022	RMF	ZGY
4	1059		CONNECTBOX ADDED TO THE SEAKEEPER.	18APR2023	RMF	
5	1194		INCOPORATED CHANGES TO CRATED ASSEMBLY 12615.	24JUL2024	CLF	BRD
6	1194	B4, C3	UPDATED VIEW TO FIX ROD END MATE AND HYDRAULIC MATE	8/7/2024	CLF	BRD

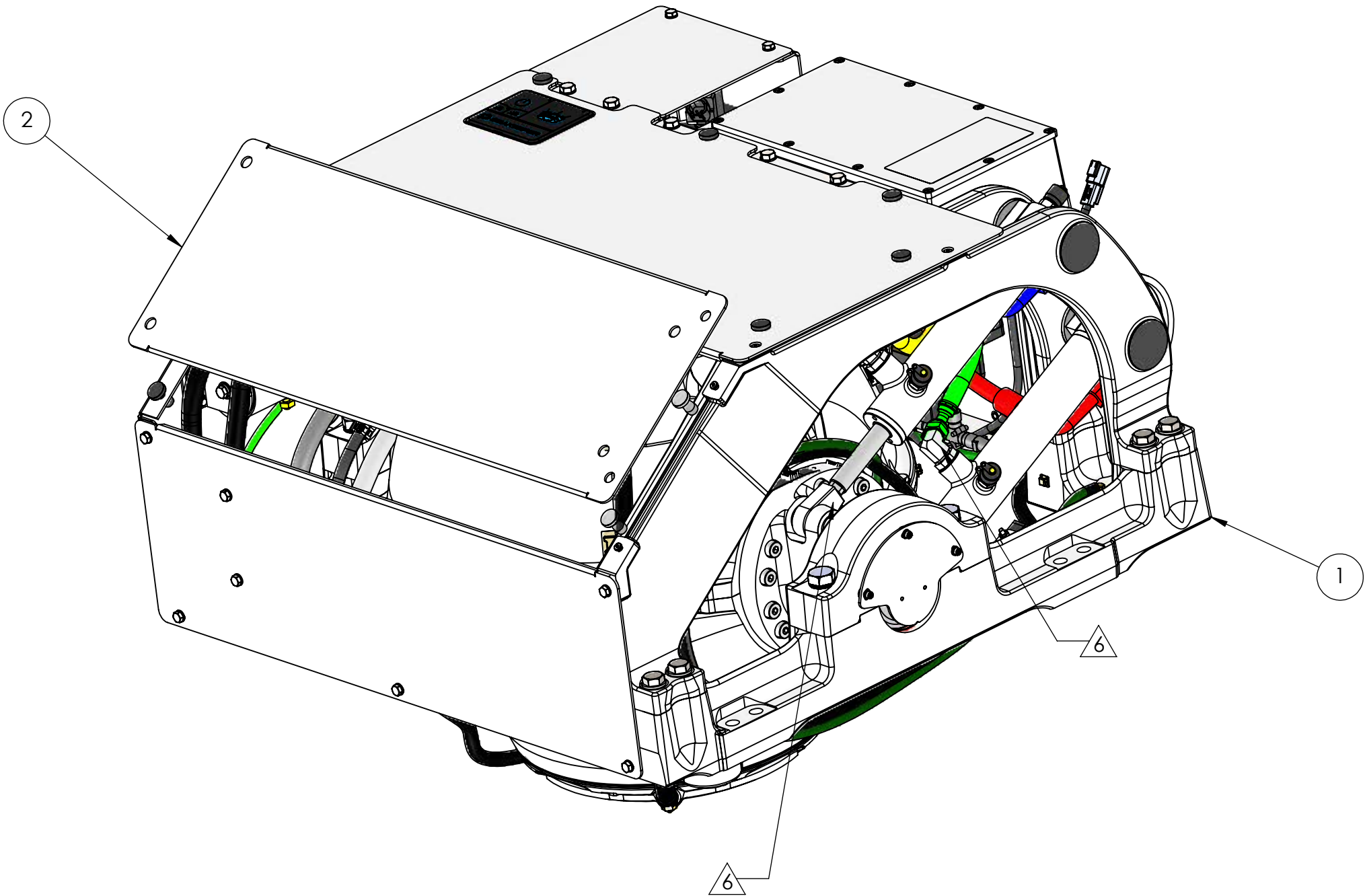

2	12622	SEAKEEPER 6 FACE PANEL	1
1	12615	SEAKEEPER 5/6 CRATED ASSEMBLY	1
ITEM NO.	PART NO.	DESCRIPTION	QTY.

PROPRIETARY AND CONFIDENTIAL
THE INFORMATION CONTAINED IN THIS DRAWING IS THE SOLE PROPERTY OF SEAKEEPER INCORPORATED. ANY REPRODUCTION IN PART OR AS A WHOLE WITHOUT THE WRITTEN PERMISSION OF SEAKEEPER IS PROHIBITED.

THIS DRAWING SUPERSEDES ALL OTHER FILE FORMAT TYPES UNLESS OTHERWISE SPECIFIED
DO NOT SCALE DRAWING

3rd ANGLE PROJECTION

WEIGHT - LBS :
870 LBS

MATERIAL:

SEAKEEPER
Seakeeper Inc., 45310 Abell House Lane, Suite 350 California, MD 20619

DESCRIPTION:
SEAKEEPER 6 HARDWARE SCOPE OF SUPPLY

DRAWING NO:	REV NO:	SCALE:	SHEET NO:
90389	6	1:5	1 OF 1